

Harry Kim
Mayor

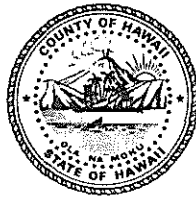

Christopher J. Yuen
Director

Roy R. Takemoto
Deputy Director

County of Hawaii

PLANNING DEPARTMENT

25 Aupuni Street, Room 109 • Hilo, Hawaii 96720-4252
(808) 961-8288 • Fax (808) 961-8742

April 11, 2002

Mr. Henry N. Wyckoff
Ms. Karen A. Thom
1175 Excelsior Avenue
Oakland, CA 94610

Dear Mr. Wyckoff & Ms. Thom:

Additional Farm Dwelling Agreement

Applicants: Henry N. Wyckoff and Karen A. Thom
Land Owner: Henry N. Wyckoff and Karen A. Thom
Tax Map Key: (3) 2-9-004:087

Pursuant to authority conferred to the Planning Director by Chapter 25, Article 5, Division 7, Section 25-5-77 of the Zoning Code and Planning Department Rule 13, Farm Dwellings, we have reviewed your request for an additional farm dwelling on the subject property. Your submittals included the following information:

1. A notarized affidavit that the additional dwelling shall be used for farm-related purposes in the form of the enclosed Additional Farm Dwelling Agreement to be submitted for recordation with the Bureau of Conveyances.
2. Name and address of the landowner(s) or lessee(s), if the latter has a lease on the building site with a term exceeding one year from the date of the farm dwelling agreement.
3. Written authorization of the landowner(s) if the lessee filed the request.

Exhibit A

Mr. Henry N. Wyckoff
Ms. Karen A. Thom
Page 2
April 11, 2002

4. A farm plan or evidence of the applicant's continual agricultural productivity or farming operation within the County, including an explanation of why this additional farm dwelling is needed in connection with the agricultural productivity or farming operation. Your farm plan included the following ongoing and proposed income producing agricultural activities:
 - (a) No ongoing agricultural activities were identified in your written description.
 - (b) Proposed agricultural activities include the following:
 - i. Planting of approximately 6 acres in a variety of fruit trees, including lychee, longon, tabotingana, and lemons;
 - ii. The construction of four (4) 30'x100' greenhouses in four increments to grow vanillin, and catnip;
 - iii. The planting of approximately 2 acres in saffron; and
 - iv. The planting of approximately 2 acres in gourds.
5. In support, evidence of a State of Hawaii Department of Taxation's General Excise (GE) Tax License has also been presented.

Findings:

1. In Chapter 205, Hawaii Revised Statutes (HRS), the State Land Use (SLU) Law does not authorize residential dwellings as a permitted use in the State Land Use Agricultural district unless the dwelling is related to an agricultural activity or is a farm dwelling. A **farm dwelling** as defined in Section 205-4.5, Chapter 205, HRS, **means a single family dwelling located on and used in connection with a farm,** including clusters of single family farm dwellings permitted within agricultural parks developed by the State, **or where agricultural activity provides income to the family occupying the dwelling.** (emphasis added)

Mr. Henry N. Wyckoff
Ms. Karen A. Thom
Page 3
April 11, 2002

2. The subject lot was created by subdivision (SUB 6931) approved on February 6, 1998, which, pursuant to HRS §205-4.5(b), requires that the first dwelling on the lot meet the SLU requirements for a farm dwelling.
3. The Farm Plan, GE Tax License (ID number 30124929), and the agreement to use the dwelling for agricultural or farm-related activity on the building site demonstrate that there will be income producing agricultural activity and the income will be taxed.
4. In addition, the following agencies have submitted their comments as stated below:
 - (a) Department of Water Supply (Letter dated March 7, 2002):

“We have reviewed the subject application and have the following information.

The property does not have an existing water service with the Department. Water is currently available for the first farm dwelling from an existing service lateral for a 5/8-inch meter fronting the parcel on Chin Chuck Road. Inasmuch as this application is proposing an additional detached dwelling, the installation of a separate 5/8-inch meter by the applicant would normally be required in accordance with Department regulations. However, the Department’s existing water system facilities cannot support an additional meter for the proposed additional farm dwelling at this time. Extensive improvements and additions, including source, storage, transmission and distribution facilities, must be constructed. Currently, sufficient funding is not available and not time schedule is set.

Therefore, the Department has no objections to the proposed application subject to the applicant understanding and accepting that the Department cannot provide water service to the proposed additional farm dwelling. Further, should the application be approved, both dwellings must not share the single meter for the parcel.

For the applicant’s information, the following conditions are for the first service:

1. Installation of a backflow preventer (reduced pressure type) by a licensed contractor on the applicant’s property just after the meter. The installation and assembly of the backflow preventer must be inspected and approved by the Department before the water meter can be installed. The backflow preventer

Mr. Henry N. Wyckoff
Ms. Karen A. Thom
Page 4
April 11, 2002

shall be operated and maintained by the customer. A copy of our backflow preventer handout is being forwarded to the applicant to help them understand this requirement.

2. Remittance of the following charges, which are subject to change, to our Customer Service Section:

a. Drop-in Meter Fee	\$75.00
b. Temporary Deposit (If applicant currently has no credit history with the Department)	<u>50.00</u>
Total (Subject to Change)	\$125.00

Should there be any questions, please call our Water Resources and Planning Branch at 961-8070.”

(b) Real Property Tax Office

No comments were submitted.

(c) Department of Health (Memorandum dated March 4, 2002):

“The subject lot(s) are located in a Non-Critical Wastewater Disposal Area where cesspools are allowed under the current rules. More than one cesspool is allowed provided 10,000 sq. ft. per cesspool is available. Each cesspool can dispose of 1,000 gallons per day of wastewater.”

Decision:

In view of the above, your request to construct a second farm dwelling is approved subject to the following conditions:

1. The additional farm dwelling shall only be used to provide shelter for persons involved in the agricultural or farm-related activity on the building site. Family members who are not engaged in agricultural or farm-related activities are allowed to reside in the farm dwelling.

Mr. Henry N. Wyckoff
Ms. Karen A. Thom
Page 5
April 11, 2002

2. The agreement shall run with the land and apply to all persons who may, now or in the future, use or occupy the additional farm dwelling. The enclosed Additional Farm Dwelling Agreement must be returned to the Planning Department with the appropriate notarized signatures along with a check made out to the Bureau of Conveyances in the amount of \$25.00 in accordance with the enclosed Additional Farm Dwelling Agreement Instructions. The Planning Department will not approve a building permit application for the additional dwelling until the AFDA document and all required attachments have been accepted for recordation.
3. All other applicable rules, regulations, and requirements of the Planning Department (including but not limited to the Zoning Code, Chapter 25, Department of Public Works, Department of Water Supply, Fire Department and State Department of Health and other reviewing agencies/divisions listed on the Building Permit Application.
4. Your Additional Farm Dwelling Agreement has been approved based entirely on proposed agricultural activity as summarized previously in this letter. It is required that the First Party (owners and lessees) to the Agreement shall have implemented at least 75% of the proposed farm plan within three (3) years of approval of the building permit for the additional farm dwelling. The Second Party (County of Hawaii Planning Department) of the Agreement may allow time extensions and modifications for good cause shown by First Party.
5. The First Party shall allow the Second Party or its representative to inspect the farm upon reasonable prior notice.
6. This Additional Farm Dwelling Agreement shall be valid for a period of two (2) years from the date of this approval letter to secure a building permit for the additional farm dwelling. Failure to secure a building permit for this additional farm dwelling on or before April 11, 2004 may cause the Director to initiate proceedings to invalidate the AFDA.

In reference to the Department of Water Supply's comment, we suggest the following:

1. Any dwelling not serviced by a County water system should be provided with and maintain a private potable rain-water catchment system with a minimum capacity of 6,000 gallons for domestic consumption or potable uses. This catchment system should

Mr. Henry N. Wyckoff
Ms. Karen A. Thom
Page 6
April 11, 2002

adhere to the Department of Public Works, Building Division's "Guidelines for Owners of Rain Catchment Water Systems" as well as the State Department of Health requirements related to water testing and water purifying devices.

2. Any farm dwelling should be provided with and maintain a private water supply system with an additional minimum storage capacity of 3,000 gallons for fire fighting and other emergency purposes. The emergency water supply system, including the necessary compatible connection devices and the location of the water storage unit on the property, should meet with the approval of the Hawaii County Fire Department.

Should you have questions or require further information, please feel free to contact Larry Brown of my staff at 961-8288.

Sincerely,



CHRISTOPHER J. YUEN
Planning Director

LMB:pak

P:\WPWIN60\Larry\FDA\Wyckoff&Thom 2-9-4-87 apvl.doc

Enclosure: AFDA document
AFDA document instruction sheet

xc: Mr. Milton Pavao, DWS
Mr. Mike McCall, RPT



R-729 STATE OF HAWAII
BUREAU OF CONVEYANCES
RECORDED
MAY 10, 2002 08:02 AM
Doc No(s) 2002-082884



/s/ CARL T. WATANABE
ACTING
REGISTRAR OF CONVEYANCES

12 1/1 Z4

AFTER RECORDATION, RETURN BY MAIL TO:

County of Hawaii Planning Department
25 Aupuni Street, Room 109
Hilo, Hawaii 96720

TITLE OF DOCUMENT:

ADDITIONAL FARM DWELLING AGREEMENT

PARTIES TO DOCUMENT:

FIRST PARTY: HENRY N. WYCKOFF and KAREN A. THOM

SECOND PARTY: COUNTY OF HAWAII

PROPERTY DESCRIPTION:

TMK: (3) 2-9-004:087

ADDITIONAL FARM DWELLING AGREEMENT

THIS AGREEMENT made and executed this 10th day of April, 2002, by and between HENRY N. WYCKOFF and KAREN A. THOM., herein called the "First Party," whose mailing address is 1175 Excelsior Avenue, Oakland, CA 94610, and the COUNTY OF HAWAII, herein called the "Second Party."

IT IS HEREBY AGREED that the First Party may construct an additional farm dwelling located on the property described by Tax Map Key (3) 2-9-004:087 situated within the State Land Use Agricultural district and zoned Agricultural (A-10a) by the Second Party.

IT IS HEREBY ACKNOWLEDGED that the First Party is the legal owner of the property above described.

IT IS HEREBY FURTHER AGREED that this approval to construct an additional farm dwelling is given subject to the following conditions:

1. The additional farm dwelling shall be used to provide shelter to person(s) involved in the agricultural or farm-related activity on the property. Family members who are not engaged in agricultural or farm-related activity are allowed to reside in the farm dwelling.
2. The agreement shall run with the land and apply to all persons who may now or in the future use or occupy the additional farm dwelling.
3. This agreement shall include any and all conditions specified in the Additional Farm Dwelling Agreement letter, attached to this document as Exhibit "A".

IT IS HEREBY FURTHER AGREED that if this agreement is with a lessee, the legal owner shall be a party to this agreement.

IT IS HEREBY FURTHER AGREED that should the pertinent provisions of the State and County laws and rules and regulations change to authorize said farm dwelling, upon request of the First Party, this Agreement may be reconsidered for possible amendment and/or severance.

IT IS HEREBY FURTHER AGREED that if the property is situated within the State Land Use Agricultural district, the Second Party may impose a fine of not more than \$5,000 for violation of Section 205-4.5, Hawaii Revised Statutes. If the violation is not corrected within six months of such citation and the violation continues, a citation for a new and separate violation may be imposed. There shall be a fine of not more than \$5,000 for any additional violation. The Second Party may also impose fines for any violation of Chapter 25, Hawaii County Code, as amended, in accordance with the procedures and fine schedule outlined in Division 3, Article 2, of said code.

IN CONSIDERATION OF THE AFORESAID, the Second Party hereby approves this Agreement as being in conformity with Sections 205-2 and 205-4.5 of the Hawaii Revised Statutes, relative to permitted uses within the State Land Use Agricultural district. This Agreement is also in conformance with Chapter 25, Hawaii County Code, as amended.

IN WITNESS WHEREOF, the parties have executed this agreement on the day and year first above written.

FIRST PARTY:

Henry N. Wyckoff Legal Owner

Karen A. Thom Legal Owner

SECOND PARTY:

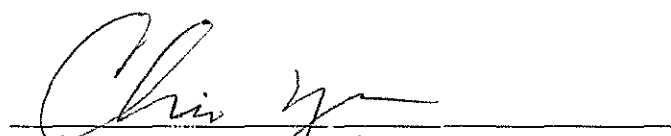

Christopher J. Yuen, Planning Director
County of Hawaii Planning Department

STATE OF California)
) SS.
COUNTY OF Alameda)

On this 18th day of APRIL, 2002 before me personally appeared HENRY N. WYCKOFF and KAREN A. THOM to me known to be the person described in and who executed the foregoing instrument, and acknowledged that they executed the same as their free act and deed.

Notary Public, State of California

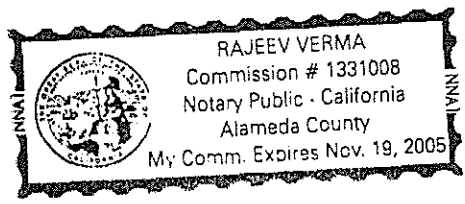
[Handwritten Signature]
My commission expires: Nov 19 / 2005



[Faint handwritten text at the bottom right corner]

STATE OF HAWAII)
) SS
COUNTY OF HAWAII)

On this 29th day of April, 2002 before me personally appeared Christopher J. Yuen, to me personally known, who, being by me duly sworn, did say that he is the Planning Director of the County of Hawaii; and that the Planning Department of the County of Hawaii has no corporate seal; and that the instrument was signed on behalf of the Planning Department of the County of Hawaii, a government agency, and said Christopher J. Yuen acknowledged the instrument to be the free act and deed of said Planning Department, County of Hawaii.

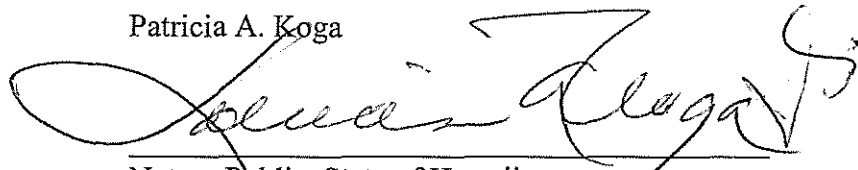
Patricia A. Koga

Notary Public, State of Hawaii

My commission expires: 7/17/02

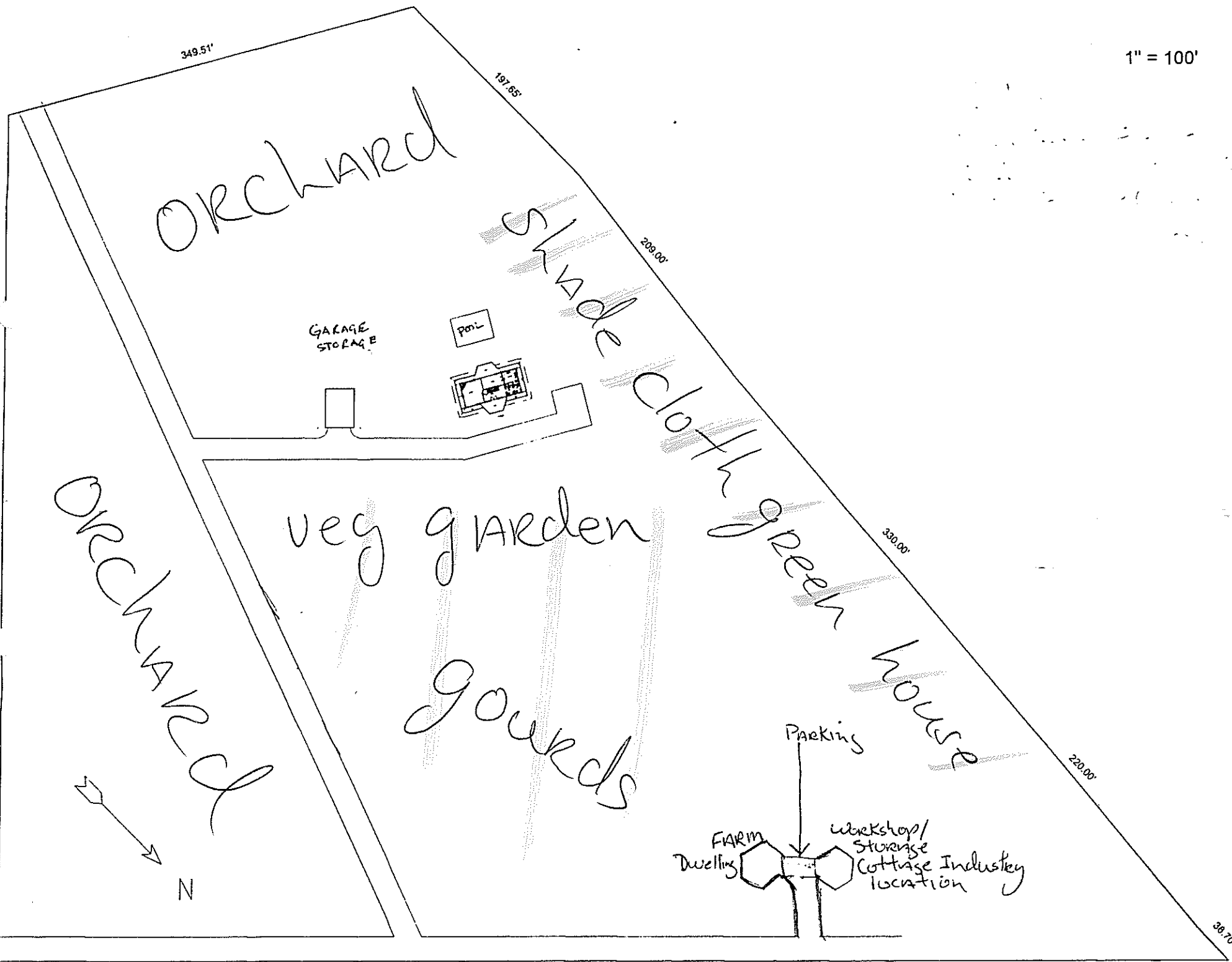
1" = 100'



ORCHARD

GARAGE STORAGE

Pool

Shade cloth

ORCHARD

veg garden

Gourds

green house

Parking

FARM Dwelling workshop/Storage Cottage Industry location

N