

NOMINATOR Name: Arborist Advisory Committee Date Submitted: July 1987
Mailing Address: _____ Bus. Phone: _____
_____ Res. Phone: _____

NOMINEE INFORMATION

1. NAME OF TREE(s)

Common (English or Hawaiian): _____

Scientific: Caesalpinia , Coriaria

2. LOCATION OF TREE(s) (Be specific—include tax map key; state proximity to prominent landmarks): Across from old Police Station on Kalakaua St. Tree is in Kalakaua Park.

3. DESCRIBE THE TREE; ATTACH PHOTOGRAPHS, if possible

The nicely shaped tree with fine feather like leaves. Member of Senna family.

4. PROPERTY OWNER Name: County Parks Dept.

Address: _____ Bus. Phone: _____

_____ Res. Phone: _____

5. CRITERIA FOR BEING EXCEPTIONAL

a. Significant Age _____

b. Significant Size - Height 38 ft.; Crown Spread (diameter) 64 ft.;
Circumference of trunk 4-1/2 ft. from ground 36 in. diameter.

c. Significant historical interest Bill Bryan, State Forester from 1921-1961, obtained the seeds on one of his many trips to foreign countries.

d. Significant cultural background _____

e. Significant rarity Tree is believed to be the only one of this species growing in Hawaii.

f. Significant location _____

g. Significant aesthetic equality _____

h. Endemic status _____

i. Indigenous status _____

j. Healthy condition Good.

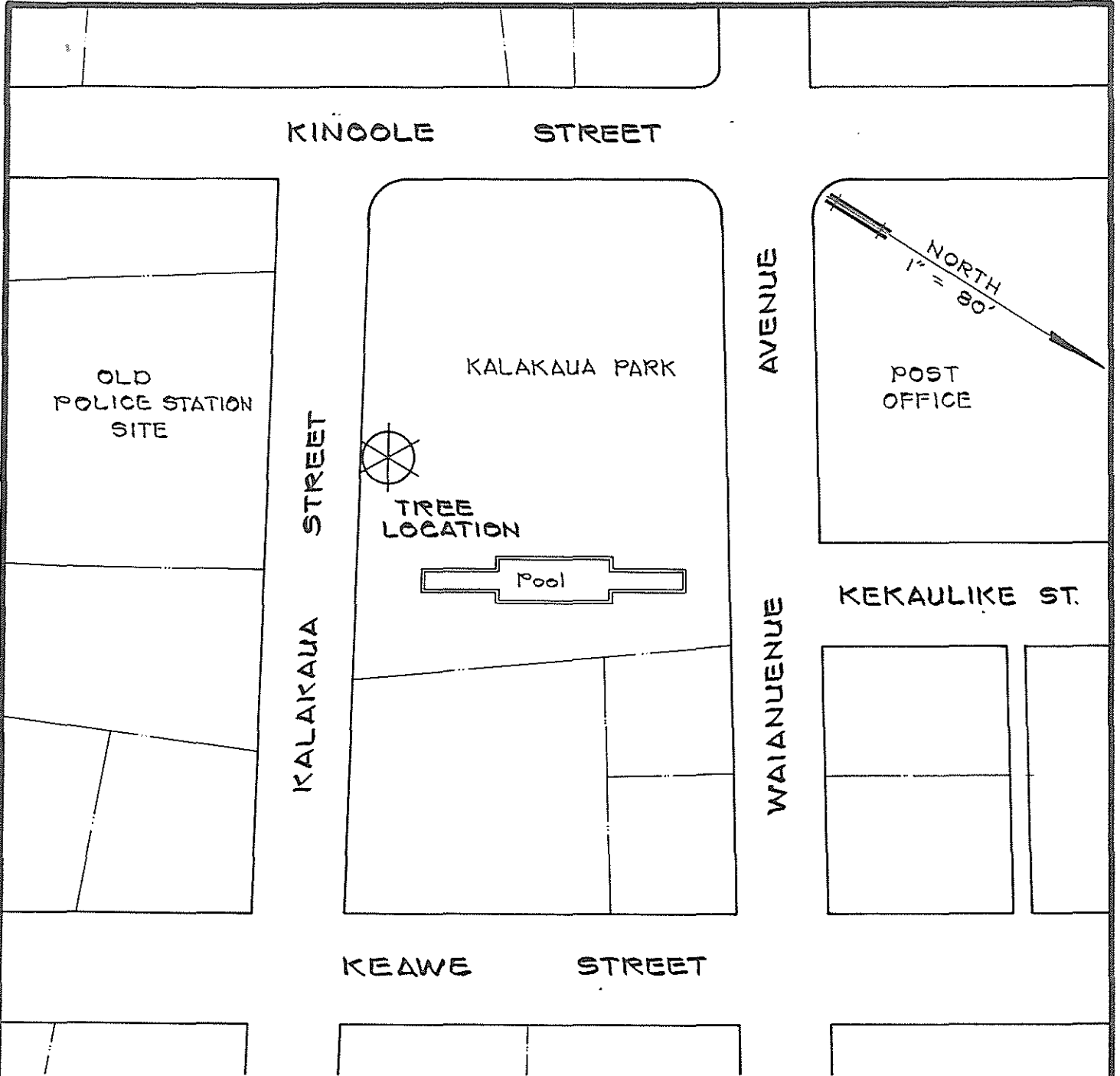

EXCEPTIONAL TREES • LOCATION MAP

CAESALPINIA CORIANA

TAX MAP KEY : 2-3-05 : 1

PIIHONUA, SOUTH HILO, HAWAII

OWNER : COUNTY OF HAWAII

