

BILL NO. 500

COUNTY OF HAWAII - STATE OF HAWAII

ORDINANCE NO. 129

AN ORDINANCE TO AMEND PORTION OF THE GENERAL PLAN OF HILO BY CHANGING THE LAND USE DESIGNATION FOR A CERTAIN AREA OF LAND FROM RESIDENTIAL-AGRICULTURAL USE TO SINGLE FAMILY RESIDENTIAL USE AT WAIAKEA HOMESTEADS.

BE IT ORDAINED BY THE BOARD OF SUPERVISORS OF THE COUNTY OF HAWAII:

SECTION 1. A portion of the General Plan of Hilo as formulated in the "Plan for the Metropolitan Area of Hilo" is hereby amended by changing the land use designation of a certain area of land situated at Waiakea Homesteads, South Hilo, Hawaii, from residential-agricultural use to single-family residential use. The boundaries and area of the said single family residential use are outlined in red on the map attached hereto, marked "Exhibit A," and by reference made a part hereof.

SECTION 2. Ordinance No. 122 is hereby repealed.

SECTION 3. This Ordinance shall take effect upon its approval.

INTRODUCED BY:

Josephines L. Yodanis

Supervisor, County of Hawaii

Hilo, Hawaii

Date of Introduction: ~~May 15, 1968~~ ^{crk}

Date of Adoption: ^{COPIES OF COPY} June 5, 1968

RECEIVED

Ord. No. 129

File No. _____

M. B. No. 251

Date: MAY 15 1968

JUN 5 1968

ORDINANCE NO. 129

(Bill No. 500 - 1968)

AN ORDINANCE TO AMEND PORTION OF THE GENERAL PLAN OF HILO BY CHANGING THE LAND USE DESIGNATION FOR A CERTAIN AREA OF LAND FROM RESIDENTIAL-AGRICULTURAL USE TO SINGLE FAMILY RESIDENTIAL USE AT WAIAKEA HOMESTEADS.

This Bill changes the land use designation of a certain area of land situated near the southwest corner of Komohana and Puainako Street intersection in Waiakea Homesteads from Residential-Agricultural Use to Single Family Residential Use and repeals Ordinance No. 122.

Date Introduced: May 15, 1968 - Date Approved:
June 5, 1968 - Date Effective: June 5, 1968.

Copies of the foregoing Ordinance, in full, are on file in the Office of the County Clerk for use and examination by the public.

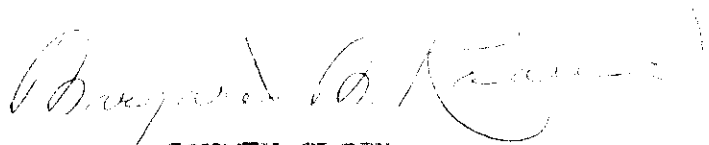

COUNTY CLERK
COUNTY OF HAWAII

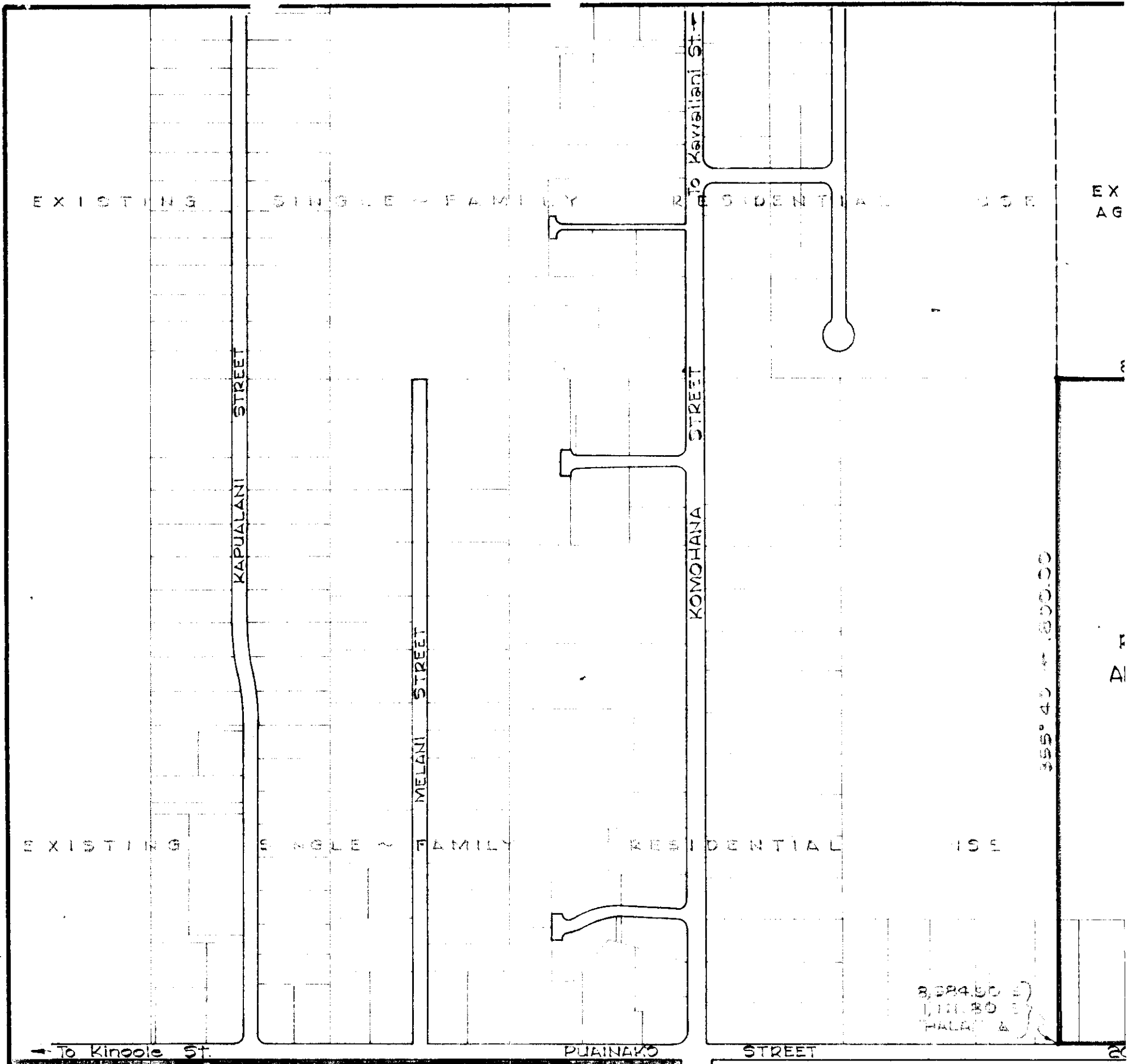

EX
AG

AI



PROPOSED SADDLE ROAD REALIGNMENT

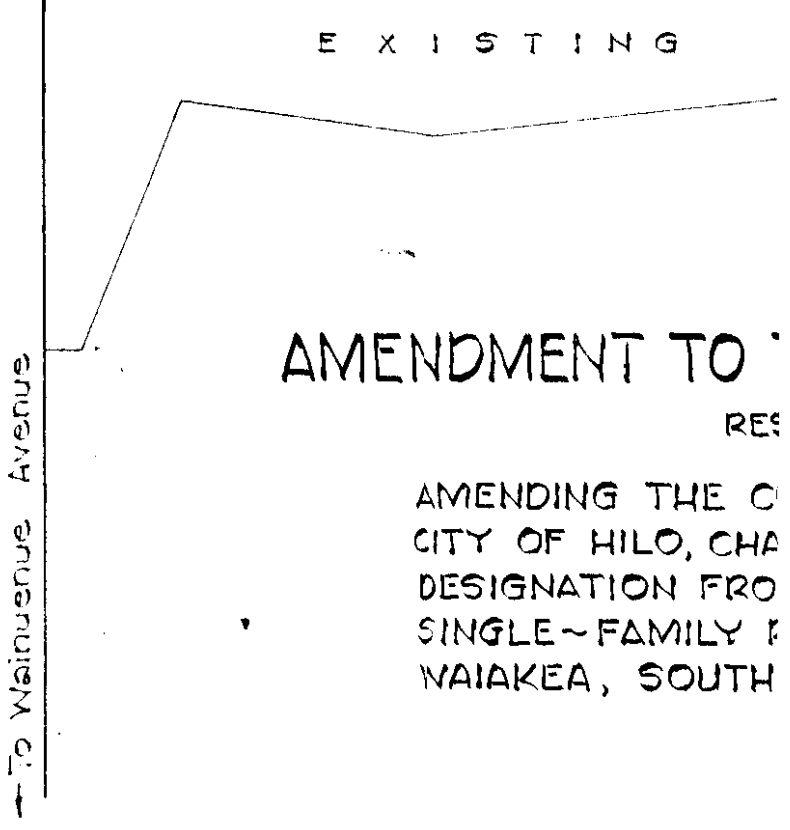
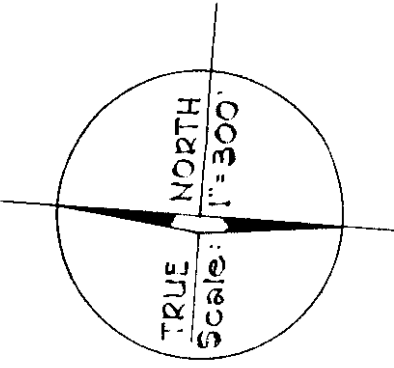

AMENDMENT TO

RES
AMENDING THE C
CITY OF HILO, CHA
DESIGNATION FRO
SINGLE-FAMILY P
WAIAKEA, SOUTH

TAX MAP KEY: 2-4-22
EXHIBIT "A"

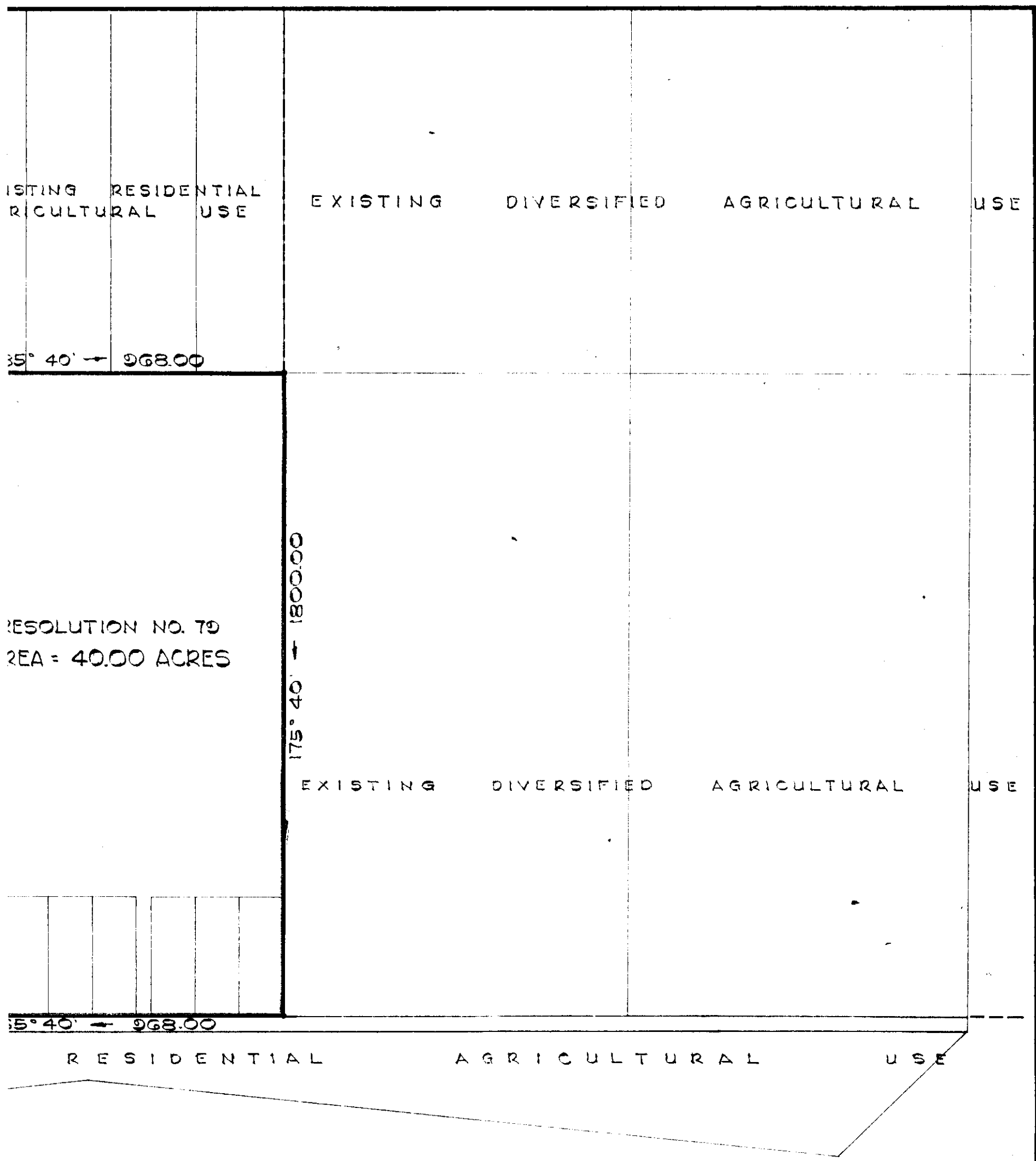

THE COUNTY GENERAL PLAN

RESOLUTION NO. 79

COUNTY GENERAL PLAN OF THE
 CHANGING THE PROPOSED LAND USE
 FROM RESIDENTIAL AGRICULTURE, TO
 RESIDENTIAL IN WAIAKEA HOMESTEADS,
 HILO, HAWAII.

DATE OF PUBLIC HEARING:
FEB. 16, 1968

DATE OF APPROVAL:

PREPARED BY: PLANNING COMMISSION
 COUNTY OF HAWAII

JAN. 26, 1968