

COUNTY OF HAWAII - STATE OF HAWAII

ORDINANCE NO. 151

AN ORDINANCE AMENDING THE GENERAL PLAN OF THE KAWAIHAE-PUAKO SHORELINE AREA BY CHANGING THE LAND USE DESIGNATION FOR A CERTAIN AREA OF LAND FROM COMMERCIAL AND PARKS-OPEN SPACE TO RESORT AND FROM PUBLIC AND SEMI-PUBLIC AND RESORT TO PARKS-OPEN SPACE IN OULI, SOUTH KOHALA, HAWAII.

BE IT ORDAINED BY THE BOARD OF SUPERVISORS OF THE COUNTY OF HAWAII:

SECTION 1. The General Plan of the Kawaihae-Puako shoreline area is hereby amended by changing the land use designation for a certain area of land from Commercial and Parks-Open Space to Resort and from Public and Semi-Public and Resort to Parks-Open Space in Ouli, South Kohala, Hawaii; as outlined in red on the map attached hereto, marked Exhibit "A," and by reference made a part hereof.

SECTION 2. This ordinance shall take effect upon its approval.

INTRODUCED BY:

Josephine L. Godao
SUPERVISOR, County of Hawaii

Hilo, Hawaii

Date of Introduction: September 4, 1968

Date of Adoption: September 18, 1968

CRESK

Ord. No. 151
Res. No. 151
L. D. No. 424-439
SEP 4 1968

SEP 18 1968

ORDINANCE NO. 151

(Bill No. 524 - 1968)

AN ORDINANCE AMENDING THE GENERAL PLAN OF THE KAWAIHAE-PUAKO SHORELINE AREA BY CHANGING THE LAND USE DESIGNATION FOR A CERTAIN AREA OF LAND FROM COMMERCIAL AND PARKS-OPEN SPACE TO RESORT AND FROM PUBLIC AND SEMI-PUBLIC AND RESORT TO PARKS-OPEN SPACE IN OULI, SOUTH KOHALA, HAWAII.

Date Introduced: September 4, 1968 - Date Approved:
September 18, 1968 - Date Effective: September 18, 1968.

ORDINANCE NO. 152

(Bill No. 525 - 1968)

AN ORDINANCE AMENDING SECTION 7.10, THE KAWAIHAE-PUAKO ZONE MAP, ORDINANCE NO. 63 (ZONING ORDINANCE), REVISED ORDINANCES OF THE COUNTY OF HAWAII 1967, AS AMENDED, BY CHANGING THE DISTRICT CLASSIFICATION OF A CERTAIN AREA OF LAND FROM VILLAGE COMMERCIAL (CV-10) AND OPEN TO RESORT HOTEL (V-1.25) AND FROM RESORT HOTEL (V-1.25) TO OPEN IN OULI, SOUTH KOHALA, HAWAII.

Date Introduced: September 4, 1968 - Date Approved:
September 18, 1968 - Date Effective: September 18, 1968.

Copies of the foregoing Ordinances, in full, are on file in the Office of the County Clerk for use and examination by the public.

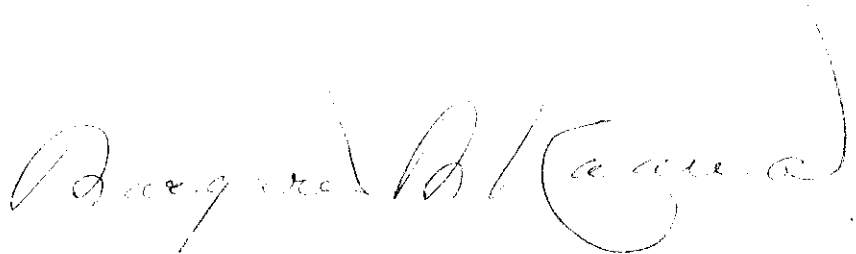

COUNTY CLERK
COUNTY OF HAWAII

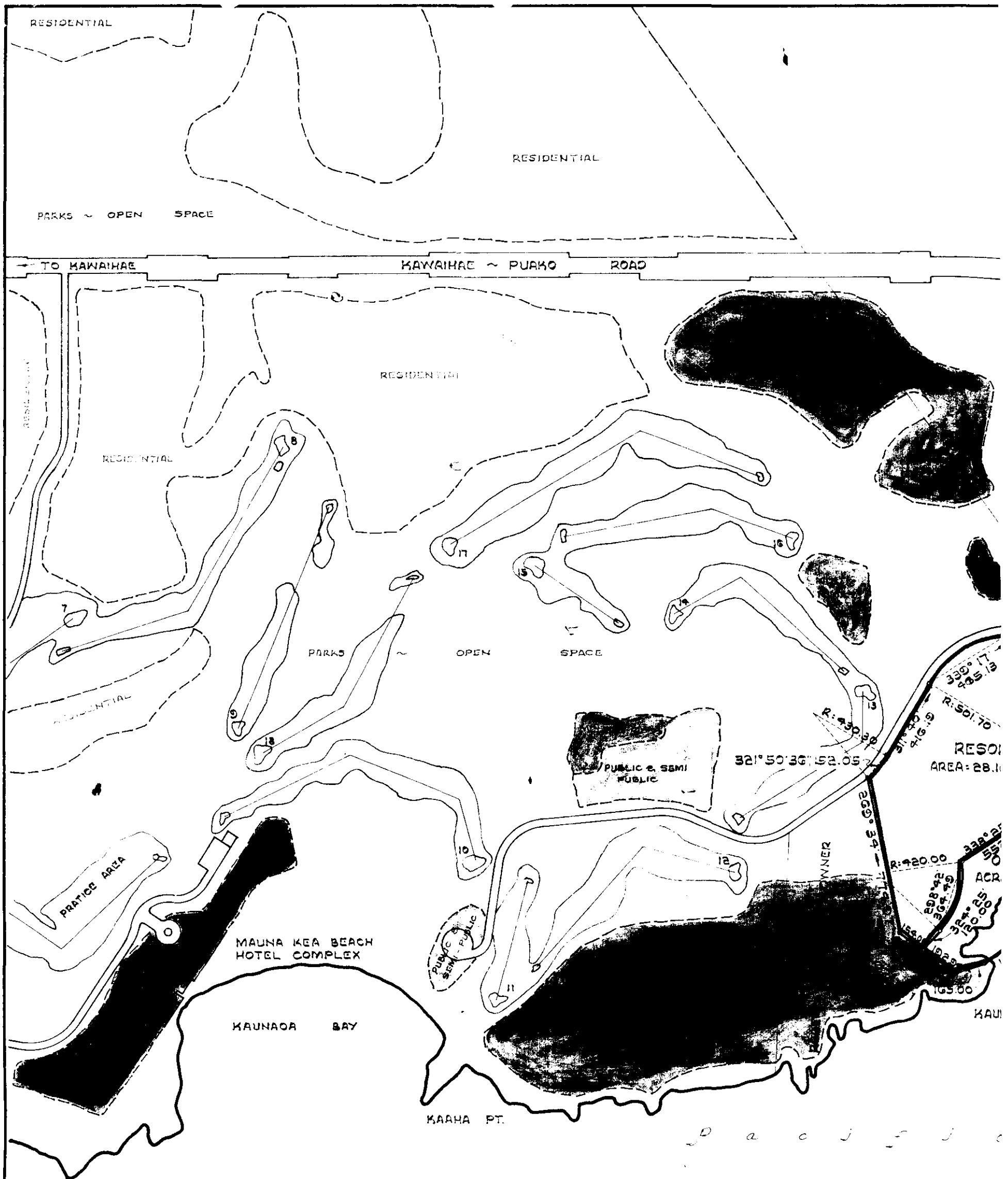

AMENDMENT TO THE COUNTY

RESOLUTION NO. 90

AMENDING THE COUNTY GENERAL PLAN OF THE KAWAIHAE AREA, CHANGING THE PROPOSED LAND USE DESIGNATION FROM PARKS-OPEN SPACE TO RESORT AND FROM PUBLIC RESORT TO PARKS-OPEN SPACE IN OULI, SOUTH KO

TAX MAP KEY : G-2-02

EXHIBIT "A"

TRUE NORTH
SCALE: 1" = 500'

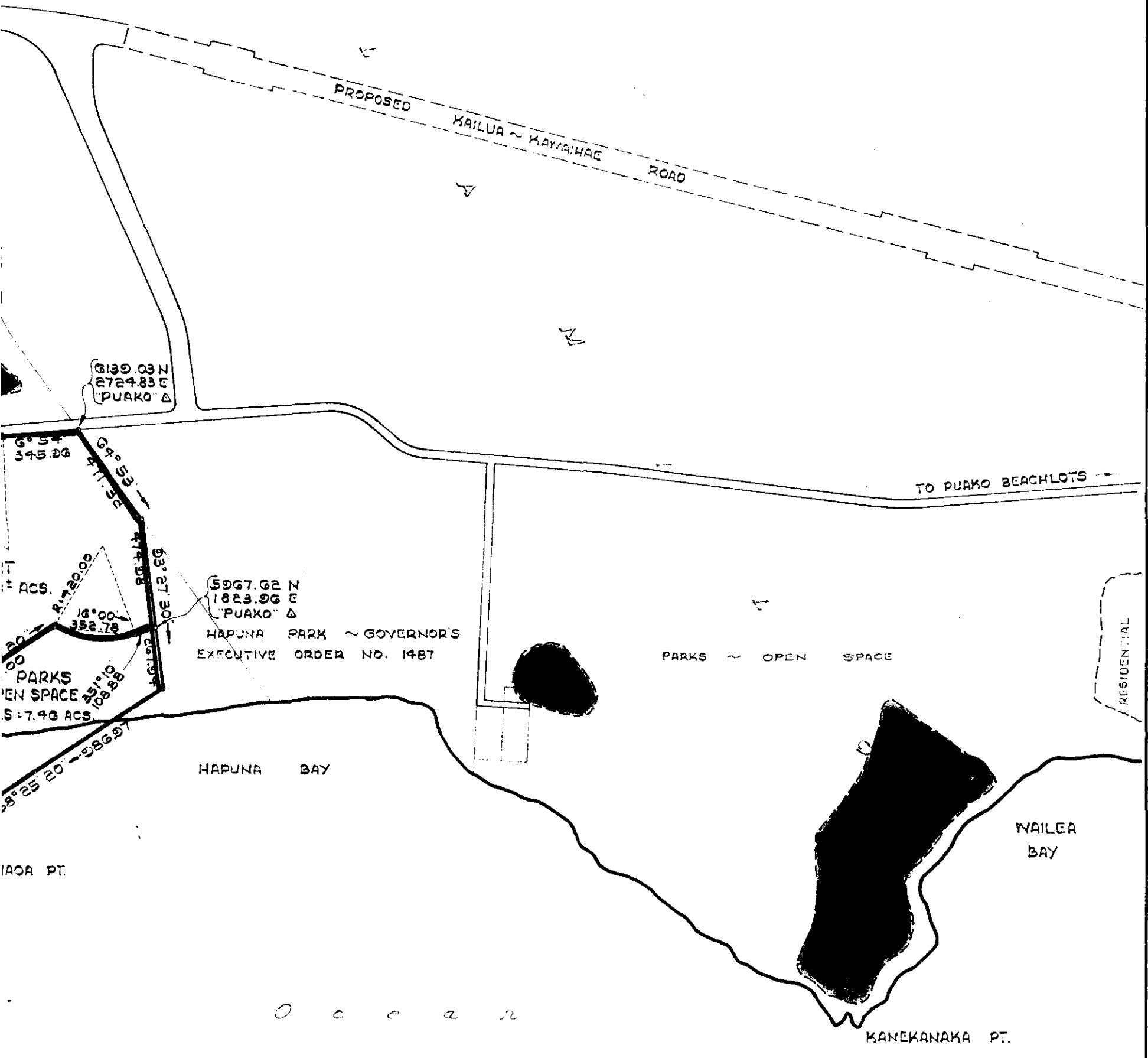

GENERAL PLAN

KAWAIIHAE ~ PUAKO SHORELINE
ZONING FROM COMMERCIAL
PUBLIC & SEMI-PUBLIC AND
RESIDENTIAL, HAWAII.

DATE OF PUBLIC HEARING: JUNE 28, 1968
DATE OF APPROVAL:

PREPARED BY: PLANNING COMMISSION
COUNTY OF HAWAII

JUNE 28, 1968