

COUNTY OF HAWAII STATE OF HAWAII

BILL NO. 371

ORDINANCE NO. 97 34

AN ORDINANCE AMENDING THE COUNTY OF HAWAII GENERAL PLAN AS ADOPTED BY ORDINANCE NO. 89-142 AND AS AMENDED BY ORDINANCE NOS. 90-71, 91-48, 91-72, 91-131, 92-115, 93-10 AND 93-11.

BE IT ORDAINED BY THE COUNCIL OF THE COUNTY OF HAWAII:

SECTION 1. The County of Hawaii General Plan Land Use Pattern Allocation Guide Map is hereby amended to redesignate approximately 25± acres of land, identified by Tax Map Key 8-1-04:Portion of 3 located at Keekee 2nd, Ilikahi, Kanakau 1st and 2nd and Kalukalu 1st, 2nd and 3rd, South Kona, Island of Hawaii, from "Orchards" to "Resort."

All as shown on the map attached hereto, marked Exhibit "A" and by reference made a part hereof.

SECTION 2. The County of Hawaii General Plan document, Land Use Element, is hereby amended to add Keekee to Kalukalu to the list of Resort (Retreat) Areas at page 81 of Exhibit "C."

SECTION 3. If any provision of this ordinance or the application thereof to any person or circumstance is held invalid, the invalidity shall not affect other provisions or applications of this ordinance which can be given effect without the invalid provision or application, and to this end the provisions of this ordinance are severable.

SECTION 4. This ordinance shall take effect upon its approval.

INTRODUCED BY:

COUNCIL MEMBER, COUNTY OF HAWAII

Hilo, Hawaii

Date of Introduction: February 19, 1997

Date of 1st Reading: February 19, 1997

Date of 2nd Reading: March 7, 1997

Effective Date: March 13, 1997

REFERENCE: Comm. Comm. 1473

APPROVED AS TO FORM AND LEGALITY

DEPUTY CORPORATION COUNSEL

DATED: MAR 10 1997

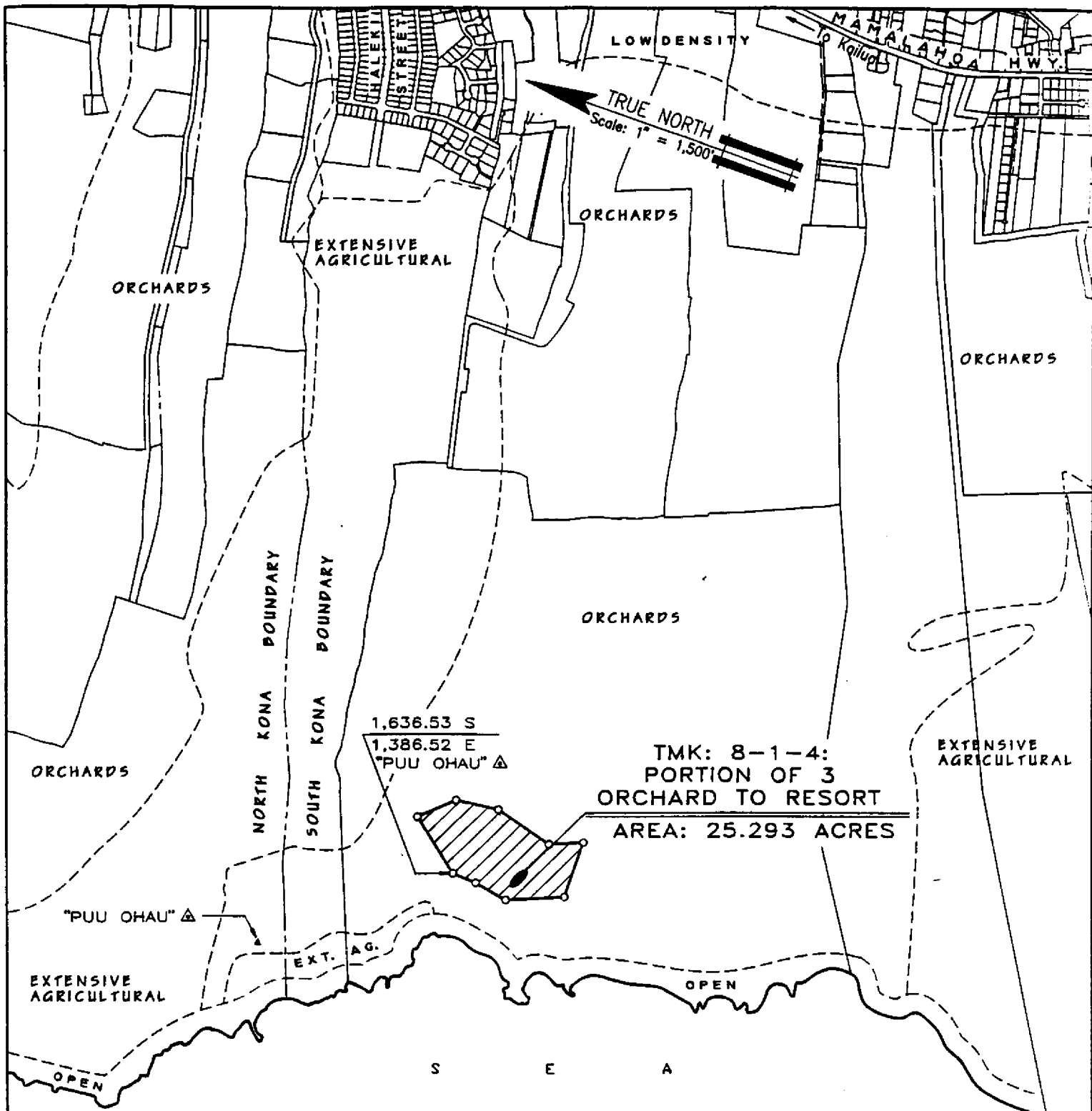

AMENDMENT TO THE GENERAL PLAN

AMENDING THE COUNTY OF HAWAII GENERAL PLAN LAND USE PATTERN ALLOCATION GUIDE MAP BY CHANGING THE LAND USE DESIGNATION FROM ORCHARD TO RESORT AT KEEKEE 2ND, ILIKAHI, KANAKAU 1ST AND 2ND AND KALUKALU 1ST, 2ND AND 3RD, SOUTH KONA, HAWAII.

PREPARED BY : PLANNING DEPARTMENT
COUNTY OF HAWAII

OFFICE OF THE COUNTY CLERK

County of Hawaii

Hilo, Hawaii

RECEIVED

1997 MAR 13 PM 2 17

Introduced By: Bobby Jean Leithead-Todd
 Date Introduced: February 19, 1997
 First Reading: February 19, 1997
 Published: N/A

REMARKS:

Second Reading: March 7, 1997
 To Mayor: March 7, 1997
 Returned: March 13, 1997
 Effective: March 13, 1997
 Published: March 21, 1997

REMARKS:

ROLL CALL VOTE				
	COUNTY	NOES	ABS	EX
Arakaki	X			
Chung	X			
Leithead-Todd	X			
Ray	X			
Reynolds	X			
Santangelo	X			
Smith	X			
Tyler	X			
Yagong	X			
	9	0	0	0

ROLL CALL VOTE				
	AYES	NOES	ABS	EX
Arakaki	X			
Chung	X			
Leithead-Todd	X			
Ray	X			
Reynolds	X			
Santangelo	X			
Smith	X			
Tyler		X		
Yagong	X			
	8	1	0	0

I DO HEREBY CERTIFY that the foregoing BILL was adopted by the County Council and published as indicated above.

APPROVED AS TO
FORM AND LEGALITY:

Patsia K. Opa
DEPUTY CORPORATION COUNSEL
COUNTY OF HAWAII

Date MAR 10 1997

James C. ...
COUNCIL CHAIRMAN

Donald ...
COUNTY CLERK

Approved / ~~Disapproved~~ this 13 day
of March, 1997

Hept ...
MAYOR, COUNTY OF HAWAII

Bill No.: 371
Reference: C-1473/1996/PC-25
Ord. No.: 97 34