

For Grant to H. Bischoff
Purchase Price \$ 216⁰⁰

Applicant H. Bischoff.
Kahoolawe, North Hills, Hawaii.

Described as Section # 10 in map.

Notes of Survey.

- Beginning at the post marking the South angle of Section # 3 - G. # 364 to C. Gutz, the boundary runs by true bearings,
- 1 - N 35° 53' W. 913' ft. along said grant to an ohia tree marked X1X, standing on bank of Alensio gulch, 20 ft. East from edge of bank,
 - 2 - S 47° 39' W. 1472' . along Alensio gulch the boundary following the windings of the bank, 30 ft. East from edge of same to an ohia Δ at West angle,
 - 3 - S 55° 13' E. ^{in grant} 1771' . along marks boundary to ohia Δ at South angle on edge Kacwalii gulch,
 - 4 - N 24° 19' E. 928' . along do, to (end) of narrow ridge, ^{edge in grant}
 - 5 - N 19° 02' W. 495' . across end of narrow ridge & following edge of Kacwalii gulch to the United Point.

Containing an area of 43.2. acres.

A. B. Lockenstein Surveyor.

November 7 - 1894.

Scale 500 ft = 1 inch.

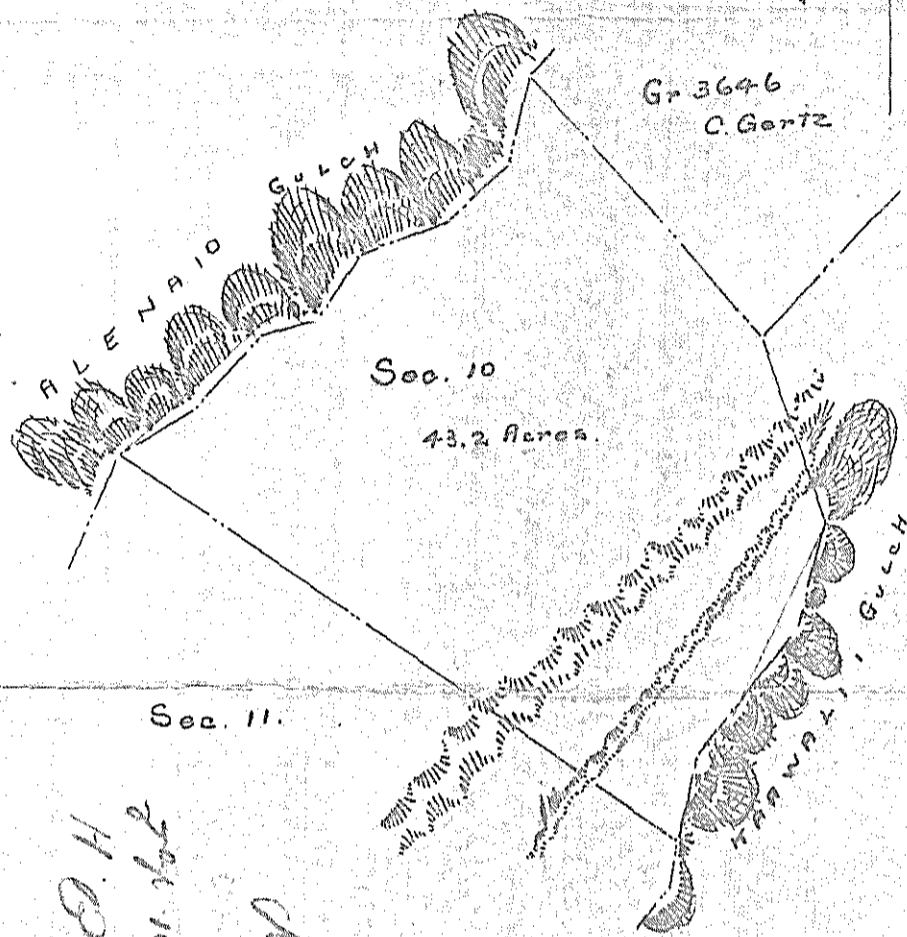

*Abundant in
 Sec. 10 Kawaiaii
 Nov 14 1880
 E. E. H.*

Scale 500 ft = 1 inch.