

Ap. 1.

Survey of a portion of Cr 916, to Kaia at
Kukua Hills.

Being a portion of Kurstan's division.

Beginning at the South West corner of this
piece of land on Old Goat Road and running

1. N 56° 30' E May 320 feet along Oka Kaulohala,

2. N 29° 30' W " 130. " " " Remaining

portion of Kurstan's division,

3. S 47° 00' E May 320 feet to Old Goat Road.

4. S 39° 30' E " 76 " to point of

beginning.

Containing 0.80 Acre.

R. E. Cook

Hilo Aug 16. 1909.

Survey of a portion of Gr. 916 Ap. 1 to Kaie
at Kuhua, South Hilo.

Being a portion of Kuritani's division.

Beginning at the South West corner of this
piece of land on Old Government Road and running

1. N 56° 30' E Mag. 320 feet along Aku and
Kealoha's,
2. N 39° 30' W Mag. 130 feet along remaining
portion of Kuritani's division,
3. S 47° 00' W Mag. 320 feet to old Government
Road,
4. S 39° 30' E Mag, 76 feet to point of
beginning.

Containing 0.80 Acre.

Surveyor.

Hilo, Aug. 16, 1909.

Survey of a portion of Gr. 916 Apana 1 to Kaie at
Kuhua Hilo.

Commencing at the N. E. corner of this division
adjoining C. Brewer & Co.'s division and running as follows:

1. S 40° 35' E Mag. 273 feet along C. Brewer &
Co.'s division,
2. S 56° 30' W Mag. 850 feet to Old government
Road, .
3. N 39° 30' W Mag. 345.84 feet along Government
Road,
4. N 61° 30' E Mag. 853.00 feet along Puaa grant
to initial point.
containing 6. Acres.

Surveyor

Hilo, Aug. 16, 1909.

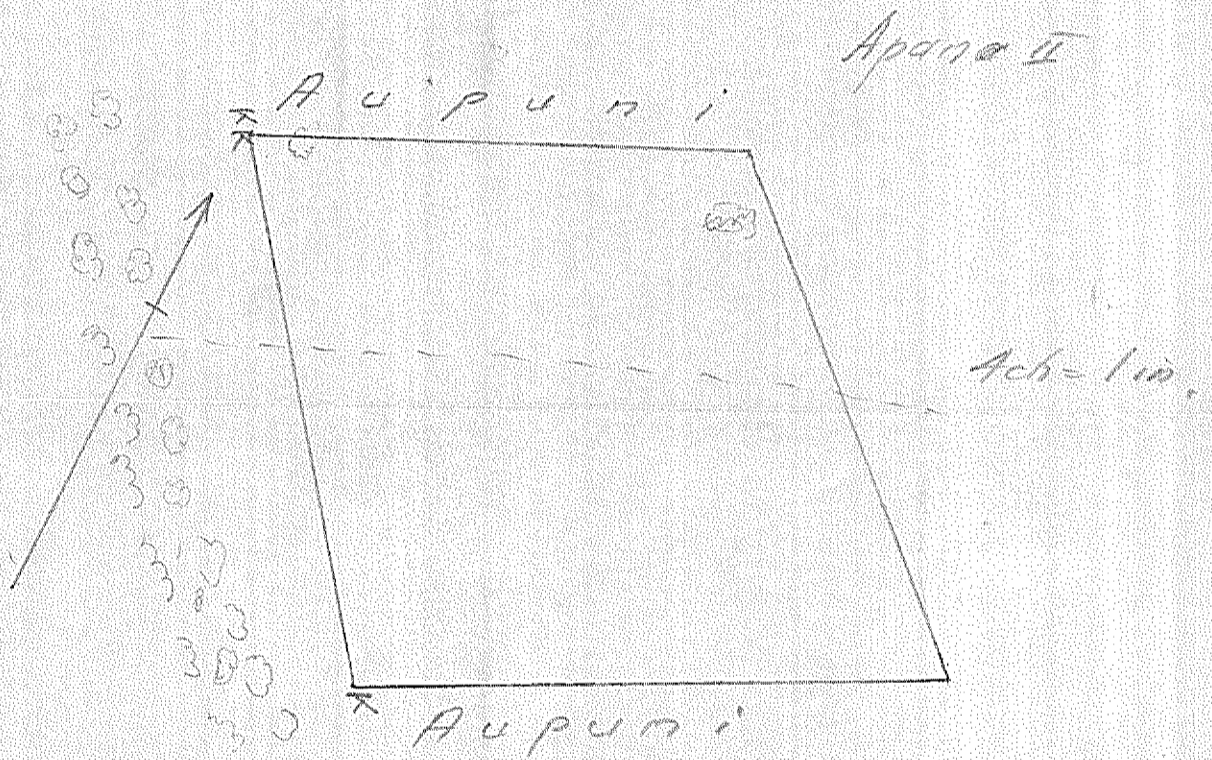
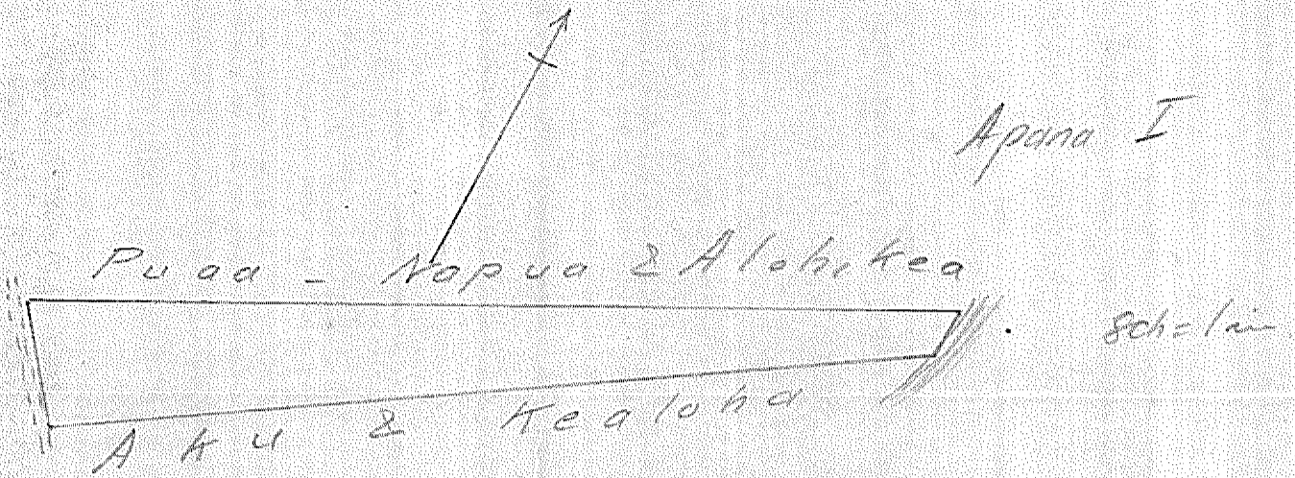

Survey of a portion of Gr 916 Grant. to
Kaie, at Kukua. Hills.

Commencing at The East corners of Puaa's
land at beach and running.

1. $S 61^{\circ} 30' W$ May 1771.0 feet to the North East corner
of Kuridani's portion of this Grant
2. $S 39^{\circ} 30' E$ May 372. feet, being division line be-
tween Kuridani and G. Brewer & Co.
3. $N 56^{\circ} 30' E$ May 1605. feet along Aka & Kealeha
to sea beach
4. Thence along Sea Shore to initial point
Containing $7. \frac{35}{100}$ Acres.

W. E. Cook.

Surveyor

Hilo Aug 16th 09.

Gr. 916 to Kaie

Kuhua Ikiho Hawaii

Ap. I E hoomaka keia ma ke kihi Hik. o ka
 aina o Puua ma ma kahakai a e holo
 Hem 6 1/2 Kom 39.00 ^{35.94} kaul. i ke alanui; alaila
 Hem 39 1/2 Hik 5.74 ^{34.534} " i ka aina o Aku; ^{alaila}
 Ak 56 1/2 Hik 37.00 ^{24.43} " i kahakai; alaila
 ma kahakai Ak 3 1/2 Hik
 2.00 ^{2.00} kaul i kahi i
 hoomaka'i.

Malako o keia 13 3/4 aka.

Ap. II E hoomaka keia ma kahi kumu
 ohia ma ke kihi Nema o keia (ua
 hooailonaia II) a e holo

Ak 38 Kom 11.80 kaul. i kahi kumu ohia ma
 ke kihi Kom. o keia; alaila
 Ak 65 1/2 Hik 10.40 kaul.; alaila
 Hem 47 1/2 Hik 11.68 " ; "
 Hem 62 Kom 12.27 " a kahi ma kahi i
 hoomaka'i.

Malako o keia 12 3/4 aka.

Wm Lyman
Surveyor

(no date)

Survey of a portion of Gr. 916 Apana 1 to
Kaie at Kuhua, South Hilo.

Commencing at the East corner of Puaa's
land at beach and running

1. S 61° 30' W Mag. 1721.0 feet to the North
East corner of Kuritani's portion
of this Grant,
2. S 39° 30' E Mag. 272 feet being division line
between Kuritani and C. Brewer
& Co.
3. N 56° 30' E Mag. 1605 feet along Aku and
Kealoha to sea beach
4. Thence along sea shore to initial point.
Containing 7 35/100 Acres.

Surveyor

Hilo, Aug. 16, 1909.