

I Nema 25° 31' N. 1.874 kch. ana ka Agawa o Apunani 10 Nema 57° 31' Kom
 ma ka Aina o Kapaeha, o 'Aiki i 'Aiki i ho'maka ai Iota o ka
 Agawa ku 7 1/2 kch
 Kau Hawaii Maraki 24th 1852. J. Fuller
 Luma ana Aina

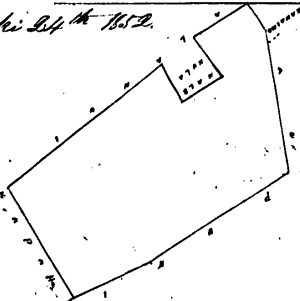

Ulu Pau Lau \$6-

W. H. Lee

J. Chaulakao
 G. M. Robinson
 J. H. Smith

Honolulu Mei 10th 1852

Hulu 10702 Aiki

Maechime Kauaunui

Keia Aina o Aiki ana Waikuaia Kau
 Choomaka ana ku Aiki Aiki a i hulu 7. M. 21° 15' Komkana 620 kch.
 ma ka Aina o Ke Konaiki 2. M. 77° 51' Kom. 175 kch. ana ka Aina o
 Kaka 3. M. 34° Kom. 1877 kch. ana ka Aina o Kaka 4. Kom. 57° Kom. 2.40
 kch. ana ka Aina o Konaiki 5. Kom. 28° 16' N. 1.50 kch. ana ka Aina o
 Konaiki 6. M. 53. N. 1.10 kch. ana ka Aina o Konaiki aiki i ka
 ki ho'maka ai Iota o ka Aina ku 7 1/2 kch. J. Fuller
 Kau Hawaii Aperila 15th 1852. Luma ana Aina

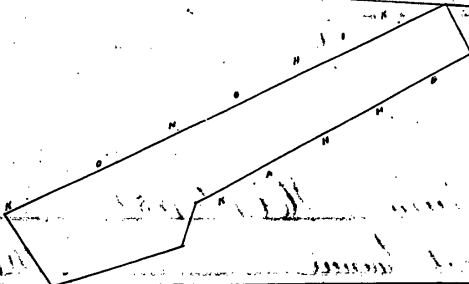

Ulu Pau Lau \$6-

W. H. Lee
 J. Chaulakao
 G. M. Robinson
 J. H. Smith