

Okela 7525 Okoni

Waikawa, Man. Hawaii.

1. *Māna* *Okoni* ma *Waikawa*, *Hāu*.  
 E *hōmaka* ma *hōhō* *Okela* a e *hōhō* *Okela* 3° 30' *Okela* 1.25 *Okela* ma *hōhō* a *Okoni*; *Okela* 23° 15' *Okela* 6, 2.4  
*Okela* ma *hōhō* a *Okoni*; *Okela* 53° 15' *Okela* 5, 32 *Okela* ma *hōhō* a *Okoni*; *Okela* 1° *Okela* 2, 75 *Okela* ma *hōhō* a *Okoni* a  
*Okoni*; *Okela* 44° 45' *Okela* 4, 22 *Okela* ma *hōhō* a *Okoni*; *Okela* 63° *Okela* 6, 22 *Okela* ma *hōhō* a *Okoni* a *Okoni* a *Okoni*  
 a *Okoni* i *Okoni*. *Okela* a *Okoni* *Okela* 1/2 *Okela*.

J. Fuller  
 Luna *Okoni*.

2. *Okela* ma 1 *Okela*.

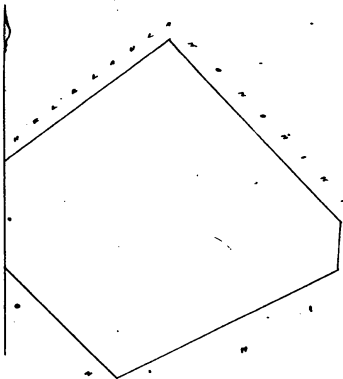

*Okela* *Okela*

15.

J. H. Pickett  
 Landed  
 W. H. Lee  
 J. W. Protection  
 J. K. Kaulaheo

Okoni 11707 Okoni 19, 1857.

Okela 11707 Okoni

Waikawa, Man. Hawaii.

1. *Māna* *Okoni* ma *Waikawa*, *Hāu*.  
 E *hōmaka* ma *hōhō* *Okela* a e *hōhō* *Okela* 25° 30' *Okela* 4, 65 *Okela* ma *hōhō* a *Okoni*; *Okela* 61° *Okela* 3, 21 *Okela*  
 ma *hōhō* a *Okoni*; *Okela* 25° 15' *Okela* 4, 21 *Okela* ma *hōhō* a *Okoni*; *Okela* 61° 15' *Okela* 3, 22 *Okela* ma *hōhō*  
 a *Okoni*; *Okela* 44° 45' *Okela* 4, 22 *Okela* ma *hōhō* a *Okoni* i *Okoni* i *Okoni*. *Okela* a *Okoni* *Okela* 1/2 *Okela*.

2. *Māna* *Okoni* ma *Waikawa*, *Hāu*.  
 E *hōmaka* ma *hōhō* *Okela* a e *hōhō* *Okela* 65° *Okela* 6, 55 *Okela* ma *hōhō* a *Okoni*; *Okela* 11° *Okela*  
 5, 55 *Okela* ma *hōhō* a *Okoni*; *Okela* 65° *Okela* 5, 55 *Okela* ma *hōhō* a *Okoni*; *Okela* 1° 55' *Okela* 5, 80 *Okela* ma  
 a *Okoni* a *Okoni* a *Okoni* i *Okoni* i *Okoni*. *Okela* a *Okoni* *Okela* 3/4 *Okela*.

Waikawa, July 22, 1857.  
 J. Fuller  
 Luna *Okoni*.

2. *Okela* ma 1 *Okela*.

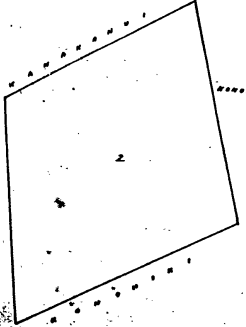

2. *Okela* ma 1 *Okela*.

