

R. P. 7315. L. C. a. 3838 Palau

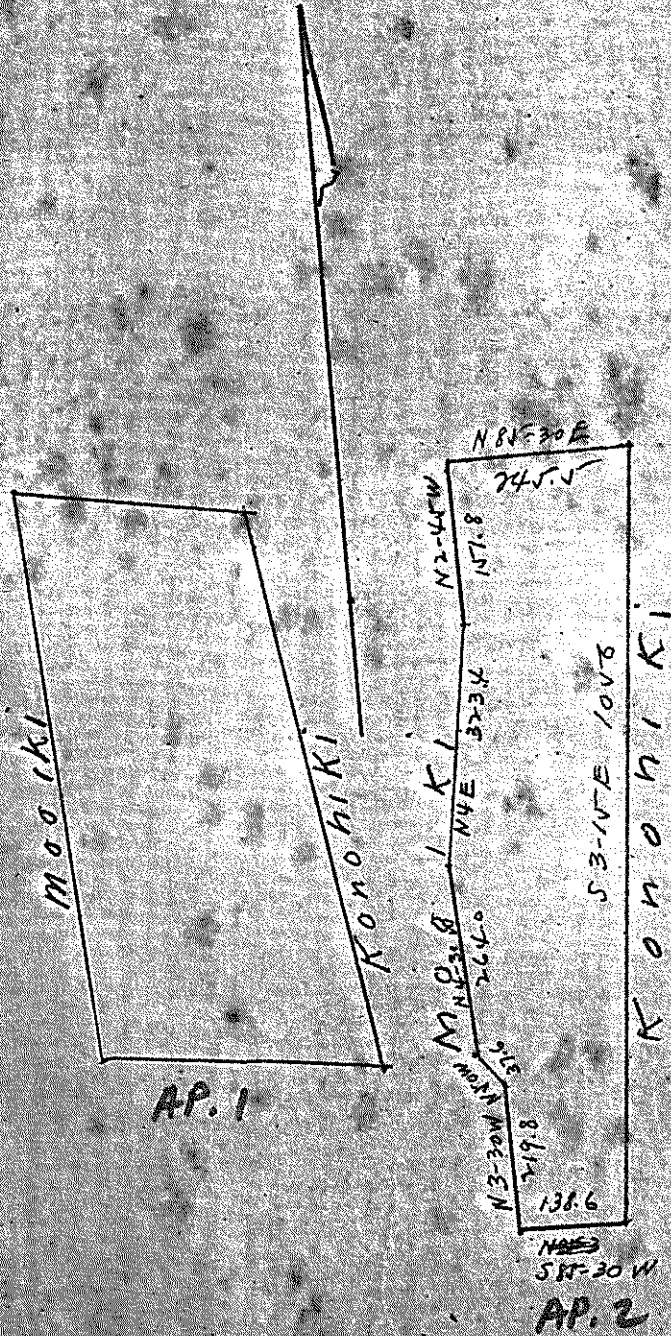

apana 1 - Pahoa & Kihapai. E hoomaka ana ma  
 Ke Kaha He mooka ma Kaha pohaku a e  
 holo ana

792 a 10° Kō 12.00 Kane  
 10.4 a 78½ Kō 4.40 Kē. ma ko Kōnō  
 alala  
 798.6 He. 3° He 12.10 Kane ma Ka  
 palena o  
 Mōōki alala  
 382.5 He 84° He 5.80 Kē. a hiki ma  
 Kahi i hoomaka

Ma Kaha apuna 5.93 ka

ap. 2 aima-mahu. E hoomaka ana ma  
 Ke Kaha Ke mōōki a e holo ana

✓ 245.5 a 85½ He 3.72 alala  
 ✓ 105.6 He. 3¼ Kō 16.00 Kē.  
 ✓ 138.6 He. 85½ Kō 2.10 Kē. ma ko Kōnōhū  
 ✓ 19.8 a. 3½ Kō 3.33 Kē  
 ✓ 37.6 a. 50° Kō 5.7 fanka  
 ✓ 264.0 a 4½ Kō 4.00 Kane  
 323.4 a. 4° He 4.90 Kane  
 ✓ 151.8 a. 2¾ Kō 2.30 Kē. ma ka  
 palena o Mōōki

a hiki i Kahi i hoomaka

Ma Kaha apuna 5½ ka

C. J. Lyons  
 Surveyor

June 14 1857

PROPERTY OF  
 TERRITORIAL SURVEY DEPT.