

Honolulu Noe 11<sup>th</sup> 1852

1852

Hele 8121 Honolulu

Wāhine Kāu Hawai

He Pahle Pahloholona, a mi Pahuaq o Honolulu ona  
Wāhine Kāu O hōmaka ma ka piki 11k. he jūu pahaka  
a e holo 19km. 530 Kom. 5.12 k. ma ka aina o ka Kōnōhiki 2. M. 36° 15' k.  
4.82 k. ma ka aina o ka Kōnōhiki 3. M. 65° 15' k. 5.23 k. ma ka  
aina o Kōnōhiki 4. Kōmū 29° k. 3.65 k. ma ka aia o ka aia o Kōnōhiki  
a piki i ka hōmaka ai. Hele o hea aia o ka aia o Kōnōhiki  
J. Fuller

Kāu Hawai April 17<sup>th</sup> 1852

Luna Aina Aina

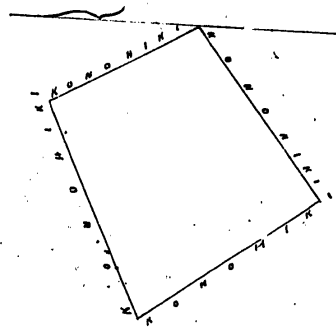

Ulu Pahuaq #2

W. P. P. P.  
J. K. K. K.  
G. M. K. K.  
J. K. K. K.

Honolulu Noe 10<sup>th</sup> 1852

Hele 8121 Pupule

Wāhine Kāu Hawai

Hea aia o Pupule ma Wāhine Kāu Hawai  
O hōmaka ma ka piki Pikiina 2. e holo 19km. 4.15 Kom. 5. k.  
ma ka aia o Kōnōhiki 2. M. 40° 30' Kom. 14.57 k. ma ka aia o  
Kōnōhiki 3. M. 65° 15' Kōhina 4. 20 k. ma ka aia o Kōnōhiki  
4. Kōmū 4.30 Kōhina 14.57 k. ma ka aia o Kōnōhiki a piki i ka hōmaka  
ai. Hele o hea aia o ka aia o Kōnōhiki  
J. Fuller  
Kāu Hawai April 15<sup>th</sup> 1852

Luna Aina Aina

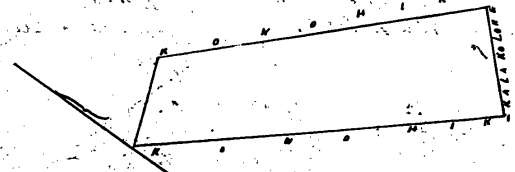

Royal Patent 6941

Uku Pau Loa

86-

Moku

J. Kakaulaha

J. M. Robertson

J. H. Smith

Honolulu Mai 10<sup>th</sup> 1852

Uku 7629 Kalanapahana

Mohowae Kau Hawaii

Kuia aina o Kalanapahana ma Tooponuweli Kau  
 o hoamaka ona ke kahi Kom. a o hole 1<sup>st</sup> Kom. 11.59 kch. ma  
 ka aina o Ke Aupuni 2<sup>nd</sup> Kom. 52<sup>nd</sup> 31<sup>st</sup> Niki 7 kch. ma ka aina o  
 Ke Aupuni 3<sup>rd</sup> Kom. 17<sup>th</sup> 45<sup>th</sup> Niki 11.61 kch. ma ka aina o Ke Aupuni  
 4<sup>th</sup> Kom. 62<sup>nd</sup> 45<sup>th</sup> Kom. 43<sup>rd</sup> kch. ma ka aina o Ke Aupuni a heki  
 i kahi i hoamaka pi. Iloko o keia aina he 6<sup>th</sup> Oku J. Fuller  
 Kau Hawaii Aperila 12<sup>th</sup> 1852. Luna Aina Aina

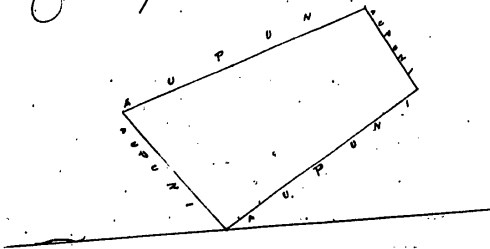

Uku Pau Loa

85-

Moku

J. Kakaulaha

J. M. Robertson

J. H. Smith

Honolulu Mai 10<sup>th</sup> 1852

Uku 9565 Houkiku

Mohowae Kau

Kuia aina o Houkiku ma Mohowae Kau  
 o hoamaka ona ke kahi Ak. a o hole 1<sup>st</sup> Kom 3<sup>rd</sup> Niki 12.91 kch. ma  
 ka aina o Ke Aupuni 2<sup>nd</sup> Kom. 57<sup>th</sup> 31<sup>st</sup> Kom. 5.58 kch. ma ka aina  
 o Ke Aupuni 3<sup>rd</sup> Kom. 38<sup>th</sup> 45<sup>th</sup> Kom. 12.91 kch. ma ka aina o Ke Aupuni  
 4<sup>th</sup> Kom. 59<sup>th</sup> 15<sup>th</sup> Niki 5.88 kch. ma ka aina o Ke Aupuni a heki  
 i kahi i hoamaka pi. Iloko o keia aina he 6<sup>th</sup> Oku J. Fuller  
 Kau Hawaii Aperila 1<sup>st</sup> 1852. Luna Aina Aina

