

Ulu Jau Lu 89.

J. M. Robertson
 Kromki
 W. H. Smith
 S. N. Smith
 S. N. Kaulahar

Amululu Naramba 19, 1851

Suku 8121 Amululu

Wachimu Nara, Naramba

Afana Arua ma Wachimu Nara.
 E Naramba ma Ulu Jau Lu. Nk 55' Nara 10, 55 Nk ma Ulu Jau Lu. Nk 55' Nara 20' 15' Nara.
 6, 55 Nk ma Ulu Jau Lu. Nk 55' Nara 20' 15' Nk 8, 70 Nk ma Ulu Jau Lu. Nk 55' Nk 2, 50 Nk.
 ma Ulu Jau Lu. Nk 55' Nara 20' 15' Nk 8, 70 Nk ma Ulu Jau Lu. Nk 55' Nk 2, 50 Nk.

Wachimu July 25, 1851.

J. Fuller
 Luna Arua Naramba

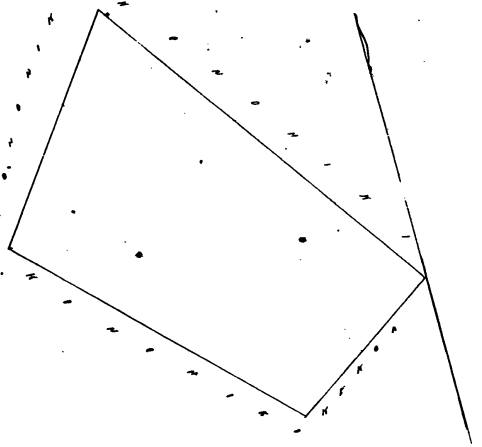

Ulu Jau Lu 95.

J. M. Robertson
 Kromki
 W. H. Smith
 S. N. Smith
 S. N. Kaulahar

Amululu Naramba 19, 1851.