

Ret to CR

November 10, 1982

Ms. Constance B. Akamu
399 Iwalani Street
Hilo, HI 96720

Dear Ms. Akamu:

Ohana Dwelling Permit (OD82-26)
Tax Map Key:2-4-19:10

This is to inform you that the subject application has been reviewed by all of the concerned agencies, and the following are our findings:

1. The subject property is served by an acceptable street.
2. The State Department of Health has found no environmental health concerns with regulatory implications in the submittal.
3. You have proven to our satisfaction that there are no restrictive covenants prohibiting the additional dwelling on the lot.
4. Submitted plans include two off-street parking stalls on the property.

Based on the above, you are hereby granted approval to permit the construction of an Ohana Dwelling, subject to the following condition(s):

- (1) The applicant must obtain a Flood Insurance Rate Map determination for the subject property from the Department of Public Works (Plans and Surveys). Building permit submittals for the Ohana Dwelling must comply with established flood regulations.

NOV 12 1982

Ms. Constance B. Akamu

Page 2

November 10, 1982

- (2) Construction of the driveway approach shall be in accordance with Department of Public Works (Plans and Surveys) regulations. A copy of the Department's memorandum is enclosed for your information.
- (3) The building permit for the Ohana Dwelling shall be secured within two (2) years of the date of this Permit. Should you fail to comply with the timetable, this Ohana Dwelling Permit shall be automatically voided.
- (4) This Ohana Dwelling permit is subject to all other applicable rules, regulations and requirements, including but not limited to those of the Planning Department, Department of Public Works, and State Department of Health.

Should you have any questions regarding the above, please feel free to contact either Masa Onuma or William Yamanoha of my staff at 961-8288. We are returning any duplicate sets of construction drawings submitted with your application. Please bring this Permit with you when you apply for a building permit for the Ohana Dwelling.

Sincerely,



for Sidney Fuke
Planning Director

CR:ds
Enc.

cc: Department of Health,
Chief Sanitarian
Department of Water Supply

ABANDONED 20'-0"
RAILWAY. (STATE OF HAWAII)

90.00'

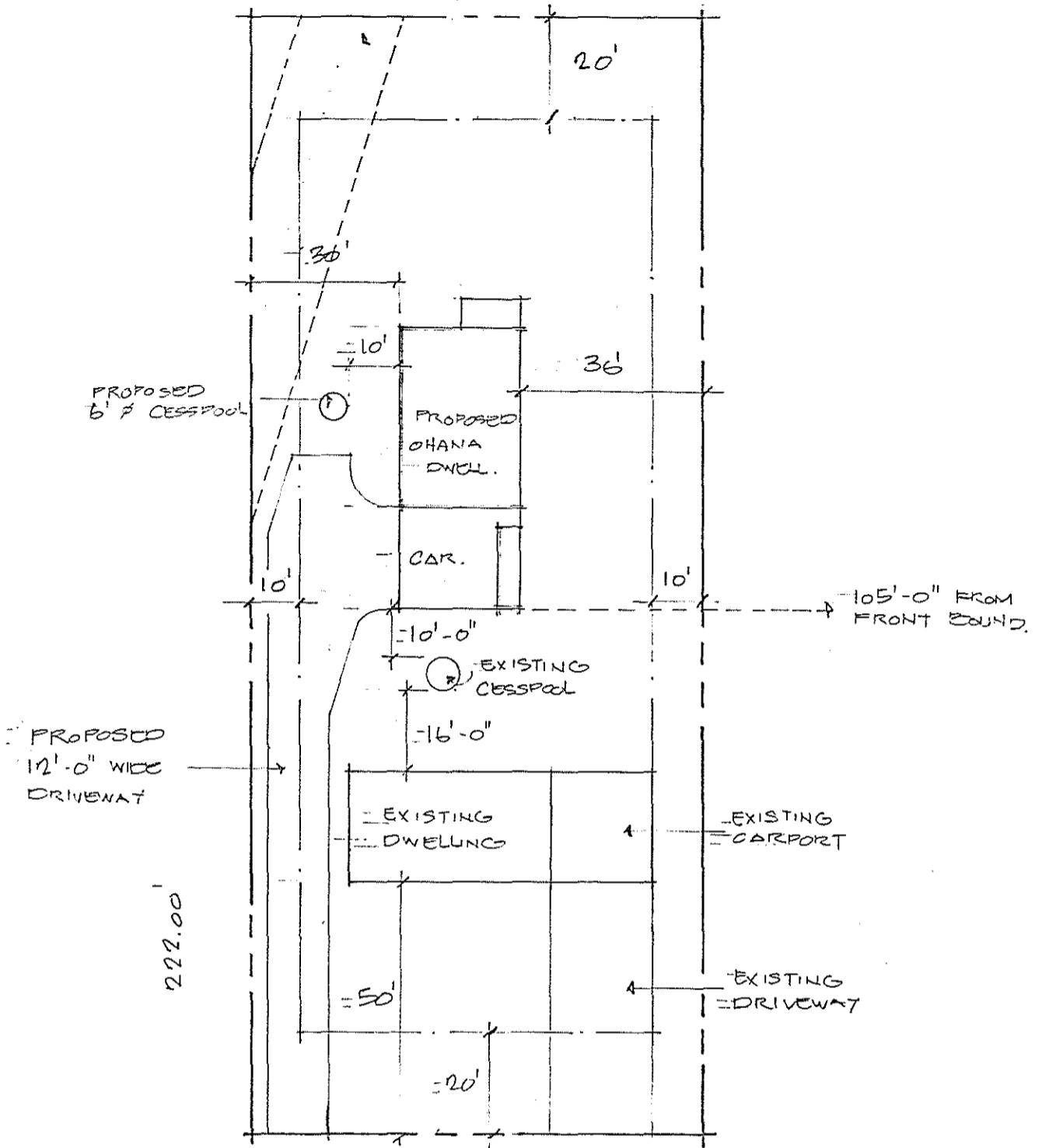

KIWA LANI ST.

PLANS FOR:

MR. & MRS.

TMK.: 2-4-19: 10 LOT# 4-B

LOT AREA: 18,545 sq. FT.

SC.: 1" = 30.00'

WAIAKEA UNSTOS., 1ST SERIES, S WILLO, HI.