

February 8, 1984

Mr. Albert Ah Sing, Jr.
P. O. Box 1234
Pahoa, HI 96778

Dear Mr. Ah Sing:

Ohana Dwelling Permit (OD 84-2)
Tax Map Key: 1-6-48:76

This is to inform you that the subject application has been reviewed by all of the concerned agencies, and the following are our findings:

1. The subject property is served by an acceptable street.
2. The State Department of Health has found no environmental health concerns with regulatory implications in the submittal.
3. You have proven to our satisfaction that there are no restrictive covenants prohibiting the additional dwelling on the lot.
4. Submitted plans include two off-street parking stalls on the property.

Based on the above, you are hereby granted approval to permit the construction of an Ohana Dwelling, subject to the following condition(s):

- (1) The building permit for the Ohana Dwelling shall be secured within two (2) years of the date of this Permit. Should you fail to comply with the timetable, this Ohana Dwelling Permit shall be automatically voided.

Mr. Albert Ah Sing, Jr.
Page 2
February 8, 1984

- (2) This Ohana Dwelling permit is subject to all other applicable rules, regulations and requirements, including but not limited to those of the Planning Department, Department of Public Works, and State Department of Health.

Should you have any questions regarding the above, please feel free to contact either Masa Onuma or William Yamanoha of my staff at 961-8288. Please bring this Permit with you when you apply for a building permit for the Ohana Dwelling.

Sincerely,



Sidney Fuke
Planning Director

MO:wkm

cc: Department of Health,
Chief Sanitarian
Department of Public Works

PERMITS REQUIRED FOR GRADING/EXCAVATION
 In accordance with Ordinance No. 150, as amended,
 Permits shall be obtained from the Bureau of Plans and
 Survey of the Department of Public Works for all
 grading work having a depth of more than 12 inches.

EXCAVATIONS
 No building shall be constructed within or over a
 drainage course.

820595

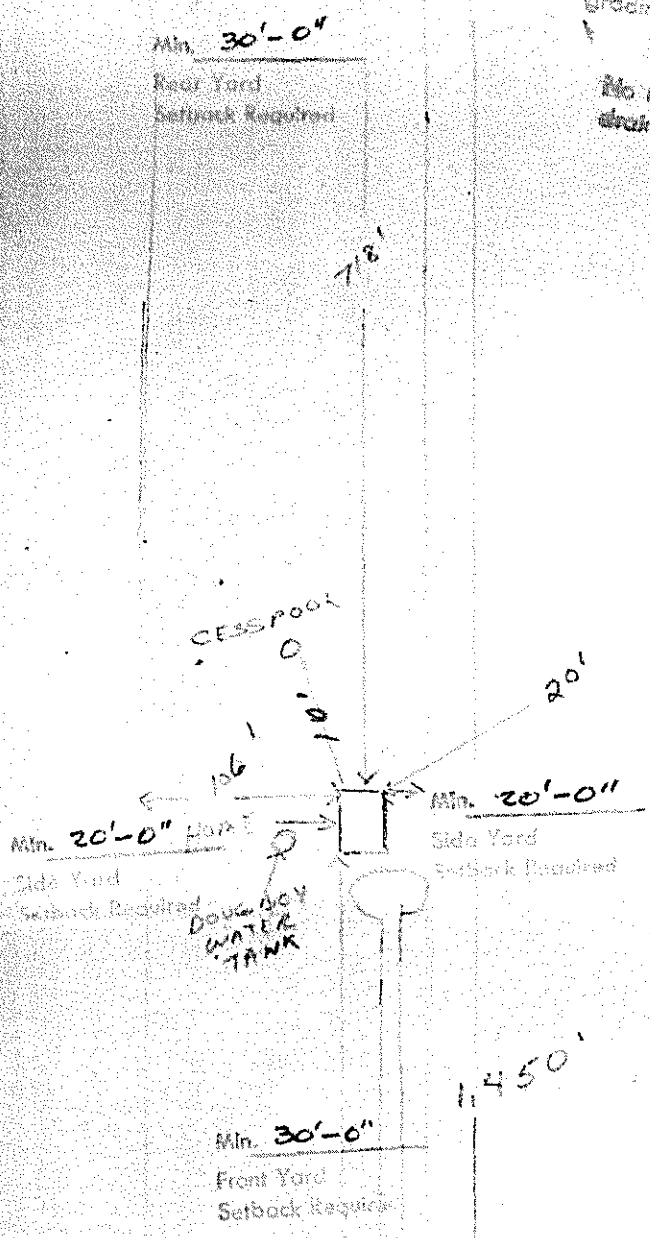

APPROVED:
Keith Kato
 for Director, County Planning Department
 Date: 3/30/82

This set of approved plans and specifications shall be kept on job site at all times during construction.

JOB SITE COPY

Date 4/2 19 82
 APPROVED C. Nishida
 BUREAU HEAD

ALBERT AHSING JR
 16-048-076

PLOT MAP
 SCALE: 1" = 150'

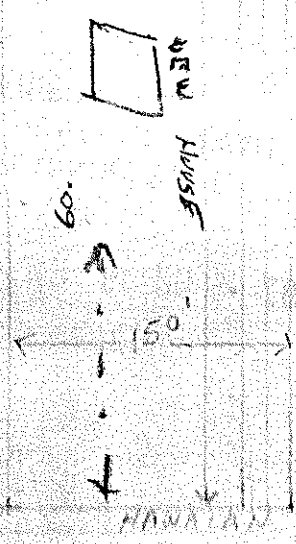

HAWAIIAN ACRE ROAD 9