

March 23, 1984

Mrs. Casimera G. Galdones  
112 Punahale Street  
Hilo, HI 96720

Dear Mrs. Galdones:

Ohana Dwelling Permit (OD 84-31)  
Tax Map Key: 2-3-24:57

This is to inform you that the subject application has been reviewed by all of the concerned agencies, and the following are our findings:

1. The subject property is served by an acceptable street and subject to a ten (10) foot wide future road widening setback to be taken on and from the parcel's frontage on Punahale Street.
2. The State Department of Health has found no environmental health concerns with regulatory implications in the submittal.
3. You have proven to our satisfaction that there are no restrictive covenants prohibiting the additional dwelling on the lot.
4. Submitted plans include two off-street parking stalls on the property.

Based on the above, you are hereby granted approval to permit the construction of an Ohana Dwelling, subject to the following condition(s):

- (1) A cesspool may service a maximum of 800 gallons per day of sewage which is generated from a single or multiple dwelling unit complex, containing a total of only four (4) bedrooms.

MAR 27 1984

Mrs. Casimera G. Galdones

Page 2

March 23, 1984

- (2) The building permit for the Ohana Dwelling shall be secured within two (2) years of the date of this Permit. Should you fail to comply with the timetable, this Ohana Dwelling Permit shall be automatically voided.
- (3) This Ohana Dwelling permit is subject to all other applicable rules, regulations and requirements, including but not limited to those of the Planning Department, Department of Public Works, and State Department of Health.

Should you have any questions regarding the above, please feel free to contact either Masa Onuma or William Yamanoha of my staff at 961-8288. Please bring this Permit with you when you apply for a building permit for the Ohana Dwelling.

Sincerely,



Sidney Fuku  
Planning Director

WRY:wkm

cc: Department of Health,  
Chief Sanitarian  
Department of Public Works  
Real Property Tax Division

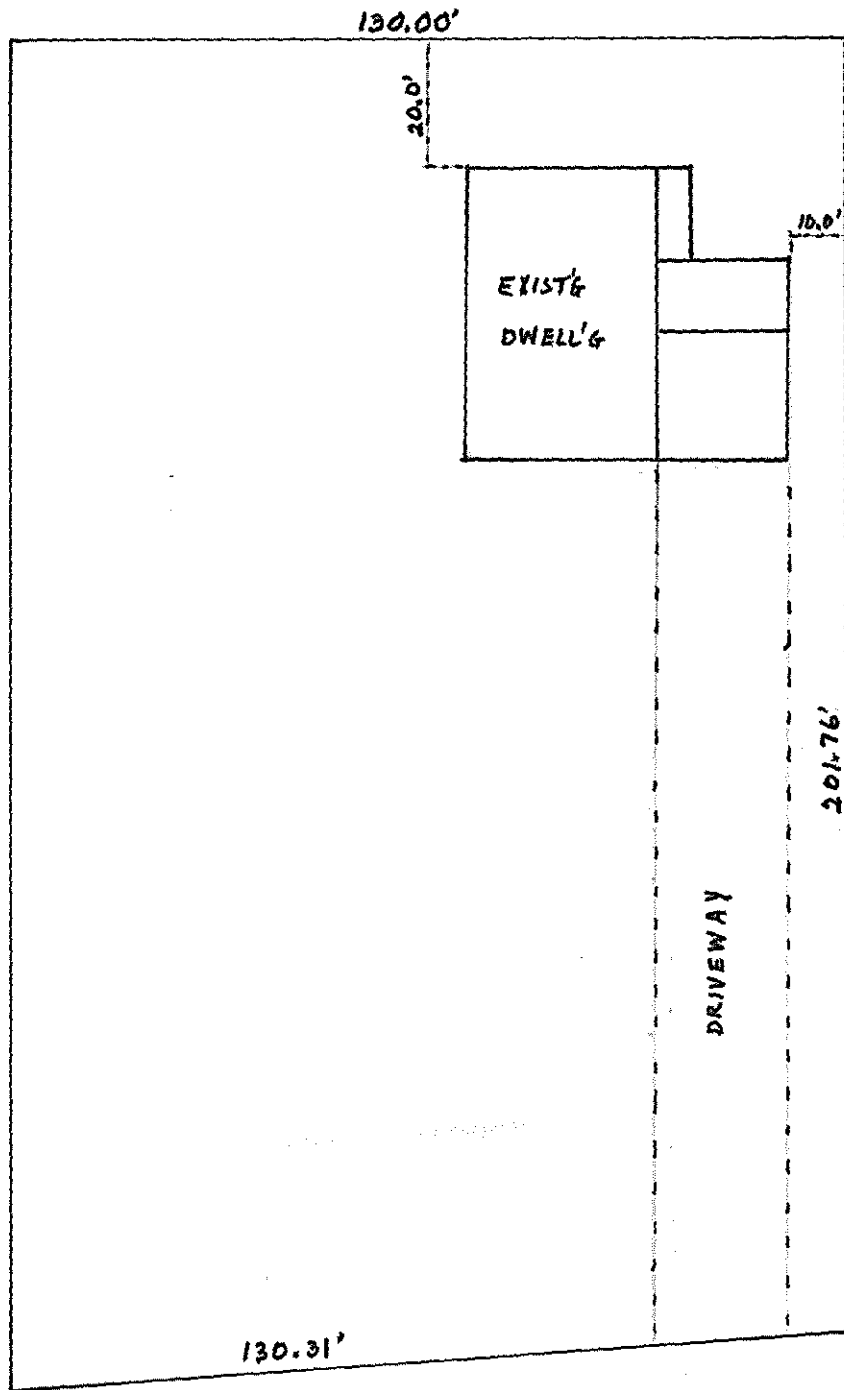

CASIMERA G. GALDONES  
112 PUNAHELE STREET, HILO, HI 96720  
TMK: 2-3-24-57