

June 18, 1984

Ms. Thelma C. Nip
465 Luakini Street
Honolulu, HI 96817

Dear Ms. Nip:

Ohana Dwelling Permit (OD 84-67)
Tax Map Key: 2-2-39:136

This is to inform you that the subject application has been reviewed by all of the concerned agencies, and the following are our findings:

1. The subject property is served by an acceptable street.
2. The application can meet with the State Department of Health wastewater treatment and disposal systems requirements.
3. You have proven to our satisfaction that there are no restrictive covenants prohibiting the additional dwelling on the lot.
4. Submitted plans include two off-street parking stalls on the property.

Based on the above, you are hereby granted approval to permit the construction of an Ohana Dwelling, subject to the following condition(s):

- (1) The building permit for the Ohana Dwelling shall be secured within two (2) years of the date of this Permit. Should you fail to comply with the timetable, this Ohana Dwelling Permit shall be automatically voided.

JUN 19 1984

Ms. Thelm C. Nip
Page 2
June 18, 1984

- (2) This Ohana Dwelling permit is subject to all other applicable rules, regulations and requirements, including but not limited to those of the Planning Department, Department of Public Works, and State Department of Health.

Should you have any questions regarding the above, please feel free to contact either Masa Onuma or William Yamanoha of my staff at 961-8288. Please bring this Permit with you when you apply for a building permit for the Ohana Dwelling.

Sincerely,



Sidney Fuke
Planning Director

WY:gs

cc: Department of Health,
Chief Sanitarian
Department of Public Works
Real Property Tax Division

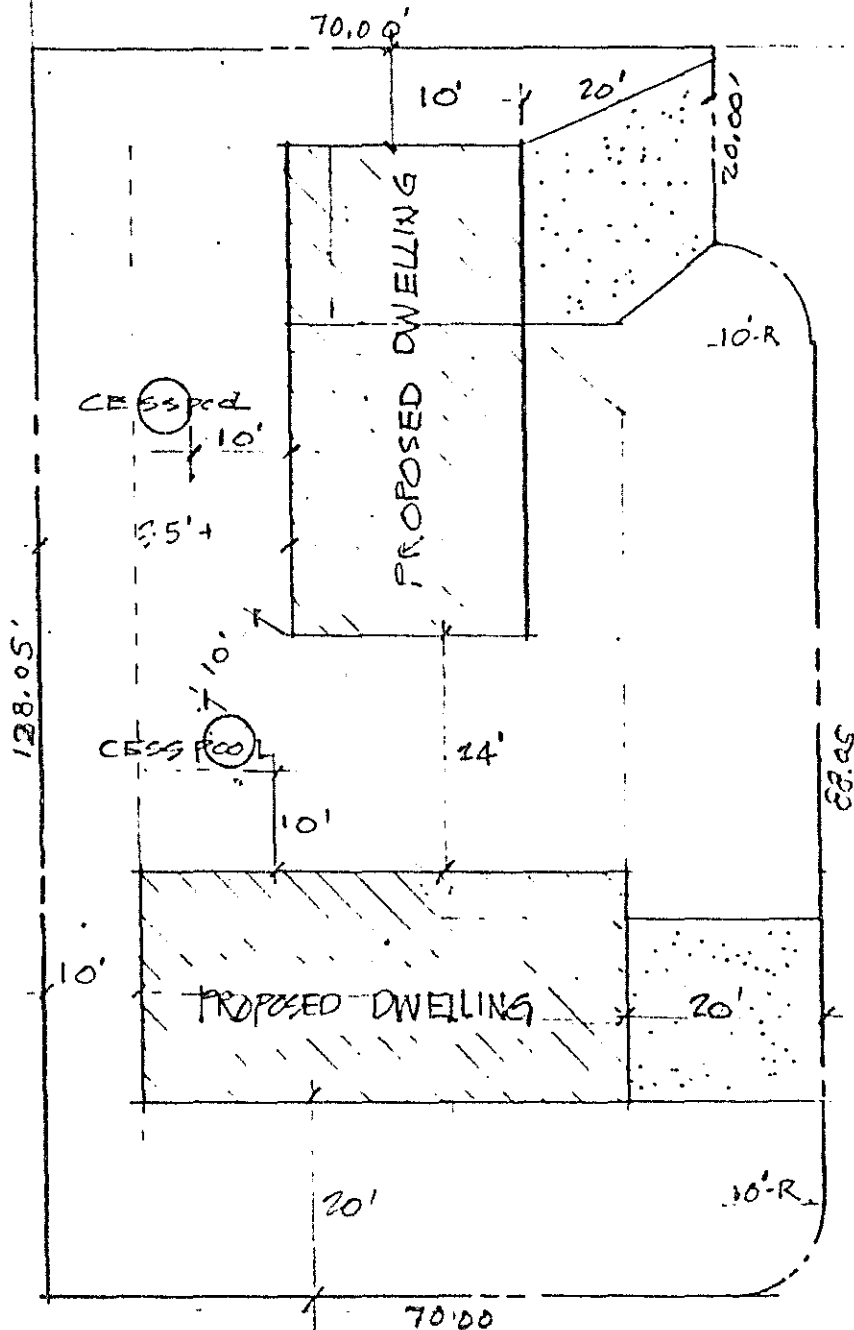

PLOT PLAN 1"=20.00'

TMK: 2-2-39-136

KILAUEA AVENUE