

August 17, 1984

Shoichi and Mutsuko Fukaura
P. O. Box 393
Paauilo, HI 96776

Dear Mr. and Mrs. Fukaura:

Ohana Dwelling Permit (OD 84-91)
Tax Map Key: 2-2-50:101

This is to inform you that the subject application has been reviewed by all of the concerned agencies, and the following are our findings:

1. The subject property is served by an acceptable street.
2. The application can meet with the State Department of Health wastewater treatment and disposal systems requirements.
3. You have proven to our satisfaction that there are no restrictive covenants prohibiting the additional dwelling on the lot.
4. Submitted plans include two off-street parking stalls on the property.

Based on the above, you are hereby granted approval to permit the construction of an Ohana Dwelling, subject to the following condition(s):

- (1) A cesspool may service a maximum of 800 gallons per day of sewage, which is generated from a single or multiple dwelling unit complex, containing a total of only four (4) bedrooms.

Shoichi and Mutsuko Fukaura
Page 2
August 17, 1984

- (2) The building permit for the Ohana Dwelling shall be secured within two (2) years of the date of this Permit. Should you fail to comply with the timetable, this Ohana Dwelling Permit shall be automatically voided.
- (3) This Ohana Dwelling permit is subject to all other applicable rules, regulations and requirements, including but not limited to those of the Planning Department, Department of Public Works, and State Department of Health.

Should you have any questions regarding the above, please feel free to contact either Masa Onuma or William Yamanoa of my staff at 961-8288. Please bring this Permit with you when you apply for a building permit for the Ohana Dwelling.

Sincerely,



for Sidney Fuke
Planning Director

GU:wkm

cc: Department of Health,
Chief Sanitarian
Department of Public Works
Real Property Tax Division

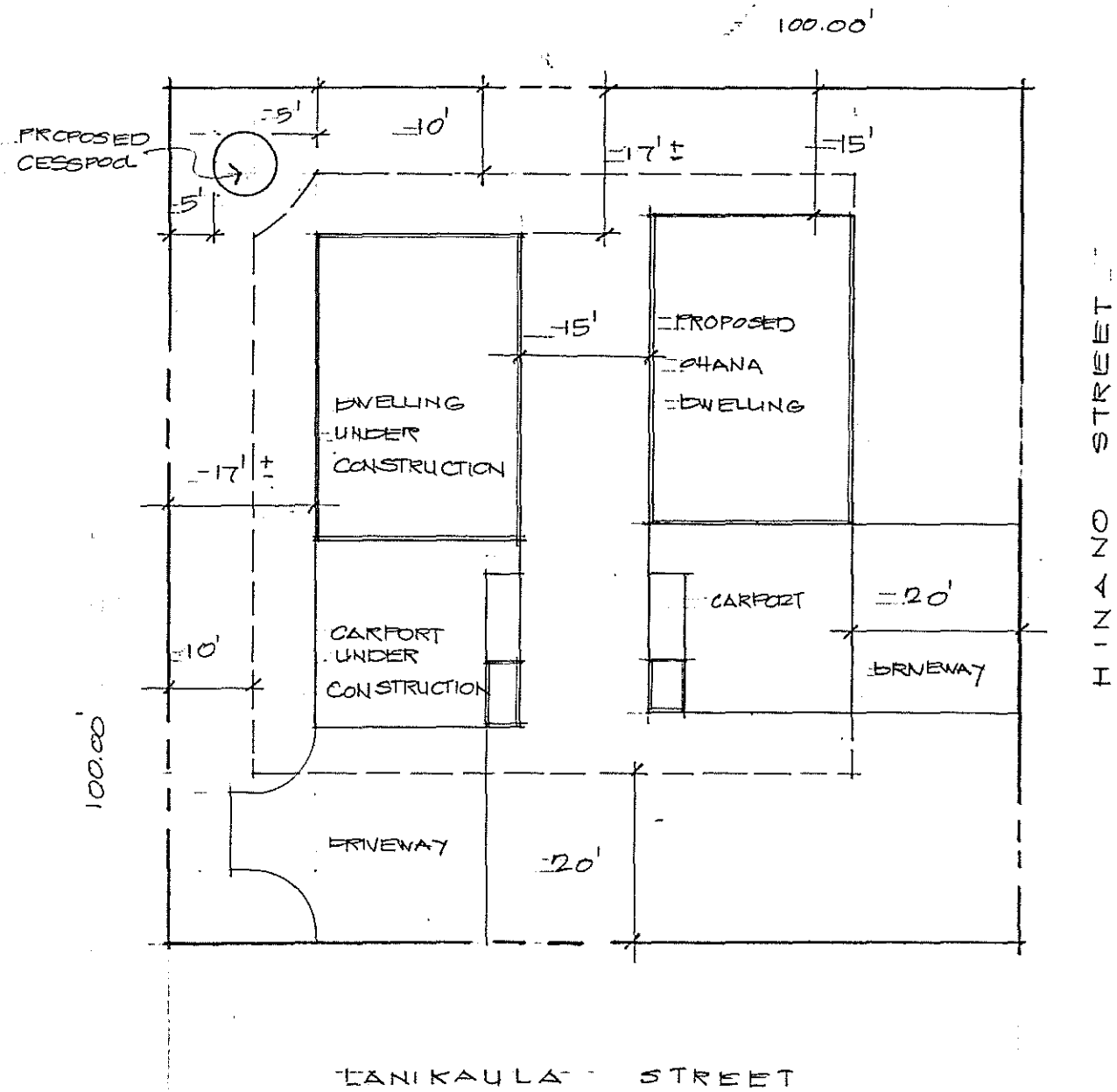

PLANS FOR

MR. & MRS. SHOICHI FUKAURA

SCALE: 1" = 20.00'

TMK.: 2-2-50:101 LOT A-2

AREA: 10,000 SQ. FT.

FOR WAIAKEA HOUSELOTS EXTENSION, 4110, 41.