

May 20, 1986

Mr. Juanito A. Paz
115 Alani Street
Hilo, HI 96720

Dear Mr. Paz:

Ohana Dwelling Permit (OD 86-47)
Tax Map Key: 2-4-47:27, Lot 25

The subject application has been reviewed by the concerned agencies and we find:

1. The subject tax map key parcel is served by an acceptable street;
2. The subject application can meet with the State Department of Health wastewater treatment and disposal systems requirements;
3. The copy of the document(s) relating to the subject tax map key parcel to establish title and exhibits contained therein do not include any deed restriction or covenant to prohibit the construction of the requested ohana dwelling addition; and,
4. The submitted site plan denotes two off-street parking stalls on the property.

In view of the above, by this letter, you are hereby granted permission to construct the Ohana Dwelling, subject to the following condition(s):

- (a) The building permit for the Ohana Dwelling shall be secured within two (2) years of the date of this letter or Permit. If the applicant and/or owner fails to secure a building permit within this period, permission to construct the subject ohana dwelling shall be deemed void. A time extension may be granted for good cause, provided, the permittee and/or owner applies in writing at least forty-five (45) calendar days before the expiration of the two (2) year period.

MAY 21 1986

Mr. Juanito A. Paz
Page 2
May 20, 1986

- (b) Off-street parking space for two vehicles is designated on the submitted site plan to fulfill the Ohana Dwelling parking requirement. Said space may not be employed for storage or other use unless and until approved alternative parking arrangements are established.
- (c) The site plan and/or construction drawings submitted with the building permit shall denote the required two (2) off-street parking spaces.
- (d) The applicant must obtain a Flood Insurance Rate Map determination for the subject property from the Department of Public Works (Engineering and Surveys Division). Building permit submittals for the Ohana Dwelling must comply with established flood regulations. A copy of the Department of Public Works memorandum dated May 15, 1986, is enclosed.
- (e) The ohana dwelling shall conform to all requirements of codes and statutes pertaining to building construction.
- (f) This Ohana Dwelling permit is subject to all other applicable rules, regulations and requirements, including but not limited to those of the Planning Department, Department of Public Works, and State Department of Health.

Please bring or attach a copy of this Permit to expedite processing the building plans and building permit application to construct the ohana dwelling. Should you have any questions regarding the above, please feel free to contact either Masa Onuma or William Yamanoha of my staff at 961-8288.

Sincerely,

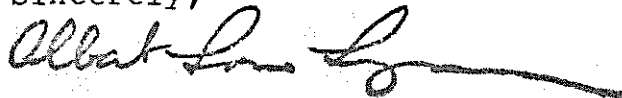

ALBERT LONO LYMAN
Planning Director

WRY:wkm

Encl.

cc: Department of Health,
Chief Sanitarian
Department of Public Works
Real Property Tax Division

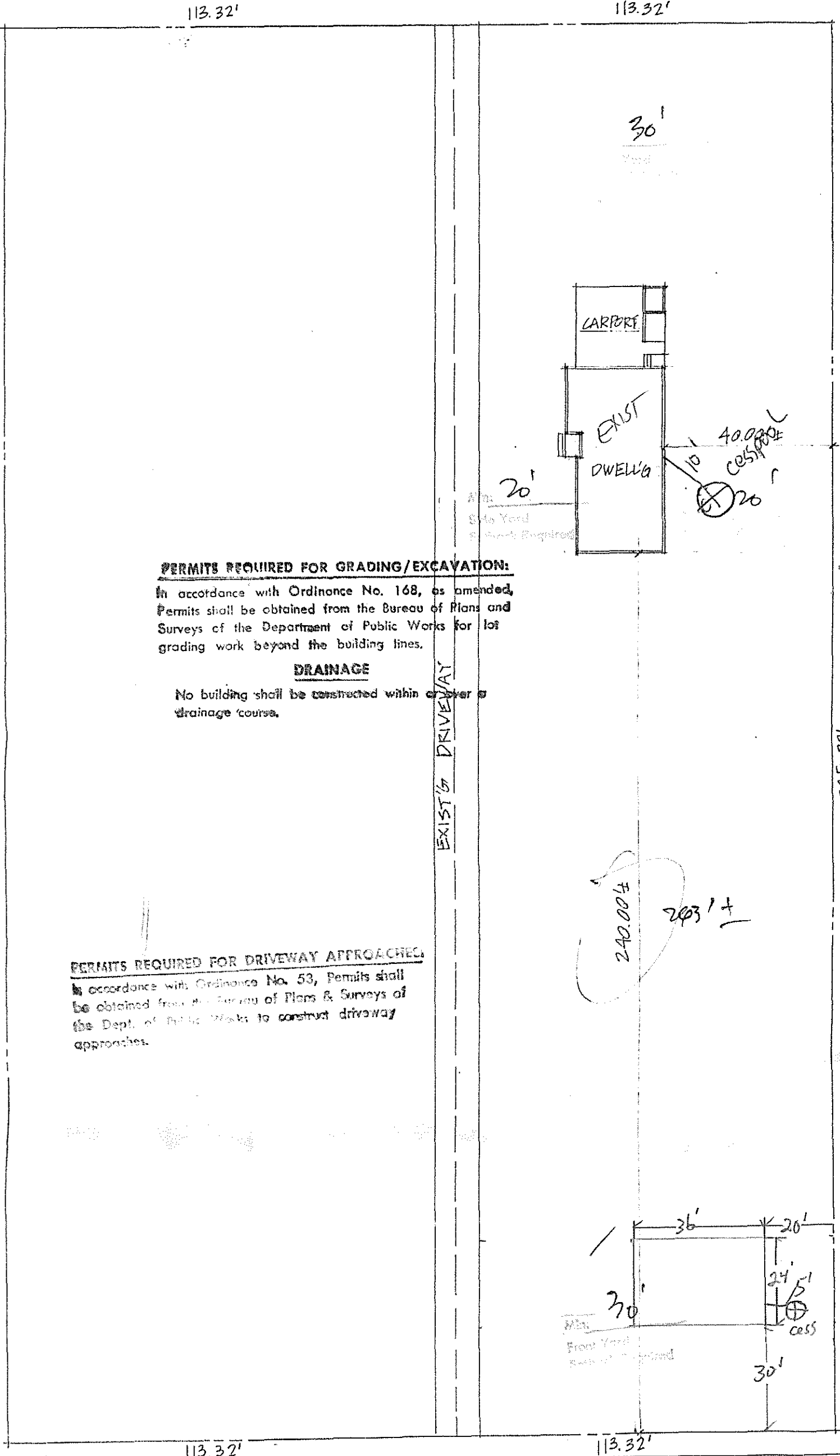

PERMITS REQUIRED FOR GRADING/EXCAVATION:

In accordance with Ordinance No. 168, as amended, Permits shall be obtained from the Bureau of Plans and Surveys of the Department of Public Works for lot grading work beyond the building lines.

DRAINAGE

No building shall be constructed within or over a drainage course.

PERMITS REQUIRED FOR DRIVEWAY APPROACHES:

In accordance with Ordinance No. 53, Permits shall be obtained from the Bureau of Plans & Surveys of the Dept. of Public Works to construct driveway approaches.

385.00'

385.00'

EXIST'G DRIVEWAY

40 FT. ROAD

PLOT PLAN
 20: 1" = 30.00'

APPROVED:
[Signature]
 Planning Department
 11/19/82