

May 30, 1986

Mr. Donald F. Watson  
P. O. Box 123  
Hawi, Hawaii 96719

Dear Mr. Watson:

Ohana Dwelling Permit (OD 86-50)  
Tax Map Key: 5-5-02:58, Lot 9

The subject application has been reviewed by the concerned agencies and we find:

1. The subject tax map key parcel is served by an acceptable street;
2. The subject application can meet with the State Department of Health wastewater treatment and disposal systems requirements;
3. The copy of the document(s) relating to the subject tax map key parcel to establish title and exhibits contained therein do not include any deed restriction or covenant to prohibit the construction of the requested ohana dwelling addition; and,
4. The submitted site plan denotes two off-street parking stalls on the property.

In view of the above, by this letter, you are hereby granted permission to construct the Ohana Dwelling, subject to the following condition(s):

- (a) The building permit for the Ohana Dwelling shall be secured within two (2) years of the date of this letter or Permit. If the applicant and/or owner fails to secure a building permit within this period, permission to construct the subject ohana dwelling shall be deemed void. A time extension may be granted for good cause, provided, the permittee and/or owner applies in writing at least forty-five (45) calendar days before the expiration of the two (2) year period.

Mr. Donald F. Watson

Page 2

May 30, 1986

- (b) Off-street parking space for two vehicles is designated on the submitted site plan to fulfill the Ohana Dwelling parking requirement. Said space may not be employed for storage or other use unless and until approved alternative parking arrangements are established.
- (c) The site plan and/or construction drawings submitted with the building permit shall denote the required two (2) off-street parking spaces.
- (d) The ohana dwelling shall conform to all requirements of codes and statutes pertaining to building construction.
- (e) This Ohana Dwelling permit is subject to all other applicable rules, regulations and requirements, including but not limited to those of the Planning Department, Department of Public Works, and State Department of Health.

Please bring or attach a copy of this permit to expedite processing the building plans and building permit application to construct the ohana dwelling. Should you have any questions regarding the above, please feel free to contact either Masa Onuma or William Yamanoha of my staff at 961-8288.

Sincerely,



for ALBERT LONO LYMAN  
Planning Director

WRY:wkm

cc: Department of Health,  
Chief Sanitarian  
Department of Public Works  
Real Property Tax Division

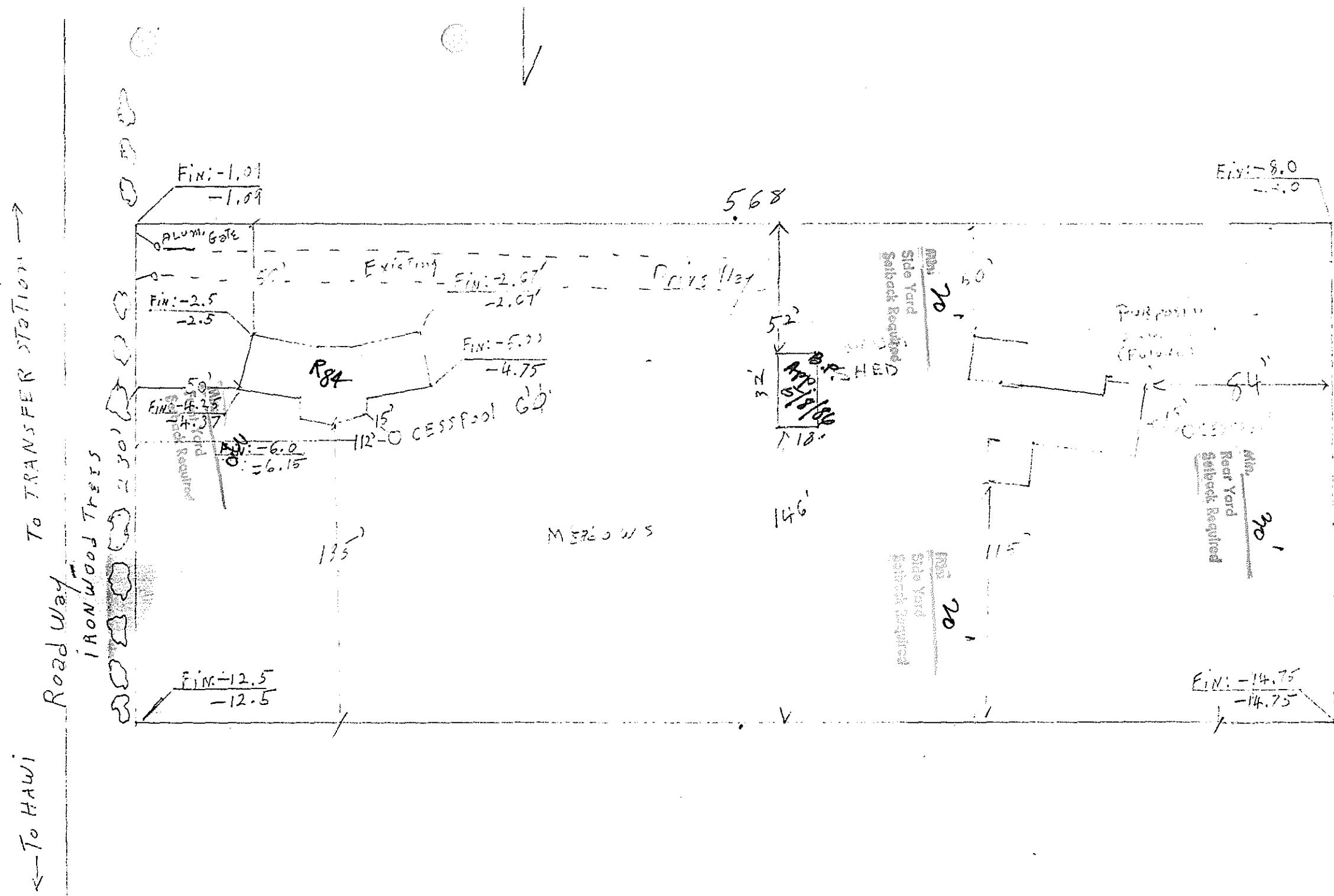

PLOT PLAN  
 SCALE 1" = 5'  
 T.M.K.: 5-5-002-058 (3)  
 2.97 ACRES

10/15/01 5:00 PM  
 10/15/01 5:00 PM  
 10/15/01 5:00 PM