

February 24, 1987

Mr. and Mrs. Wilbur Carlson  
P. O. Box 1351  
Keaau, HI 96749

Dear Mr. Carlson:

Ohana Dwelling Permit (OD 87-15)  
Tax Map Key: 1-5-57:38, Lot 58

The subject application has been reviewed by the concerned agencies and we find:

1. The subject tax map key parcel is served by an acceptable street;
2. The subject application can meet with the State Department of Health wastewater treatment and disposal systems requirements;
3. The copy of the document(s) relating to the subject tax map key parcel to establish title and exhibits contained therein do not include any deed restriction or covenant to prohibit the construction of the requested ohana dwelling addition; and,
4. The submitted site plan denotes two off-street parking stalls on the property.

In view of the above, by this letter, you are hereby granted permission to construct the Ohana Dwelling, subject to the following condition(s):

- (a) The building permit for the Ohana Dwelling shall be secured within two (2) years of the date of this letter or Permit. If the applicant and/or owner fails to secure a building permit within this period, permission to construct the subject ohana dwelling shall be deemed void. A time extension may be granted for good cause, provided, the permittee and/or owner applies in writing at least forty-five (45) calendar days before the expiration of the two (2) year period.

FEB 25 1987

Mr. and Mrs. Wilbur Carlson  
Page 2  
February 24, 1987

- (b) Off-street parking space for two vehicles is designated on the submitted site plan to fulfill the Ohana Dwelling parking requirement. Said space may not be employed for storage or other use unless and until approved alternative parking arrangements are established.
- (c) The site plan and/or construction drawings submitted with the building permit shall denote the required two (2) off-street parking spaces.
- (d) The ohana dwelling shall conform to all requirements of codes and statutes pertaining to building construction.
- (e) The applicant shall conform to State Department of Health standards and regulations specified by their comments dated February 17, 1987, which states:  
  
"An individual wastewater system may service a maximum of 800 gallons per day of sewage, which is generated from a single or multiple dwelling unit complex, containing a total of only four (4) bedrooms."
- (f) This Ohana Dwelling permit is subject to all other applicable rules, regulations and requirements, including but not limited to those of the Planning Department, Department of Public Works, and State Department of Health.

Please bring or attach a copy of this Permit to expedite processing the building plans and building permit application to construct the ohana dwelling. Should you have any questions regarding the above, please feel free to contact either Masa Onuma or William Yamanoha of my staff at 961-8288.

Sincerely,



ALBERT LONO LYMAN  
Planning Director

WRY:wk

cc: Department of Health,  
Chief Sanitarian  
Department of Public Works  
Real Property Tax Division

Carlson

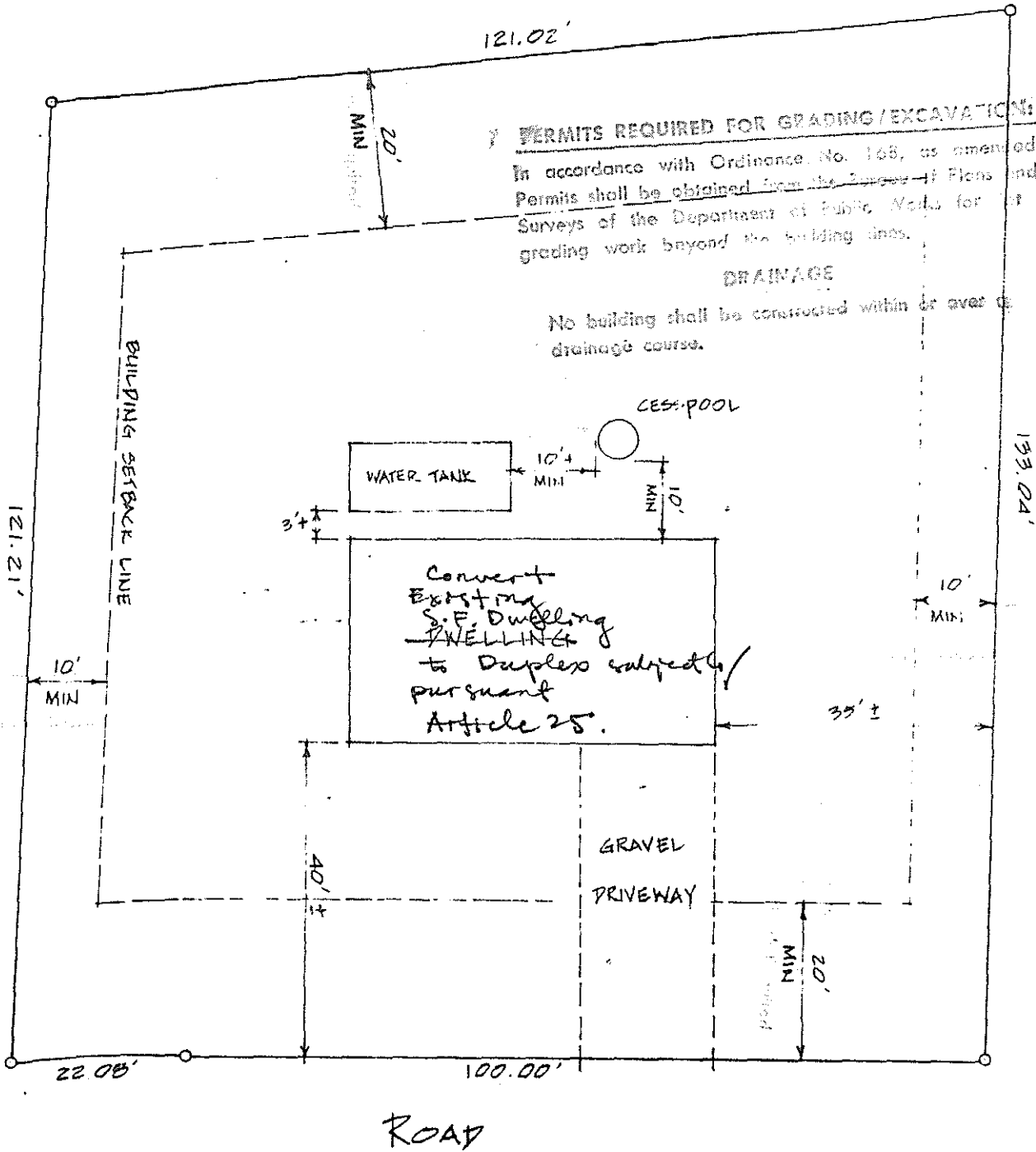

**APPROVED:**  
 [Signature]  
 Director, County Planning Department  
 Date: 6/9/81

**PLOT PLAN**

SCALE: 1" = 20'-0"  
 TMK: 1-5-57:30 LOT: 5B  
 HAWAIIAN PARADISE PARK, PUNA

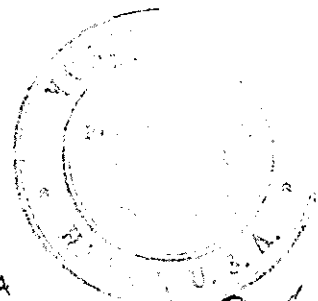

[Signature]  
 [Signature]