

June 10, 1987

Ms. Penelope C. Blair  
P.O. Box 836  
Volcano, HI 96785

Dear Ms. Blair:

Ohana Dwelling Permit (OD 87-77)  
Tax Map Key 1-1-23:49 & 52 Consol.

The subject application has been reviewed by the concerned agencies and note:

1. The subject tax map key parcel is served by an acceptable street;
2. The subject application can meet with the State Department of Health wastewater treatment and disposal systems requirements;
3. The copy of the document(s) relating to the subject tax map key parcel to establish title and exhibits contained therein do not include any deed restriction or covenant to prohibit the construction of the requested ohana dwelling addition; and,
4. The submitted revised site plan received May 27, 1987, denotes two off-street parking stalls on the property.

In view of the above, by this letter, you are hereby granted permission to construct the Ohana Dwelling, subject to the following condition(s):

- (a) The building permit for the Ohana Dwelling duplex shall be secured within two (2) years of the date of this letter or Permit. If the applicant and/or owner fails to secure a building permit within this period, permission to construct the subject ohana dwelling shall be deemed void. A time extension may be granted for good cause, provided, the permittee and/or owner applies in writing at least forty-five (45) calendar days before the expiration of the two (2) year period.

JUN 12 1987

Mr. Penelope C. Blair  
Page 2  
June 10, 1987

- (b) Off-street parking space for two vehicles is designated on the submitted revised site plan to fulfill the Ohana Dwelling parking requirement. Said space may not be employed for storage or other use unless and until approved alternative parking arrangements are established.
- (c) The revised site plan and/or construction drawings submitted with the building permit shall denote the required two (2) off-street parking spaces.
- (d) The ohana dwelling shall conform to all requirements of codes and statutes pertaining to building construction.
- (e) This Ohana Dwelling permit is subject to all other applicable rules, regulations and requirements, including but not limited to those of the Planning Department, Department of Public Works, and State Department of Health.

Please bring or attach a copy of this Permit to expedite processing the building plans and building permit application to construct the ohana dwelling. Should you have any questions regarding the above, please feel free to contact either Masa Onuma or William Yamanoha of my staff at 961-8288.

Sincerely,



ALBERT LONO LYMAN  
Planning Director

WRY:lv

cc: Department of Health,  
Chief Sanitarian w/copy of revised site plan  
Department of Public Works w/copy of revised site plan  
Real Property Tax Division

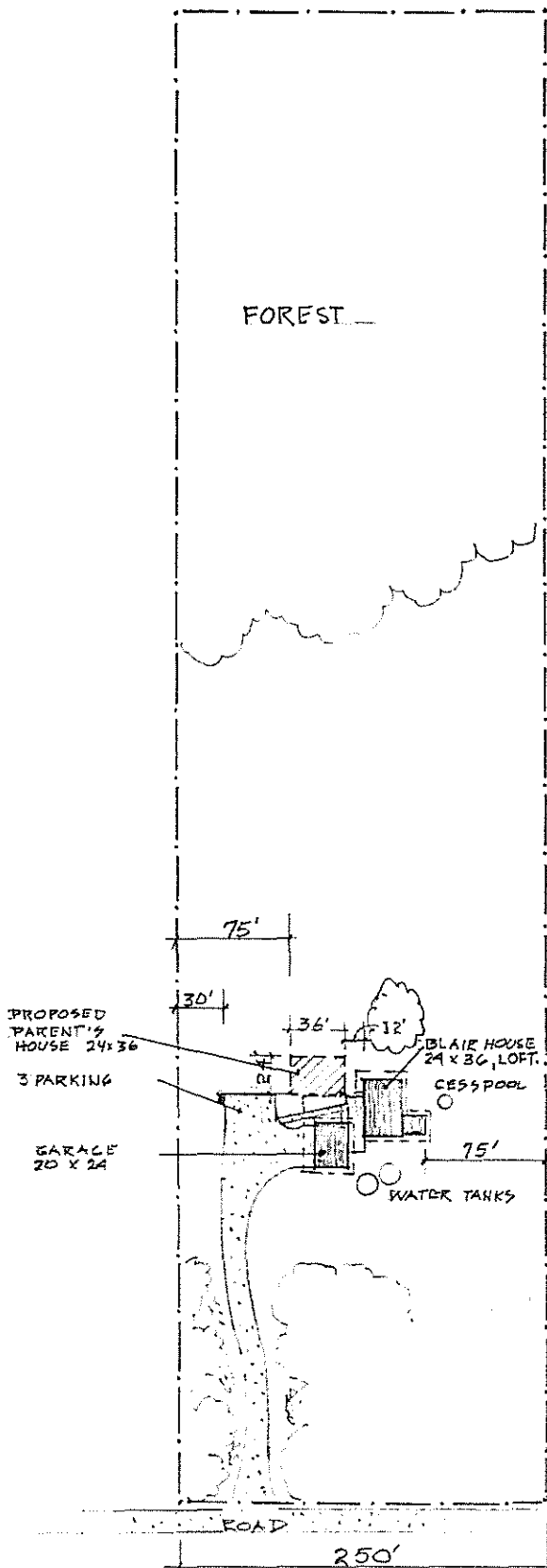

1045.4'

6/1/87

Per Ms Carol Blair  
 Homes to be  
 connected w/  
 covered walkway.  
 2 B.R. total.  
 Harold

PENELOPE BLAIR  
 TMK 1-1-23, LOTS 49, 52  
 CONSOLIDATED - GAC.  
 FERN FOREST, PUNA, HI,

PREPARED BY VIRGINIA MACDONALD, AIA