

August 7, 1987

Ms. Laura C. Beckvold
P.O. Box 1785
Kamuela, HI 96743

Dear Ms. Beckvold:

Ohana Dwelling Permit (OD 87-112)
Tax Map Key : 6-9-06:37, Lot 150

The subject application has been reviewed by the concerned agencies and note:

1. The subject tax map key parcel is served by an acceptable street;
2. The subject application can meet with the State Department of Health wastewater treatment and disposal systems requirements;
3. The copy of document(s) received relating to subject tax map key parcel to establish title and exhibits contained therein do not include any deed restriction or covenant to prohibit construction of requested ohana dwelling; and,
4. The revised site plan denotes four (4) off-street parking stalls on the property.

In view of the above, by this letter, you are hereby granted permission to construct the Ohana Dwelling subject to the following condition(s):

- (a) The building permit for the Ohana Dwelling shall be secured on or before August 7, 1989. If the applicant and/or owner fails to secure a building permit within two (2) years of the date of this letter, permission to construct the subject ohana dwelling shall be deemed void. A time extension may be granted for good cause, provided, the permittee and/or owner applies in writing at least forty-five (45) calendar days before the expiration of the two (2) year period.

AUG 10 1987

2861 01 001

Ms. Laura C. Beckvold
Page 2
August 7, 1987

- (b) Off-street parking space for two vehicles is designated on the submitted site plan to fulfill the off-street parking requirement. The off-street parking spaces may not be employed for storage or other use unless and until approved alternative on-site parking arrangements are established.
- (c) All construction drawings together with approved site plan drawn to scale submitted with the ohana dwelling building permit application shall denote location and identify required two (2) off-street parking spaces.
- (d) The subject parcel is located in Flood Zone A4, as designated by the Flood Insurance Rate Map (FIRM), dated May 3, 1982. A copy of July 24, 1987 Department of Public Works memorandum is enclosed for your file.
- (e) The ohana dwelling shall conform to all requirements of codes and statutes pertaining to building construction.
- (f) The applicant shall conform to State Department of Health standards and regulations and following comment(s) dated July 24, 1987:

"Each single family residence needs to be serviced by a separate cesspool."
- (g) This Ohana Dwelling permit is subject to all other applicable rules, regulations and requirements, including but not limited to those of the Planning Department, Department of Public Works, and State Department of Health.

Please bring or attach a copy of this Permit to expedite processing the building plans and building permit application to construct the ohana dwelling. Should you have any questions regarding the above, please feel free to contact either Masa Onuma or William Yamanoha of my staff at 861-8288.

Sincerely,



ALBERT LONG LYMAN
Planning Director

NRV:etn
Enc.

cc: Department of Health,
Chief Sanitarian
Department of Public Works
Real Property Tax Division

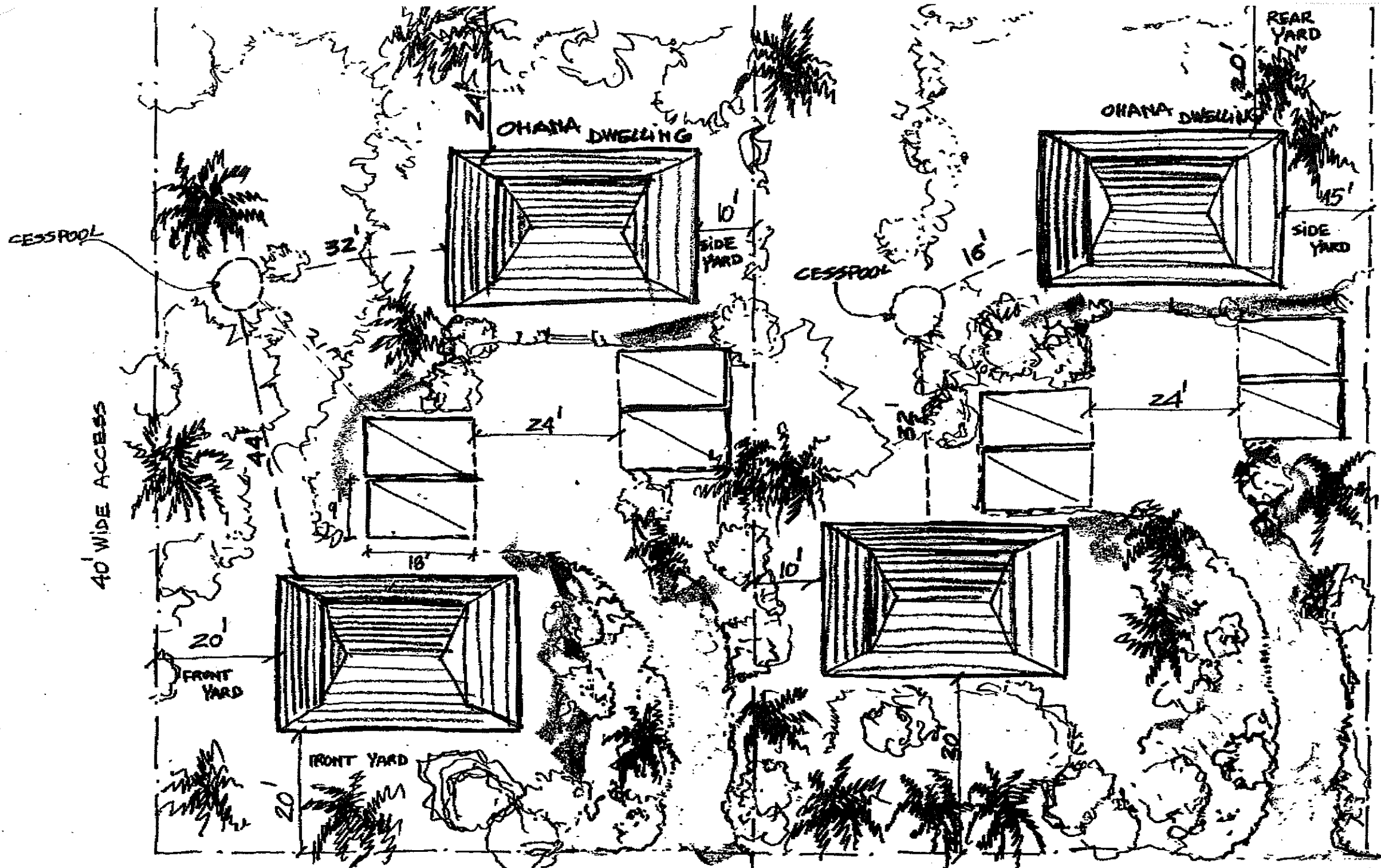

scale:
 $\frac{1}{16}'' = 1'-0''$

LOT 150
 TAX MAP KEY 6-9-06:37

LOT 151
 TAX MAP KEY 6-9-06:38

Pfueger Architects