

November 4, 1987

Mr. and Mrs. Hadley H Huiitt
Box SR 11031
Keeau, Hawaii 96749

Dear Mr. and Mrs. Hadley:

Ohana Dwelling Permit (OD 87-157)
Tax Map Key: 1-5-21:92, Lot 1425

The subject application has been reviewed by the concerned agencies and notes:

1. The subject tax map key parcel is served by an acceptable street;
2. The subject application can meet with the State Department of Health wastewater treatment and disposal systems requirements;
3. The copy of document(s) received relating to subject tax map key parcel to establish title and exhibits contained therein do not include any deed restriction or covenant to prohibit construction of requested ohana dwelling; and,
4. The submitted site plan denotes two off-street parking stalls on the property.

In view of the above, by this letter, you are hereby granted permission to construct the Ohana Dwelling subject to the following condition(s):

- (a) The building permit for the Ohana Dwelling shall be secured on or before November 4, 1989. If the applicant and/or owner fails to secure a building permit within two (2) years of the date of this letter, permission to construct the subject ohana dwelling shall be deemed void. A time extension may be granted for good cause, provided, the permittee and/or owner applies in writing at least forty-five (45) calendar days before the expiration of the two (2) year period.

NOV 04 1987

Mr. and Mrs. Hadley H Huitt

Page 2

November 4, 1987

- (b) Off-street parking space for two vehicles is designated on the submitted site plan to fulfill the off-street parking requirement. The off-street parking spaces may not be employed for storage or other use unless and until approved alternative on-site parking arrangements are established.
- (c) All construction drawings together with approved site plan drawn to scale submitted with the ohana dwelling building permit application shall denote location and identify required two (2) off-street parking spaces.
- (d) The ohana dwelling shall conform to all requirements of codes and statutes pertaining to building construction.
- (e) This Ohana Dwelling permit is subject to all other applicable rules, regulations and requirements, including but not limited to those of the Planning Department, Department of Public Works, and State Department of Health.

Please bring or attach a copy of this Permit to expedite processing the building plans and building permit application to construct the ohana dwelling. Should you have any questions regarding the above, please feel free to contact either Mass Onuma or William Yamanoha of my staff at 961-8288.

Sincerely,

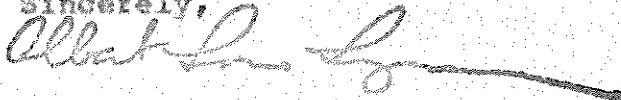

ALBERT LONO LYMAN
Planning Director

WRY:etn

cc: Department of Health,
Chief Sanitarian
Department of Public Works
Real Property Tax Division

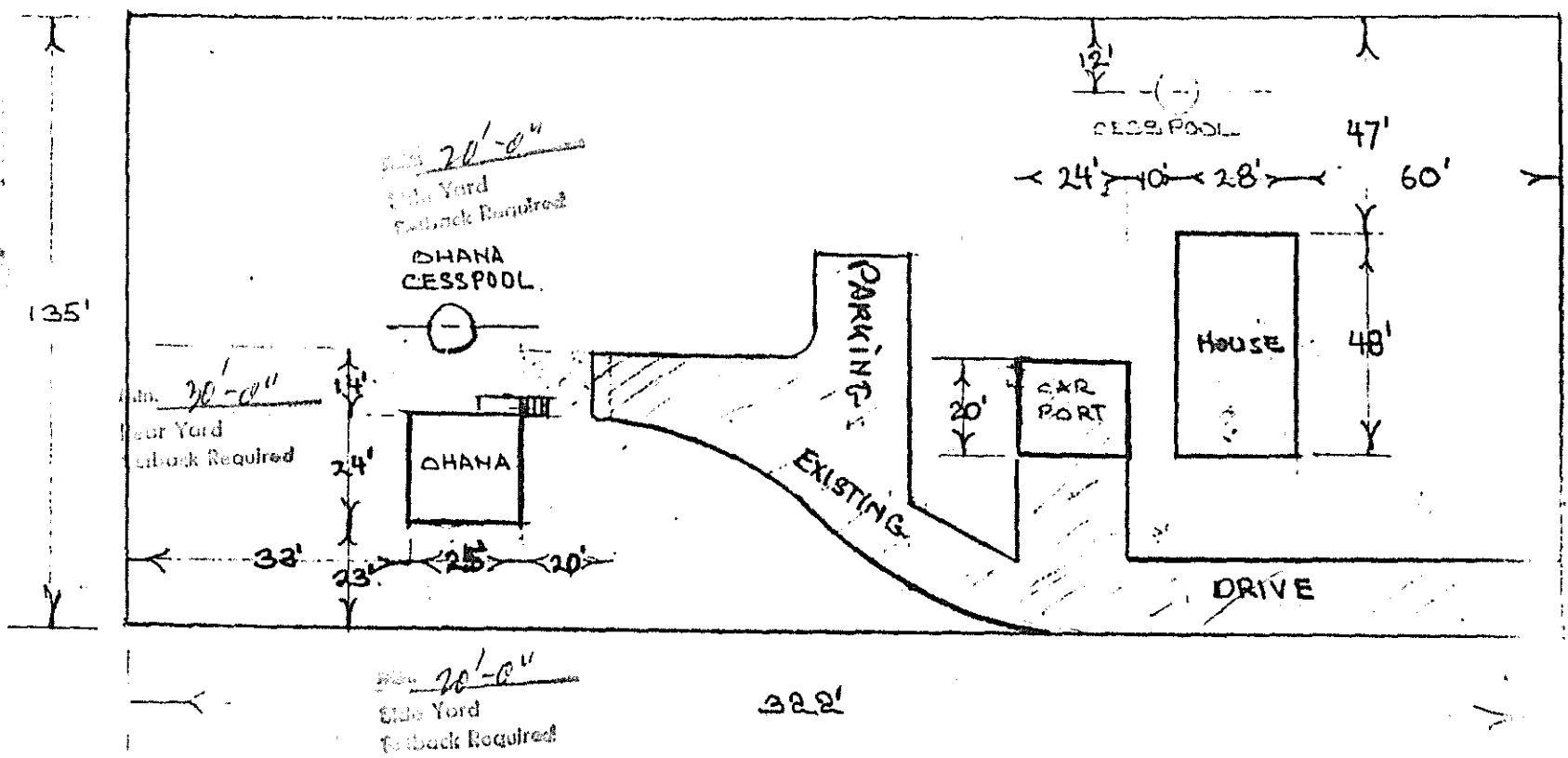

APPROVED:
[Signature]
 Director, County Planning Department
 Date: 1/7/54

This set of approved plans and specifications shall be kept on job site at all times during construction.

SCALE 1/4" = 10'

PLOT PLAN
 OHANA DWELLING
 MR AND MRS H. H. HUITT
 BLOCK 8 LOT 1425
 TAX MAP KEY 1-5-21-92

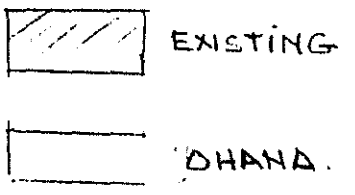

Date _____ 19____
 APPROVED _____
 BUILDING DIVISION CHIEF