

August 17, 1989

Mr. Brian McCourt
72-3984 Kamaheha Hwy.
Kailua-Kona, HI 96740

Dear Mr. McCourt:

Ohana Dwelling Permit (OD 89-172)
Tax Map Key: 7-2-08:33, Lot 1

The subject application has been reviewed by the concerned agencies and note:

1. The subject tax map key parcel is served by an acceptable street;
2. The subject application can meet with the State Department of Health wastewater treatment and disposal systems requirements;
3. The copy of document(s) received relating to subject tax map key parcel to establish title and exhibits contained therein do not include any deed restriction or covenant to prohibit construction of requested ohana dwelling; and,
4. The submitted revised site plan denotes two off-street parking stalls on the property.

In view of the above, by this letter, you are hereby granted permission to construct the Ohana Dwelling (DUPLEX CONVERSION) subject to the following condition(s):

- (a) The building permit for the Ohana Dwelling shall be secured on or before August 17, 1991. If the applicant and/or owner fails to secure a building permit within two (2) years of the date of this letter, permission to construct the subject ohana dwelling shall be deemed void. A time extension may be granted for good cause, provided, the permittee and/or owner applies in writing at least forty-five (45) calendar days before the expiration of the two (2) year period.
- (b) Off-street parking space for two vehicles is designated on the submitted revised site plan to fulfill the off-street parking requirement. The off-street parking spaces may not be employed for storage or other use unless and until

AUG 21 1989

Mr. Brian McCourt
Page 2
August 17, 1989

approved alternative on-site parking arrangements are established.

- (c) All construction drawings together with approved revised site plan drawn to scale submitted with the ohana dwelling building permit application shall denote location and identify required two (2) off-street parking spaces.
- (d) The ohana dwelling shall conform to all requirements of codes and statutes pertaining to access and building construction.
- (e) The applicant shall conform to State Department of Health standards and regulations and following comment(s) dated June 2, 1989:

"An individual wastewater system may service a maximum of 800 gallons per day of sewage, which is generated from a single or multiple dwelling unit complex, containing a total of only four (4) bedrooms.

The minimum setback requirements for coespools, as per Administrative Rules 11-52, must be met."

- (f) Complete and return Cancellation of Agreement together with appropriate filing fee prior to submission of the building permit application for the duplex conversion.
- (g) This Ohana Dwelling permit is subject to all other applicable rules, regulations and requirements, including but not limited to those of the Planning Department, Department of Public Works, and State Department of Health.

Please bring or attach a copy of this Permit to expedite processing the building plans and building permit application to construct the ohana dwelling. Should you have any questions regarding the above, please feel free to contact either Hase Onusa or William Yamacha of my staff at 951-8288.

Sincerely,

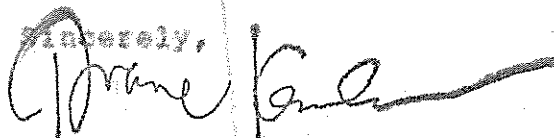

DUANE KANUHA
Planning Director

WRV:etn
cc: Department of Health,
Chief Sanitarian
Department of Public Works
Real Property Tax Division
bcc: RHY/EML

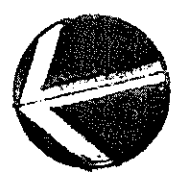
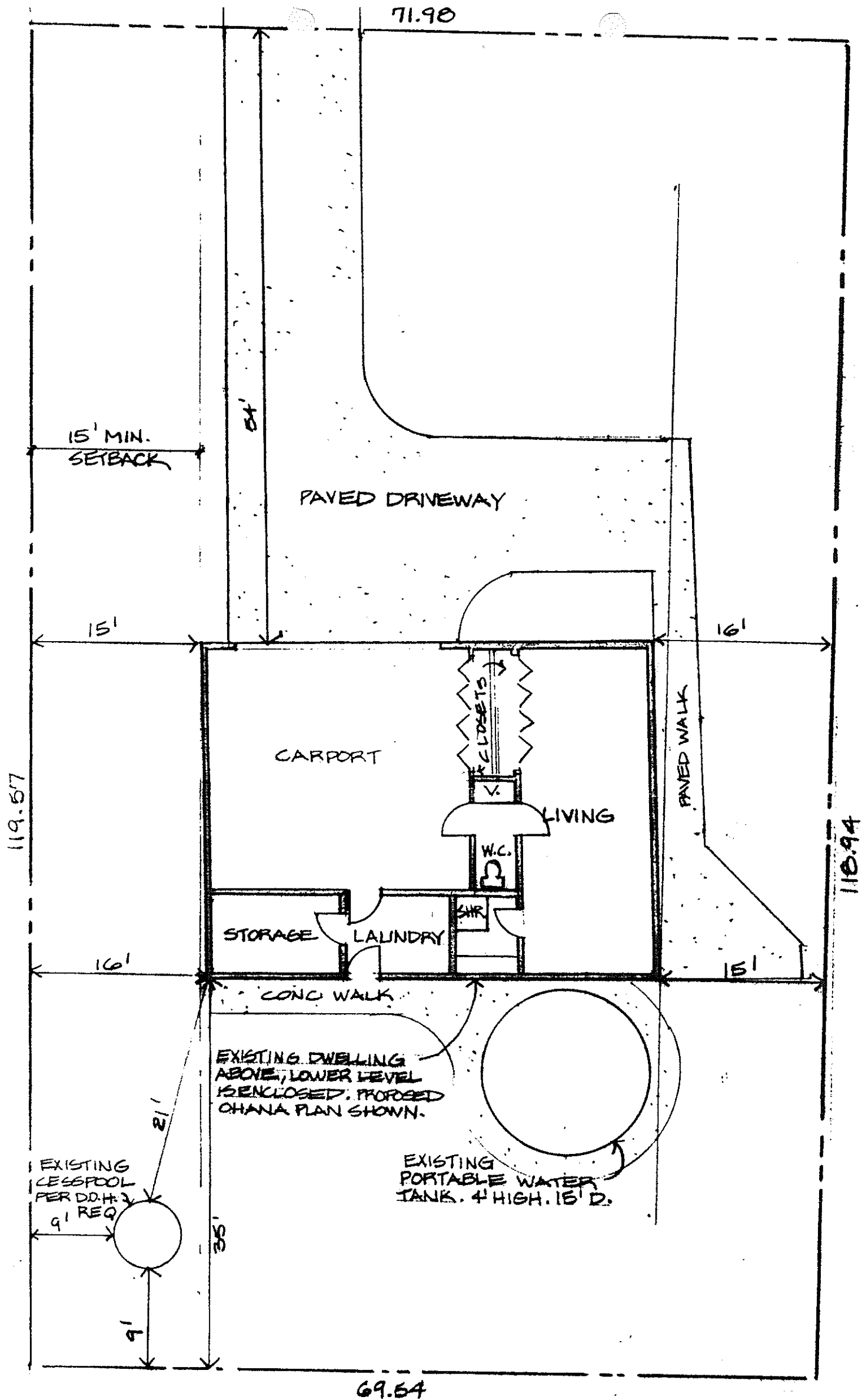

REVISED PLOT PLAN
 Showing Ohana Unit
 TMK 3/7-2-8-33 Brian McCourt

SCALE 1"=10'0"