

August 25, 1989

Mr. Orville L. Mathison  
P.O. Box 745  
Volcano, HI 96785

Dear Mr. Mathison:

Ohana Dwelling Permit (OD 89-222)  
Tax Map Key: 1-1-07:100, Lot 185

The subject application has been reviewed by the concerned agencies and note:

1. The subject tax map key parcel is served by an acceptable street;
2. The subject application can meet with the State Department of Health wastewater treatment and disposal systems requirements;
3. The copy of document(s) received June 20, July 18, and August 22, 1989 relating to subject tax map key parcel to establish title and exhibits contained therein do not include any deed restriction or covenant to prohibit construction of requested ohana dwelling; and,
4. The submitted site plan denotes two off-street parking stalls on the property.

In view of the above, by this letter, you are hereby granted permission to construct the Ohana Dwelling subject to the following condition(s):

- (a) The building permit for the Ohana Dwelling shall be secured on or before August 25, 1991. If the applicant and/or owner fails to secure a building permit within two (2) years of the date of this letter, permission to construct the subject ohana dwelling shall be deemed void. A time extension may be granted for good cause, provided, the permittee and/or owner applies in writing at least forty-five (45) calendar days before the expiration of the two (2) year period.

AUG 29 1989

Mr. Orville L. Mathison  
Page 2  
August 25, 1989

- (b) Off-street parking space for two vehicles is designated on the submitted site plan to fulfill the off-street parking requirement. The off-street parking spaces may not be employed for storage or other use unless and until approved alternative on-site parking arrangements are established.
- (c) All construction drawings together with approved site plan drawn to scale submitted with the ohana dwelling building permit application shall denote location and identify required two (2) off-street parking spaces.
- (d) The ohana dwelling shall conform to all requirements of codes and statutes pertaining to access and building construction.
- (e) The applicant shall conform to State Department of Health standards and regulations and following comment(s) dated July 18, 1989:  
  
"Per Administrative Rule, Title 11, Chapter 62, Wastewater, a single individual wastewater system (IWS) may receive no more than 800 gallons of sewage per day based on 200 gallons per bedroom per day. This limits discharge into a single IWS to four bedrooms. Developments which exceed four bedrooms must install a additional IWS."
- (f) This Ohana Dwelling permit is subject to all other applicable rules, regulations and requirements, including but not limited to those of the Planning Department, Department of Public Works, and State Department of Health.

Please bring or attach a copy of this Permit to expedite processing the building plans and building permit application to construct the ohana dwelling. Should you have any questions regarding the above, please feel free to contact either Masa Onuma or William Yamanoha of my staff at 961-8288.

Sincerely,

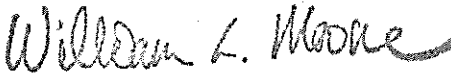
  
for DUANE KANUHA  
Planning Director

WRY:etn  
cc: Department of Health,  
Chief Sanitarian  
Department of Public Works  
Real Property Tax Division

July 26, 1989

Mr. Orville L. Mathison  
P.O. Box 745  
Volcano, HI 96785

Dear Mr. Mathison:

Ohana Dwelling Application (OD 89-222)  
Orville L. Mathison  
TMK: 1-1-07:100, Lot 186

The copy of Warranty Deed dated March 8, 1989 submitted with July 14, 1989 letter is not acceptable.

Please submit copy of recorded Warranty Deed dated March 8, 1989 for review and record.

Should you have any questions, please feel free to contact this office.

Sincerely,

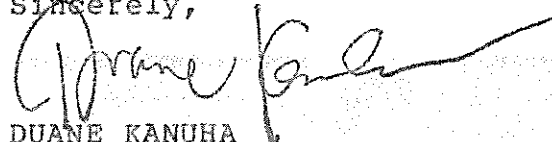

DUANE KANUHA  
Planning Director

WRY:etn

JUL 27 1989

S I T E P L A N

PROPOSED OHANA DWELLING

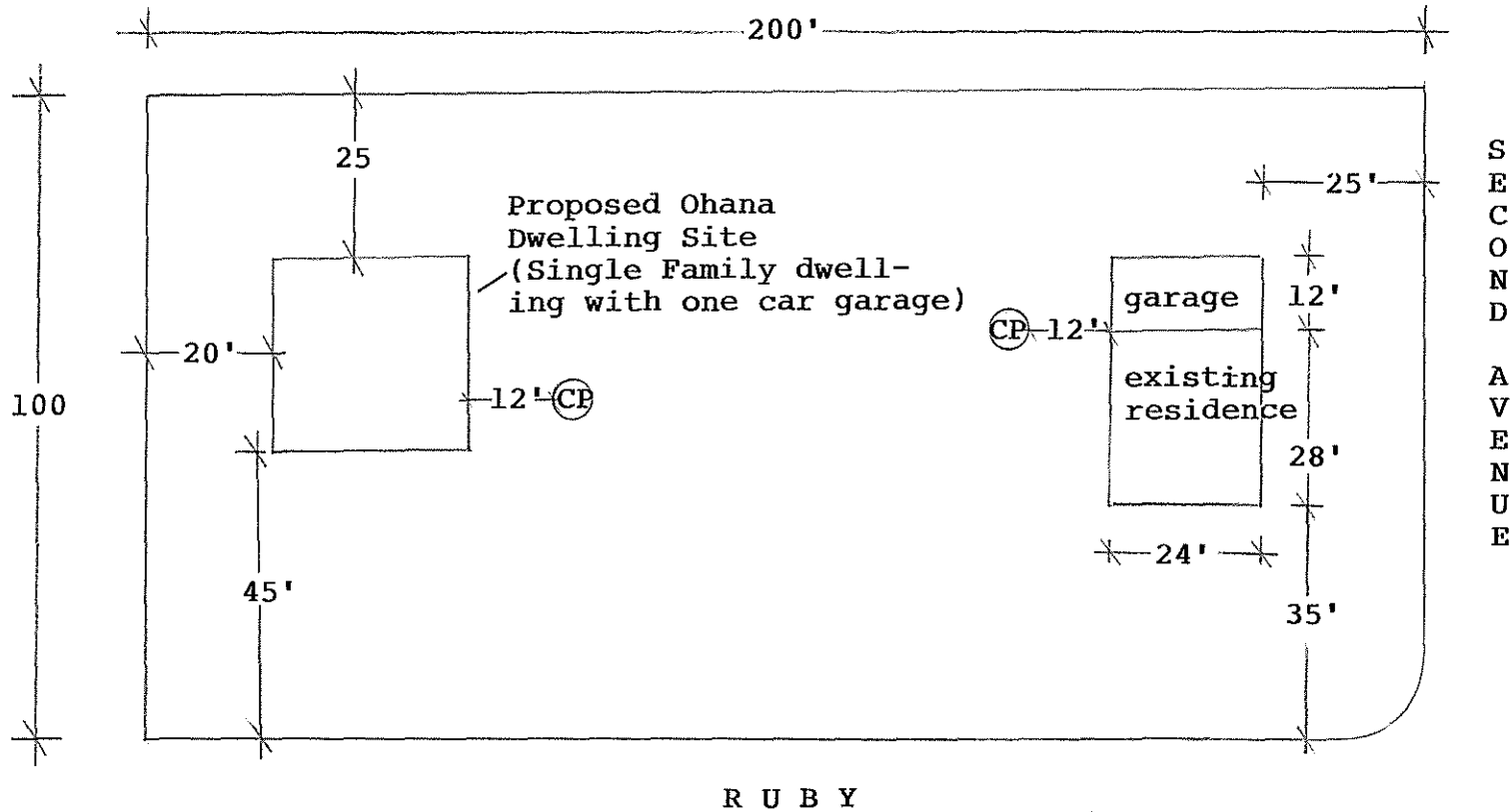

R U B Y

S  
E  
C  
O  
N  
D  
  
A  
V  
E  
N  
U  
E

BUILDING PERMIT NO.: Not Issued  
OWNER : Orville Mathison  
P.O. Box 745  
Volcano, HI 96785  
LOCATION : Second & Ruby  
TAX MAP KEY : 1-1-7: 100  
CONTRACTOR : Owner

Scale 30°=1'