

September 1, 1989

Z.K. Wung, Inc.  
c/o Management Realty, Inc.  
P.O. Box 4908  
Hilo, Hawaii 96720

Gentlemen:

Ohana Dwelling Permit (OD 89-285)  
Tax Map Key: 2-2-35:42, Lot 2

The subject application has been reviewed by the concerned agencies and note:

1. The subject tax map key parcel is served by an acceptable street and ten (10) foot wide road widening setback;
2. The subject application can meet with the State Department of Health wastewater treatment and disposal systems requirements;
3. The copy of document(s) received relating to subject tax map key parcel to establish title and exhibits contained therein do not include any deed restriction or covenant to prohibit construction of requested ohana dwelling; and,
4. The submitted revised site plan received August 9, 1989 denotes two off-street parking stalls on the property.

In view of the above, by this letter, you are hereby granted permission to construct the Ohana Dwelling (NEW DUPLEX) subject to the following condition(s):

- (a) The building permit for the Ohana Dwelling shall be secured on or before September 1, 1991. If the applicant and/or owner fails to secure a building permit within two (2) years of the date of this letter, permission to construct the subject ohana dwelling shall be deemed void. A time extension may be granted for good cause, provided, the permittee and/or owner applies in writing at least forty-five (45) calendar days before the expiration of the two (2) year period.
- (b) Off-street parking space for two vehicles is designated on the submitted site plan to fulfill the off-street parking requirement. The off-street parking spaces may not be

E.K. Wang, Inc.  
Page 2  
September 1, 1989

employed for storage or other use unless and until approved alternative on-site parking arrangements are established.

- (c) All construction drawings together with approved site plan drawn to scale submitted with the ohana dwelling building permit application shall denote location and identify required two (2) off-street parking spaces.
- (d1) The ohana dwelling shall conform to all requirements of codes and statutes pertaining to access and building construction.
- (d2) Access to proposed duplex shall be from Laukapa Street. Please contact the Department of Public Works, Engineering Division for appropriate driveway location.
- (e) The applicant shall conform to State Department of Health standards and regulations and following comment(s) dated August 15, 1989:

"All wastewater generated by a building(s) located within or near proximity of an available public sewer as determined by the Director, shall connect to the public sewer. Administrative Rules, Title 11, Chapter 62, Wastewater."

- (f) This Ohana Dwelling permit is subject to all other applicable rules, regulations and requirements, including but not limited to those of the Planning Department, Department of Public Works, and State Department of Health.

Please bring or attach a copy of this Permit to expedite processing the building plans and building permit application to construct the ohana dwelling. Should you have any questions regarding the above, please feel free to contact either Masa Oama or William Yamanoha of my staff at 961-8288.

Sincerely,



DUANE KANUHA  
Planning Director

WRY:etn  
cc: Department of Health,  
Chief Sanitarian  
Department of Public Works  
Real Property Tax Division

bcc: OD 85-60

From E.K. Wung, Inc.  
 Revised Site Plan  
 T.M.K. 2-2-36:42  
 8/8/89  
 00 Application

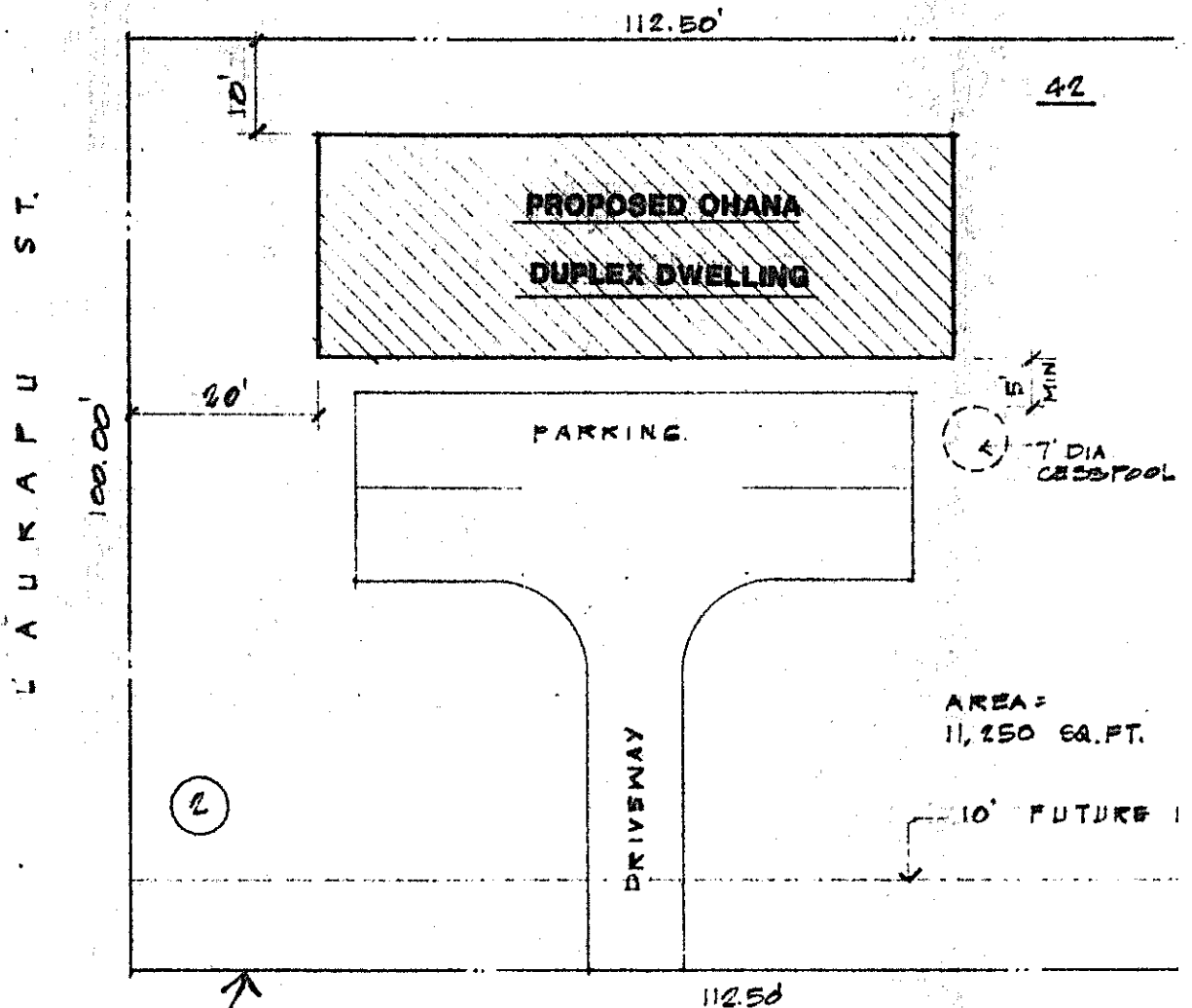

**SITE PLAN 1"=20'**

proposed ohana duplex dwelling for:  
**E. K. WUNG, INC.**

T.M.K.: 2-2-36: 42 LOT NO. 2

T.M.K.: 2-2-36: 111

WAIKEA HOUSE LOTS, 1st SERIES, SOUTH HILLS, HAWAII

Revised Site Plan