

October 5, 1990

Mr. David M. Frenz  
1118 W. Kawaiilani Street  
Hilo, Hawaii 96720

Dear Mr. Frenz:

Ohana Dwelling Permit (OD 90-270)  
Tax Map Key: 2-4-70:4, Lot 721-D

The subject application has been reviewed by the concerned agencies and note:

1. The subject tax map key parcel is served by an acceptable street;
2. The subject application can meet with the State Department of Health wastewater treatment and disposal systems requirements;
3. The copy of document(s) received relating to subject tax map key parcel to establish title and exhibits contained therein do not include any deed restriction or covenant to prohibit construction of requested ohana dwelling; and,
4. The submitted site plan denotes two off-street parking stalls on the property.

In view of the above, by this letter, you are hereby granted permission to construct the Ohana Dwelling subject to the following condition(s):

- (a) The building permit for the Ohana Dwelling shall be secured on or before October 5, 1992. If the applicant and/or owner fails to secure a building permit within two (2) years of the date of this letter, permission to construct the subject ohana dwelling shall be deemed void. A time extension may be granted for good cause, provided, the permittee and/or owner applies in writing at least forty-five (45) calendar days before the expiration of the two (2) year period.
- (b) Off-street parking space for two vehicles is designated on the submitted site plan to fulfill the off-street parking requirement. The off-street parking spaces may not be employed for storage or other use unless and until approved alternative on-site parking arrangements are established.

Mr. David M. Frenz  
Page 2  
October 5, 1990

- (c) All construction drawings together with approved site plan drawn to scale submitted with the ohana dwelling building permit application shall denote location and identify required two (2) off-street parking spaces.
- (d) The applicant must comply with established flood regulations. Please refer to your copy of the September 21, 1990 Department of Public Works memorandum.
- (e) The ohana dwelling shall conform to all requirements of codes and statutes pertaining to access and building construction.
- (f) The applicant shall conform to State Department of Health standards and regulations and following comment(s) dated September 25, 1990:

"Per Administrative Rule, Title 11, Chapter 62, Wastewater, a single individual wastewater system (IWS) may receive no more than 800 gallons of sewage per day based on 200 gallons per bedroom per day. This limits discharge into a single IWS to four bedrooms. Developments that exceed four bedrooms must install a additional IWS.

The Department of Health would like to inform the applicant that wastewater rules is in the process of change and that comments to the project may change accordingly."

- (g) This Ohana Dwelling permit is subject to all other applicable rules, regulations and requirements, including but not limited to those of the Planning Department, Department of Public Works, and State Department of Health.

Please bring or attach a copy of this Permit to expedite processing the building plans and building permit application to construct the ohana dwelling. Should you have any questions regarding the above, please feel free to contact either Masa Onuma or William Yananoha of my staff at 961-8288.

Sincerely,

  
DUANE KANUHA  
Planning Director

WRV:etn

cc: Department of Health,  
Chief Sanitarian  
Department of Public Works  
Real Property Tax Division

Plot Plan  
Ohana Dwelling for David Frenz  
1115 W. Kawailani St.  
TMK 2-4-03-60

NORTH

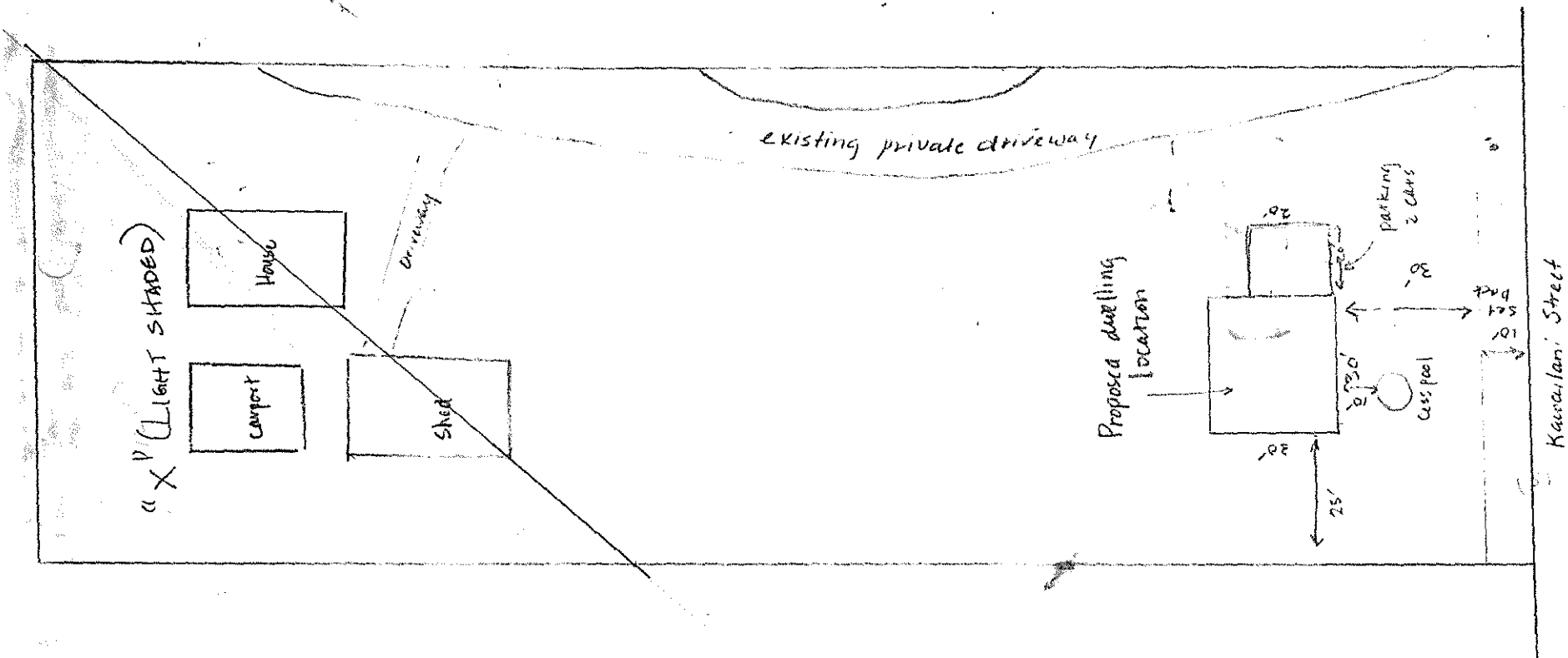

"X" (LIGHT SHADED)

House

Garport

Shed

Driveway

existing private driveway

Proposed dwelling location

parking 2 cars

Cess pool

Kawailani Street