

April 12, 1991

Mr. Roxas Tomas  
P.O. Box 324  
Hawi, HI 96719

Dear Mr. Tomas:

Ohana Dwelling Permit (OD 91-68) <sup>2096</sup>  
Tax Map Key: 5-3-09:50, Lot 74

The subject application has been reviewed by the concerned agencies and note:

1. The subject tax map key parcel is served by an acceptable street;
2. The subject application can meet with the State Department of Health wastewater treatment and disposal systems requirements;
3. The copy of document(s) received relating to subject tax map key parcel to establish title and exhibits contained therein do not include any deed restriction or covenant to prohibit construction of requested Ohana dwelling; and,
4. The site plan denotes two off-street parking stalls on the property.

In view of the above, by this letter, you are hereby granted permission to construct the Ohana Dwelling, subject to the following condition(s):

- (a) The building permit for the Ohana Dwelling shall be secured on or before April 12, 1992. It should be noted that the permit is effective for only one (1) year and should applicant fail to secure a building permit within this period, a new application must be applied for.

APR 15 1991

Mr. Roxas Tomas  
Page 2  
April 12, 1991

Please bring or attach a copy of this Permit to expedite processing the building plans and building permit application to construct the ohana dwelling.

- (b) Off-street parking space for two vehicles is designated on the submitted site plan to fulfill the off-street parking requirement. The off-street parking spaces may not be employed for storage or other use unless and until approved alternative on-site parking arrangements are established.
- (c) All construction drawings together with approved site plan drawn to scale submitted with the ohana dwelling building permit application shall denote location and identify required two (2) off-street parking spaces.

(d) The ohana dwelling shall conform to all requirements of codes and statutes pertaining to access and building construction.

(e) The applicant shall conform to State Department of Health standards and regulations and following comment(s) dated March 11, 1991:

"Per Administrative Rule, Title 11, Chapter 62, 'Wastewater', a single individual wastewater system (IWS) may receive no more than 800 gallons per day of sewage which is generated from a single or multiple unit complex containing a total of no more than four (4) bedrooms. Developments that exceed four (4) bedrooms must install another individual wastewater system.

The minimum setback requirements for an IWS as per Administrative Rules 11-62 must be met. A review of our files shows no record or report of an inspection for the existing cesspool that is noted on the applicant's plan. The owner will need to complete and submit the attached "REPORT ON INDIVIDUAL WASTEWATER SYSTEM", or submit an engineered report to our Department for review.

The Department of Health would like to inform the applicant that wastewater rules are in the process of change and that comments on the project may change accordingly."

(f) This Ohana Dwelling permit is subject to all other applicable rules, regulations and requirements, including but not limited to those of the Planning Department, Department of Public Works, and State Department of Health.

Mr. Roxas Tomas  
Page 3  
April 12, 1991

Should you have any questions regarding the above, please feel free to contact either Masa Onuma or William Yamarcha of my staff at 961-8288.

Sincerely,

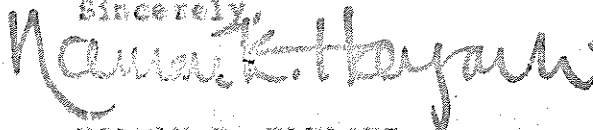

NORMAN K. HAYASHI  
Planning Director

WRY/NO:eti  
Etc.  
1371D

cc: Department of Health,  
Chief Sanitarian  
Department of Public Works  
Real Property Tax Division  
West Hawaii Office

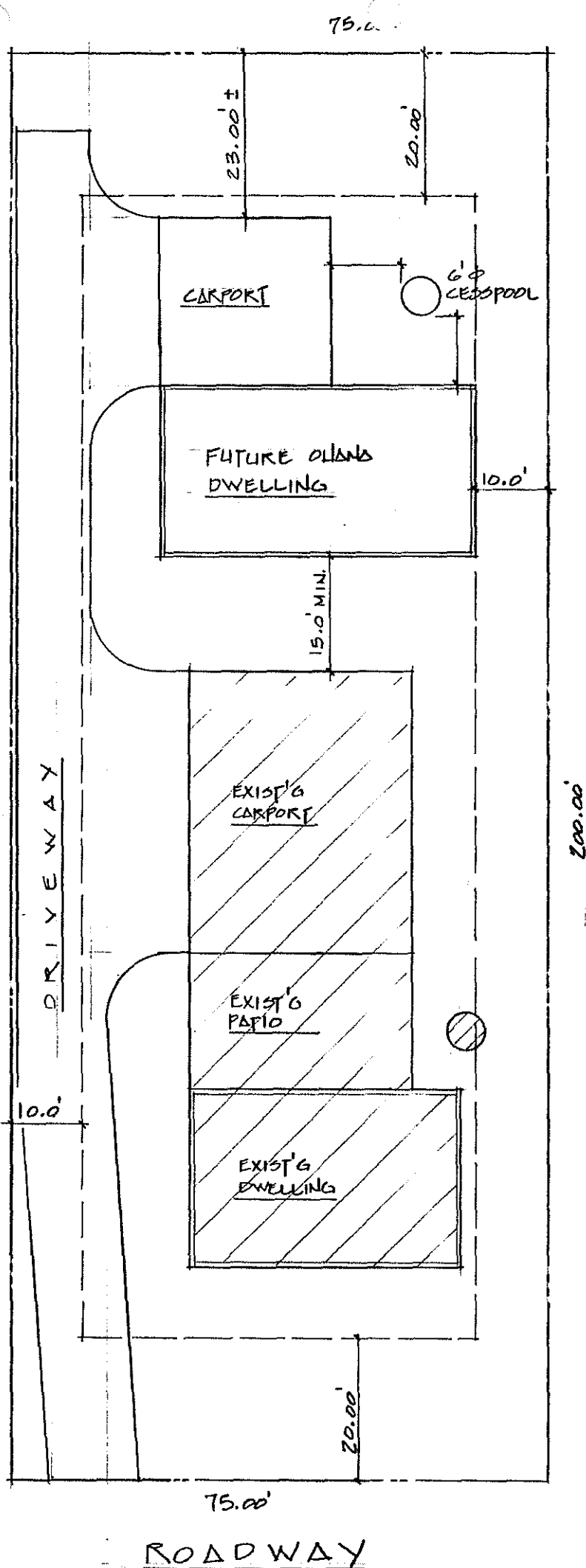

PLOT PLAN  
 SC: 1" = 20.00'

TMK: 5-3-09:50  
 Lot # 74  
 LOT AREA: 15,000 SF  
 FOR HALAULA SUB'D.,  
 N. KOHOLA, HAWAII

ROADWAY