

May 6, 1991

Mr. and Mrs. Richard Onishi
1673 Kilauea Avenue
Mile, Hawaii 96726

Dear Mr. and Mrs. Onishi:

Ohana Dwelling Permit (CD 91-155)
Tax Map Key: 2-4-09:51

2140

The subject application has been reviewed by the concerned agencies and note:

1. The subject tax map key parcel is served by an acceptable street;
2. The subject application can meet with the State Department of Health wastewater treatment and disposal systems requirements;
3. The copy of document(s) received relating to subject tax map key parcel to establish title and exhibits contained therein do not include any deed restriction or covenant to prohibit construction of requested ohana dwelling; and,
4. The site plan denotes two off-street parking stalls on the property.

In view of the above, by this letter, you are hereby granted permission to construct the Ohana Dwelling, subject to the following condition(s):

- (a) The building permit for the Ohana Dwelling shall be secured on or before May 21, 1992. It should be noted that the permit is effective for only one (1) year and should applicant fail to secure a building permit within this period, a new application must be applied for.

Please bring or attach a copy of this Permit to expedite processing the building plans and building permit application to construct the ohana dwelling.

- (b) Off-street parking space for two vehicles is designated on the submitted site plan to fulfill the off-street parking requirement. The off-street parking spaces may not be

MAY 22 1991

Mr. and Mrs. Richard Onishi
Page 2
May 21, 1991

employed for storage or other use unless and until approved alternative on-site parking arrangements are established.

- (c) All construction drawings together with approved site plan drawn to scale submitted with the ohana dwelling building permit application shall denote location and identify required two (2) off-street parking spaces.
- (d) The ohana dwelling shall conform to all requirements of codes and statutes pertaining to access and building construction. Please refer to your copy of the Department of Public Works memorandum dated May 14, 1991.
- (e) The applicant shall conform to State Department of Health standards and regulations and following comment(s) dated May 8, 1991:

"Per Administrative Rule, Title 11, Chapter 62, Wastewater, a single individual wastewater system (IWS) may receive no more than 800 gallons of sewage per day based on 200 gallons per bedroom per day. This limits discharge into a single IWS to four bedrooms. Developments which exceed four bedrooms must install a additional IWS.

The Department of Health would like to inform the applicant that the wastewater rule is in the process of change and that comments made to the project may change accordingly."

- (f) This Ohana Dwelling permit is subject to all other applicable rules, regulations and requirements, including but not limited to those of the Planning Department, Department of Public Works, and State Department of Health.

Should you have any questions regarding the above, please feel free to contact either Masa Onuma or William Yamamoto of my staff at 961-8288.

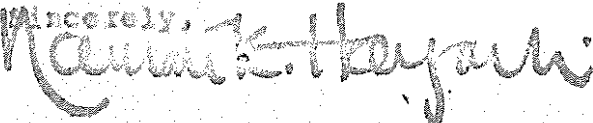
Sincerely,

NORMAN E. HAYASHI
Planning Director

WEY/MO:etl
1760D-9,10
cc: Department of Health,
Chief Sanitarian
Department of Public Works
Real Property Tax Division
Enc.

DEPARTMENT OF PUBLIC WORKS

ENGINEERING DIVISION

ALL DIMENSIONS ARE GIVEN UNLESS OTHERWISE SPECIFIED. ALL DIMENSIONS ARE TO FACE UNLESS OTHERWISE SPECIFIED. ALL DIMENSIONS ARE TO FACE UNLESS OTHERWISE SPECIFIED.

ALL ELEVATIONS AND GRADING SHOWN ARE TO BE USED TO OF THE PROJECT. A RIGHT MAY BE REQUIRED FOR LOT GRABBING AND/OR ETC.

NO ADDITIONAL RAINFALL IS REQUIRED BY THIS PROJECT. THE USE OF UNIFORM COUNTY OR ADJACENT DISTRICTS. ALL IMPROVEMENTS SHALL BE TO CHAPTER 27 OF THE HAWAII CODE.

DEPARTMENT OF PUBLIC WORKS

ENGINEERING DIVISION

DATE: 11/5/93

11/5/93

PLOT PLAN

SCALE: 1"=20'

A PROPOSED OHAUA DWELLING FOR:

MR & MRS. RICHARD ONISHI

TRK: 2-4-09:51 LOT#

WAIKĀA HOMESTEAD 1ST SER SOHILOHI

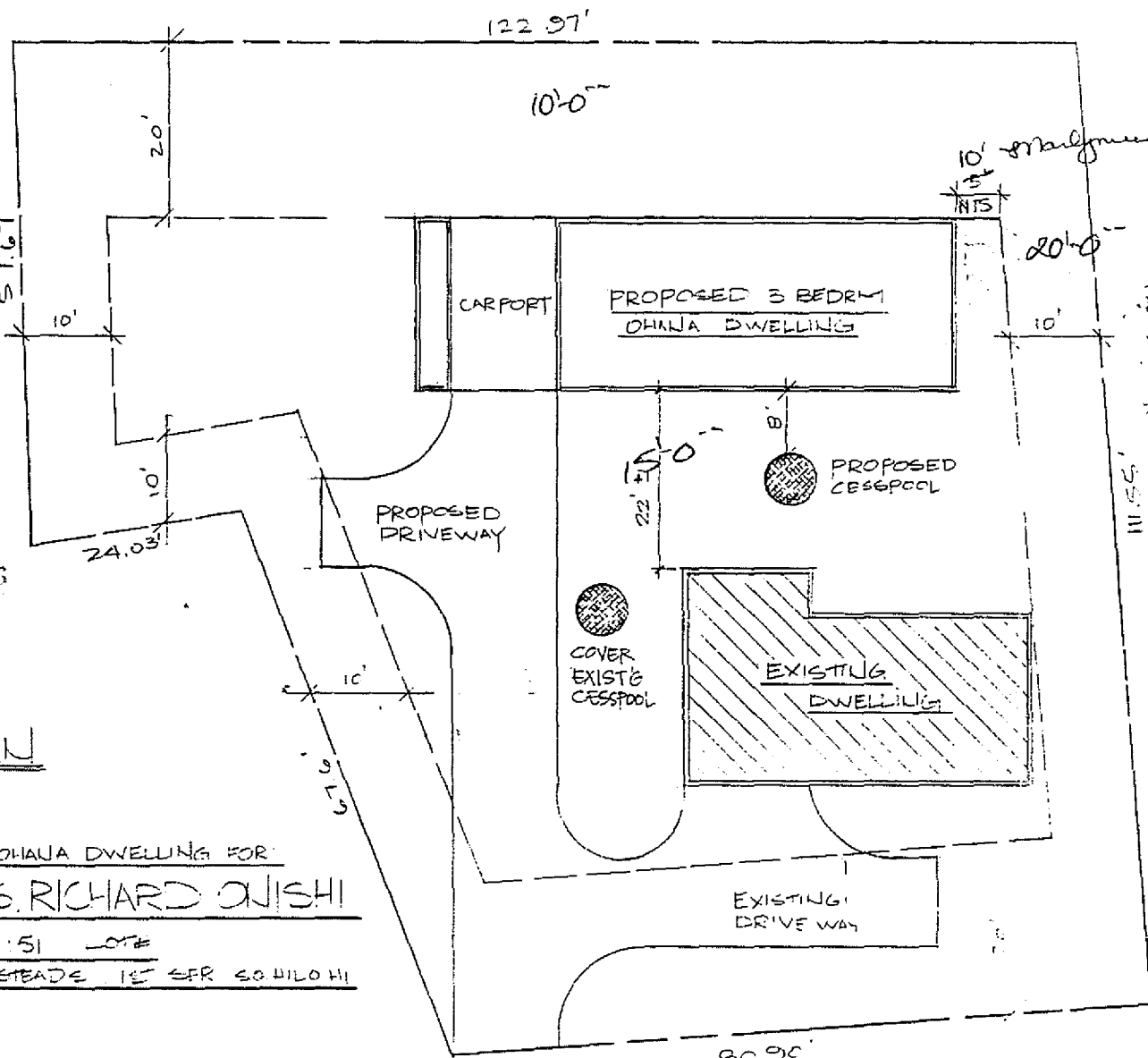

0091-159

APPROVED

[Signature]

Date: 11/5/93

