

July 5, 1991

Mr. Henry Soper  
P.O. Box 611  
Volcano, HI 96785

Dear Mr. Soper:

Ohana Dwelling Permit (OD 91-240) 2214  
Tax Map Key: 1-9-19:8, Lot 150

The subject application has been reviewed by the concerned agencies and note:

1. The subject tax map key parcel is served by an acceptable street;
2. The subject application can meet with the State Department of Health wastewater treatment and disposal systems requirements;
3. The copy of document(s) received relating to subject tax map key parcel to establish title and exhibits contained therein do not include any deed restriction or covenant to prohibit construction of requested ohana dwelling; and,
4. The site plan denotes two off-street parking stalls on the property.

In view of the above, by this letter, you are hereby granted permission to construct the Ohana Dwelling, subject to the following condition(s):

- (a) The building permit for the Ohana Dwelling shall be secured on or before July 5, 1992. It should be noted that the permit is effective for only one (1) year and should applicant fail to secure a building permit within this period, a new application must be applied for.

Please bring or attach a copy of this Permit to expedite processing the building plans and building permit application to construct the ohana dwelling.

- (b) Off-street parking space for two vehicles is designated on the submitted site plan to fulfill the off-street parking requirement. The off-street parking spaces may not be

JUL 8 1991

Mr. Henry Soper  
Page 2  
July 5, 1991

employed for storage or other use unless and until approved alternative on-site parking arrangements are established.

- (c) All construction drawings together with approved site plan drawn to scale submitted with the ohana dwelling building permit application shall denote location and identify required two (2) off-street parking spaces.
- (d) The ohana dwelling shall conform to all requirements of codes and statutes pertaining to access and building construction.
- (e) The applicant shall conform to State Department of Health standards and regulations and following comment(s) dated June 24, 1991:

"Per Administrative Rule, Title 11, Chapter 62, Wastewater, a single individual wastewater system (IWS) may receive no more than 800 gallons of sewage per day based on 200 gallons per bedroom per day. This limits discharge into a single IWS to four bedrooms. Developments which exceed four bedrooms must install a additional IWS.

The Department of Health would like to inform the applicant that the wastewater rule is in the process of change and that comments made to the project may change accordingly."

- (f) This Ohana Dwelling permit is subject to all other applicable rules, regulations and requirements, including but not limited to those of the Planning Department, Department of Public Works, and State Department of Health.

Should you have any questions regarding the above, please feel free to contact either Masa Onuma or William Yamanoha of my staff at 961-8288.

Sincerely,



NORMAN K. HAYASHI  
Planning Director

MO:eti  
2318D-7  
cc: Department of Health,  
Chief Sanitarian  
Department of Public Works  
Real Property Tax Division



Min. 20'  
Rear Yard  
Setback Required

PROPOSED  
OHANA DWELLING  
(1 BED ROOM)

1.1382 ACRES / AG.20 ZONING

NOTE: LOT COVER OHIA FOREST / GRADE-LEVEL  
TO SLIGHT NORTH EAST SLOPE DOWNWARD

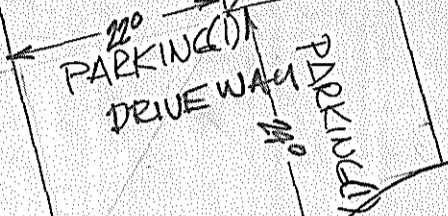

30°

WATER CATCHMENT SYSTEM - TANK BELOW BEDROOMS

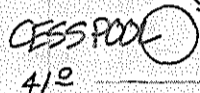

240.25

Min. 20'  
Side Yard  
Setback Required

EXISTING  
HOUSE SITE  
(2 BED ROOM)

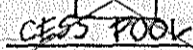

DRIVEWAY

Min. 20'  
Side Yard  
Setback Required

20°

30°

125°

69°

10°R

15°

10°R

Min. 30'  
Front Yard  
Setback Required

LOT 150 KALANINAULI EXTENTION ROAD "D"

"VOLCANO CYMBIDIUM ACRES SUBDIVISION"

PLOT PLAN

SCALE 1 IN. = 20 FT.