

September 12, 1991

Mr. Keith G. Reed
P.O. Box 225
Holualoa, HI 96725

Dear Mr. Reed:

Ohana Dwelling Permit (OD 91-313) ²³²⁶
Tax Map Key: 7-5-14:28

The subject application has been reviewed by the concerned agencies and note:

1. The subject tax map key parcel is served by an acceptable street;
2. The subject application can meet with the State Department of Health wastewater treatment and disposal systems requirements;
3. The copy of document(s) received relating to subject tax map key parcel to establish title and exhibits contained therein do not include any deed restriction or covenant to prohibit construction of requested ohana dwelling; and,
4. The site plan denotes two off-street parking stalls on the property.

In view of the above, by this letter, you are hereby granted permission to construct the Ohana Dwelling, subject to the following condition(s):

- (a) The building permit for the Ohana Dwelling shall be secured on or before September 12, 1992. It should be noted that the permit is effective for only one (1) year and should applicant fail to secure a building permit within this period, a new application must be applied for.

Please bring or attach a copy of this Permit to expedite processing the building plans and building permit application to construct the ohana dwelling.

- (b) Off-street parking space for two vehicles is designated on the submitted site plan to fulfill the off-street parking requirement. The off-street parking spaces may not be employed for storage or other use unless and until approved alternative on-site parking arrangements are established.

SEP 13 1991

Mr. Keith G. Reed
Page 2
September 12, 1991

- (c) All construction drawings together with approved site plan drawn to scale submitted with the ohana dwelling building permit application shall denote location and identify required two (2) off-street parking spaces.
- (d) The ohana dwelling shall conform to all requirements of codes and statutes pertaining to access and building construction. Please refer to your copy of the Department of Public Works memorandum dated September 9, 1991.
- (e) The applicant shall conform to State Department of Health standards and regulations and following comment(s) dated August 19, 1991:

"Per Administrative Rule, Title 11, Chapter 62, Wastewater, a single individual wastewater system (IWS) may receive no more than 800 gallons of sewage per day based on 200 gallons per bedroom per day. This limits discharge into a single IWS to four bedrooms. Developments which exceed four bedrooms must install a additional IWS.

No individual wastewater system shall be located at any point having less then the minimum distances indicated in Chapter 62.

The Department of Health would like to inform the applicant that the wastewater rule is in the process of change and that comments made to the project may change accordingly.

- (f) This Ohana Dwelling permit is subject to all other applicable rules, regulations and requirements, including but not limited to those of the Planning Department, Department of Public Works, and State Department of Health.

Should you have any questions regarding the above, please feel free to contact either Masa Onuma or William Yamanoha of my staff at 961-8288.

Sincerely,

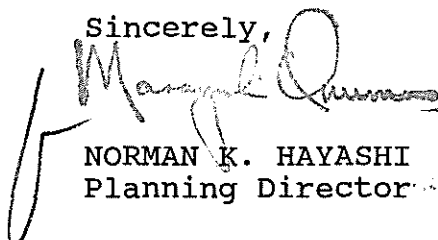

NORMAN K. HAYASHI
Planning Director

WRY/MO:eti
3053D-5
cc: Department of Health,
Chief Sanitarian
Department of Public Works
Real Property Tax Division - Kona
West Hawaii Office

SFD 1 3 1991

DUCE # 5

OY
CC

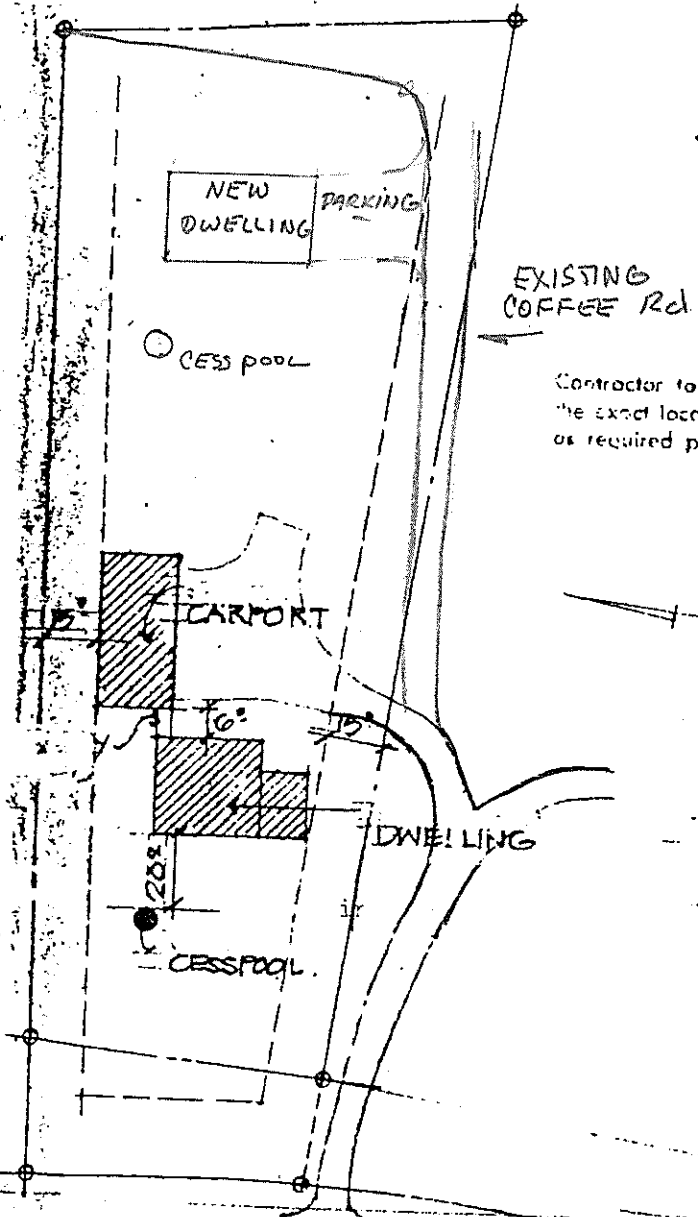

Contractor to verify with owner of job site, the exact location of building and cesspool as required prior to construction.

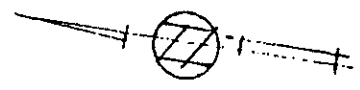

PLOT PLAN SC: 1" = 50 FT.

TIME: 7-5-14-28
 LOC: PUA A 2ND N. KONA
 AREA: .69 AC.

MAMALAHOA HIGHWAY

