

September 10, 1991

Mr. and Mrs. William Medeiros, Jr.
139 Hookano Street
Hilo, Hawaii 96729

Dear Mr. and Mrs. Medeiros:

Ohana Dwelling Permit (OD 91-324)
Tax Map Key: 2-4-14:66, Lot 44

The subject application has been reviewed by the concerned agencies and note:

1. The subject tax map key parcel is served by an acceptable street;
2. The subject application can meet with the State Department of Health wastewater treatment and disposal systems requirements;
3. The copy of document(s) received relating to subject tax map key parcel to establish title and exhibits contained therein do not include any deed restriction or covenant to prohibit construction of requested ohana dwelling; and,
4. The site plan denotes two off-street parking stalls on the property.

In view of the above, by this letter, you are hereby granted permission to construct the Ohana Dwelling, subject to the following condition(s):

- (a) The building permit for the Ohana Dwelling shall be secured on or before September 10, 1992. It should be noted that the permit is effective for only one (1) year and should applicant fail to secure a building permit within this period, a new application must be applied for.

Please bring or attach a copy of this Permit to expedite processing the building plans and building permit application to construct the ohana dwelling.

- (b) Off-street parking space for two vehicles is designated on the submitted site plan to fulfill the off-street parking

SEP 11 1991

Mr. and Mrs. William Medeiros, Jr.
Page 2
September 10, 1991

- requirement. The off-street parking spaces may not be employed for storage or other use unless and until approved alternative on-site parking arrangements are established.
- (c) All construction drawings together with approved site plan drawn to scale submitted with the ohana dwelling building permit application shall denote location and identify required two (2) off-street parking spaces.
 - (d) The ohana dwelling shall conform to all requirements of codes and statutes pertaining to access and building construction.
 - (e) The applicant shall conform to State Department of Health standards and regulations and following comment(s) dated August 19, 1991:

"Per Administrative Rule, Title 11, Chapter 62, Wastewater, a single individual wastewater system (IWS) may receive no more than 800 gallons of sewage per day based on 200 gallons per bedroom per day. This limits discharge into a single IWS to four bedrooms. Developments which exceed four bedrooms must install a additional IWS.

The Department of Health would like to inform the applicant that the wastewater rule is in the process of change and that comments made to the project may change accordingly."

- (f) This Ohana Dwelling permit is subject to all other applicable rules, regulations and requirements, including but not limited to those of the Planning Department, Department of Public Works, and State Department of Health.

Should you have any questions regarding the above, please feel free to contact either Masa Onuma or William Yamanoha of my staff at 961-8288.

Sincerely,

NORMAN K. HAYASHI
Planning Director

WRY/MO:eti
2837D-17

cc: Department of Health,
Chief Sanitarian
Department of Public Works
Real Property Tax Division

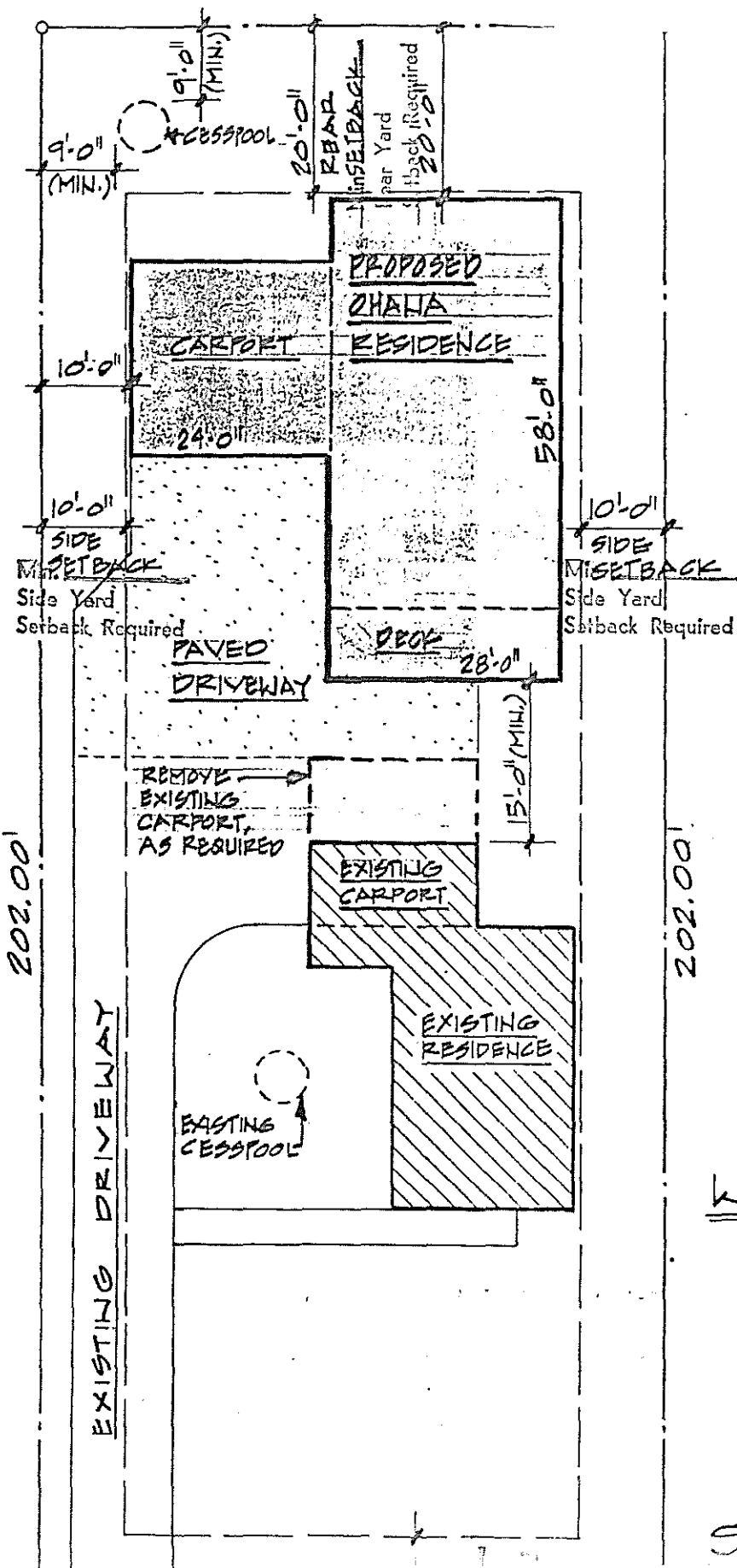

PERMITS REQUIRED BY THE
 ENGINEERING DIVISION OF THE
 DEPARTMENT OF PUBLIC WORKS:

1) GRADING PERMIT: IN ACCORDANCE WITH CHAPTER 10, HAWAII COUNTY CODE, AS AMENDED. A PERMIT MAY BE REQUIRED FOR LOT GRADING (EXCAVATION AND OR FILL) WORK BEYOND THE BUILDING LINES.

(2) DRIVEWAY PERMIT: IN ACCORDANCE WITH CHAPTER 22, HAWAII COUNTY CODE, A PERMIT SHALL BE OBTAINED FOR DRIVEWAY CONSTRUCTION WORK WITHIN THE COUNTY RIGHT-OF-WAY.

DRAINAGE: NO BUILDING SHALL BE CONSTRUCTED WITHIN OR OVER A NATURAL OR MAN-MADE DRAINAGE COURSE.

ENGINEERING DIVISION

These plans accompanied building permit application on

Date 11/05/91

WILLIAM & COLLEEN MEDEIRA

139 HOOKANO ST.
 T.M.K.: 2-4-14:66
 LOT SIZE, 15,150 SQ. FT.

SITE PLAN