

October 11, 1991

Mr. Paul Baillie  
HCR 4010  
Keaau, HI 96749-9701

Dear Mr. Baillie:

Ohana Dwelling Permit (OD 91-364)  
Tax Map Key: 1-6-08:301, Lot 22 2367

The subject application has been reviewed by the concerned agencies and note:

1. The subject tax map key parcel is served by an acceptable street;
2. The subject application can meet with the State Department of Health wastewater treatment and disposal systems requirements;
3. The copy of document(s) received August 14 and September 5, 1991 relating to subject tax map key parcel to establish title and exhibits contained therein do not include any deed restriction or covenant to prohibit construction of requested ohana dwelling; and,
4. The site plan denotes two off-street parking stalls on the property.

In view of the above, by this letter, you are hereby granted permission to construct the Ohana Dwelling, subject to the following condition(s):

- (a) The building permit for the Ohana Dwelling shall be secured on or before October 11, 1992. It should be noted that the permit is effective for only one (1) year and should applicant fail to secure a building permit within this period, a new application must be applied for.

OCT 14 1991

Mr. Paul Baillie  
Page 2  
October 11, 1991

Please bring or attach a copy of this Permit to expedite processing the building plans and building permit application to construct the ohana dwelling.

- (b) Off-street parking space for two vehicles is designated on the submitted site plan to fulfill the off-street parking requirement. The off-street parking spaces may not be employed for storage or other use unless and until approved alternative on-site parking arrangements are established.
- (c) All construction drawings together with approved site plan drawn to scale submitted with the ohana dwelling building permit application shall denote location and identify required two (2) off-street parking spaces.
- (d) The ohana dwelling shall conform to all requirements of codes and statutes pertaining to access and building construction.
- (e) The applicant shall conform to State Department of Health standards and regulations.
- (f) This Ohana Dwelling permit is subject to all other applicable rules, regulations and requirements, including but not limited to those of the Planning Department, Department of Public Works, and State Department of Health.

Should you have any questions regarding the above, please feel free to contact either Masa Onuma or William Yamanoha of my staff at 961-8288.

Sincerely,



NORMAN K. HAYASHI  
Planning Director

WRY:eti  
3344D-5  
cc: Department of Health,  
Chief Sanitarian  
Department of Public Works  
Real Property Tax Division

ORCHID LAND  
ESTATES

M.K. 1-6-8-301  
2 ACRES

OWNERS  
PAUL + CYNTHIA  
BAILLIE

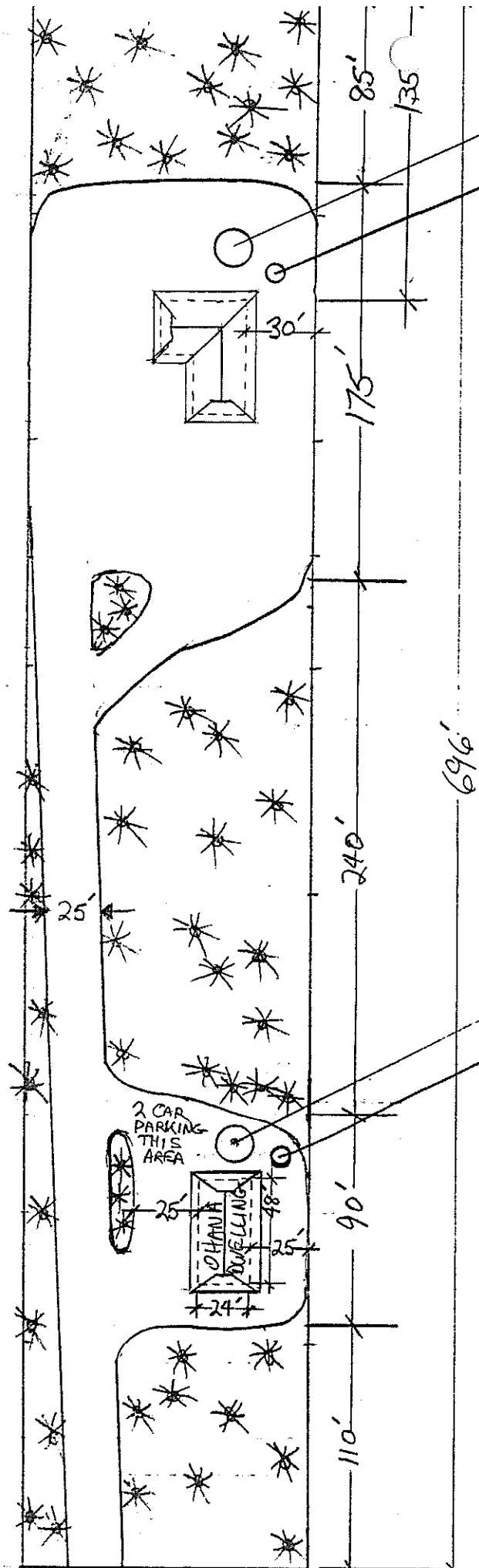

WATER TANK SEE BELOW  
FOR SET BACKS  
CESS POOL SEE BELOW  
FOR SET BACKS  
SET BACKS SAME AS  
LISTED BELOW

WATER TANK 10' FROM  
BLDG., OBSERVE BLDG. SETBACK  
CESS POOL 9' MINIMUM  
FROM PROPERTY LINE  
5' MINIMUM FROM BLDG. + W.T.

SCALE:  $\frac{3}{8}'' = 25'$