

November 1, 1991

Mr. Morris T. Niimi  
SR 16-1342  
Keaau, Hawaii 96749

Dear Mr. Niimi:

Ohana Dwelling Permit (OD 91-449) 2425  
Tax Map Key: 1-6-64:261, Lot 8310

The subject application has been reviewed by the concerned agencies and note:

1. The subject tax map key parcel is served by an acceptable street;
2. The subject application can meet with the State Department of Health wastewater treatment and disposal systems requirements;
3. The copy of document(s) received relating to subject tax map key parcel to establish title and exhibits contained therein do not include any deed restriction or covenant to prohibit construction of requested ohana dwelling; and,
4. The site plan denotes two off-street parking stalls on the property.

In view of the above, by this letter, you are hereby granted permission to construct the Ohana Dwelling, subject to the following condition(s):

- (a) The building permit for the Ohana Dwelling shall be secured on or before November 1, 1992. It should be noted that the permit is effective for only one (1) year and should applicant fail to secure a building permit within this period, a new application must be applied for.

Please bring or attach a copy of this Permit to expedite processing the building plans and building permit application to construct the ohana dwelling.

- (b) Off-street parking space for two vehicles is designated on the submitted site plan to fulfill the off-street parking requirement. The off-street parking spaces may not be

NOV 4 1991

Mr. Morris T. Niimi  
Page 2  
November 1, 1991

employed for storage or other use unless and until approved alternative on-site parking arrangements are established.

- (c) All construction drawings together with approved site plan drawn to scale submitted with the ohana dwelling building permit application shall denote location and identify required two (2) off-street parking spaces.
- (d) The ohana dwelling shall conform to all requirements of codes and statutes pertaining to access and building construction.
- (e) The applicant shall conform to State Department of Health standards and regulations and following comment(s) dated October 30, 1991:

"The existing cesspool was allowed using the old wastewater rules and would be grandfathered. A new cesspool would not be allowed in the subject lot. The existing cesspool may service two dwelling units with a total of five (5) bedrooms. If the owner wishes, the new Ohana Dwelling may be serviced by a treatment individual wastewater system such as a septic tank system.

If there is need to discuss the contents of this communication, please call my office, Ph. 933-4725."

- (f) This Ohana Dwelling permit is subject to all other applicable rules, regulations and requirements, including but not limited to those of the Planning Department, Department of Public Works, and State Department of Health.

Should you have any questions regarding the above, please feel free to contact either Masa Onuma or William Yamanoha of my staff at 961-8288.

Sincerely,

  
NORMAN K. HAYASHI  
Planning Director

MO:eti  
3544D-9  
cc: Department of Health,  
Chief Sanitarian  
Department of Public Works  
Real Property Tax Division

PERMITS REQUIRED BY THE ENGINEERING DEPARTMENT OF THE DEPARTMENT OF PUBLIC WORKS:

- 1) GRADING PERMIT: IN ACCORDANCE WITH CHAPTER 10, HAWAII COUNTY CODE, AS AMENDED, A PERMIT MAY BE REQUIRED FOR LOT GRADING (EXCAVATION AND OR FILL) WORK BEYOND THE BUILDING LINES.
  - 2) DRIVEWAY PERMIT: IN ACCORDANCE WITH CHAPTER 22, HAWAII COUNTY CODE, A PERMIT SHALL BE OBTAINED FOR DRIVEWAY CONSTRUCTION WORK WITHIN THE COUNTY DRIVEWAY.
- DRAINAGE: NO BUILDING SHALL BE CONSTRUCTED WITHIN OR OVER NATURAL OR MAN-MADE DRAINAGE COURSE.

ENGINEERING DIVISION

These plans accompanied building permit application on

Date 12/02/91

0091-449  
**APPROVED**  
*[Signature]*  
 Director, County Planning Department  
 Date: 12/9/91

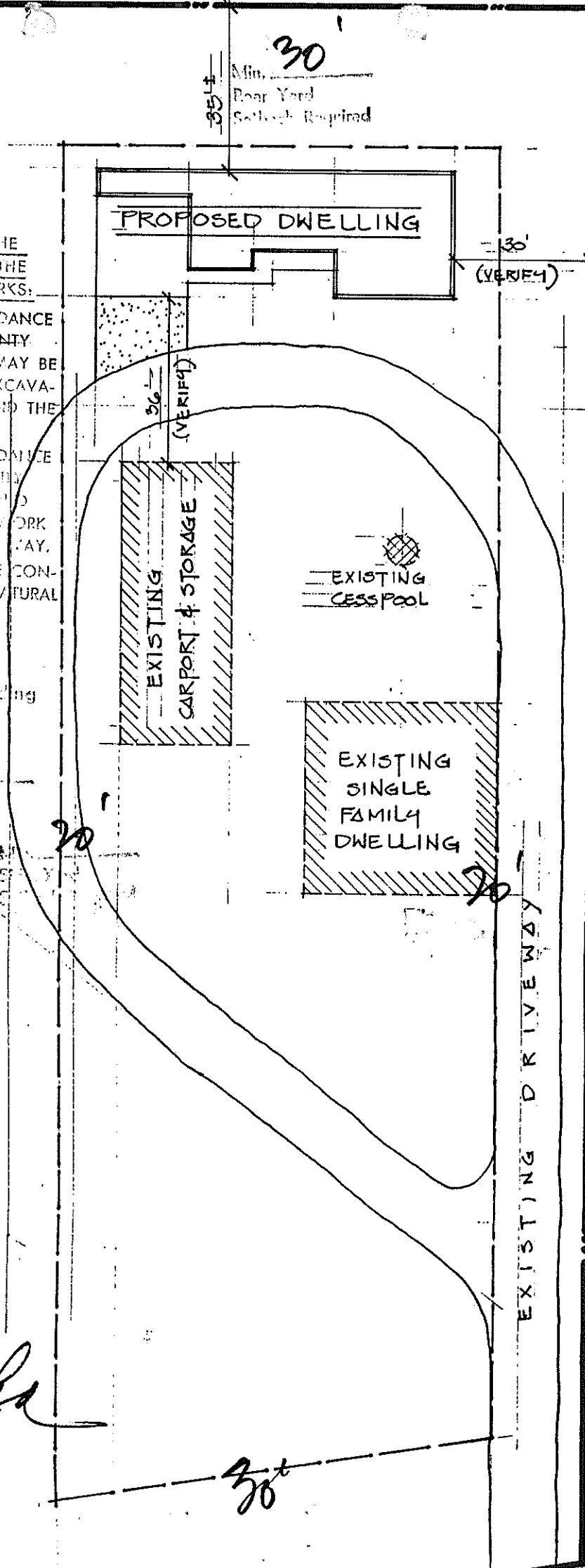

136.66' KEAAU-PAHOA HWY.

**PLOT PLAN**

Scale: 1" = 30.00'

MK: 1-6-64: 261 Lot # 8310

Lot Area: 1 ac. - KEAAU, PUNA, HI.

part of ORCHID LAND ESTATES & HAWAIIAN PARADISE PARCEL