

November 1, 1991

Mr. and Mrs. Raymond Okamoto  
P.O. Box 4366  
Hilo, Hawaii 96720

Dear Mr. and Mrs. Okamoto:

Ohana Dwelling Permit (OD 91-457) 2428  
Tax Map Key: 2-5-60:2, Lot 8

The subject application has been reviewed by the concerned agencies and note:

1. The subject tax map key parcel is served by an acceptable street;
2. The subject application can meet with the State Department of Health wastewater treatment and disposal systems requirements;
3. The copy of document(s) received relating to subject tax map key parcel to establish title and exhibits contained therein do not include any deed restriction or covenant to prohibit construction of requested ohana dwelling; and,
4. The site plan denotes two off-street parking stalls on the property.

In view of the above, by this letter, you are hereby granted permission to construct the Ohana Dwelling, subject to the following condition(s):

- (a) The building permit for the Ohana Dwelling shall be secured on or before November 1, 1992. It should be noted that the permit is effective for only one (1) year and should applicant fail to secure a building permit within this period, a new application must be applied for.

Please bring or attach a copy of this Permit to expedite processing the building plans and building permit application to construct the ohana dwelling.

- (b) Off-street parking space for two vehicles is designated on the submitted site plan to fulfill the off-street parking requirement. The off-street parking spaces may not be

NOV 4 1991

Mr. and Mrs. Raymond Okamoto  
Page 2  
November 1, 1991

employed for storage or other use unless and until approved alternative on-site parking arrangements are established.

- (c) All construction drawings together with approved site plan drawn to scale submitted with the ohana dwelling building permit application shall denote location and identify required two (2) off-street parking spaces.
- (d) The ohana dwelling shall conform to all requirements of codes and statutes pertaining to access and building construction.
- (e) The applicant shall conform to State Department of Health standards and regulations and following comment(s) dated October 30, 1991:

"Cesspools as the means of sewage disposal would not be allowed because of the lack of land area of one (1) acre. A treatment individual wastewater system such as a septic tank system may service two dwelling units with a total of five (5) bedrooms. The system would need to be certified by a Registered Professional Engineer licensed by the State of Hawaii.

If there is need to discuss the contents of our comments, please have the applicant call my office, Ph. 933-42175."

- (f) This Ohana Dwelling permit is subject to all other applicable rules, regulations and requirements, including but not limited to those of the Planning Department, Department of Public Works, and State Department of Health.

Should you have any questions regarding the above, please feel free to contact either Masa Onuma or William Yamanoha of my staff at 961-8288.

Sincerely,

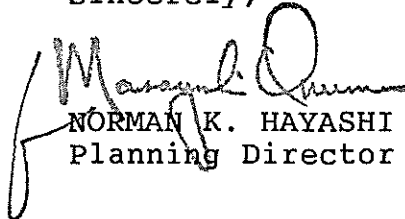
  
NORMAN K. HAYASHI  
Planning Director

MO:eti  
3537D-5  
cc: Department of Health,  
Chief Sanitarian  
Department of Public Works  
Real Property Tax Division - Kona  
West Hawaii Office

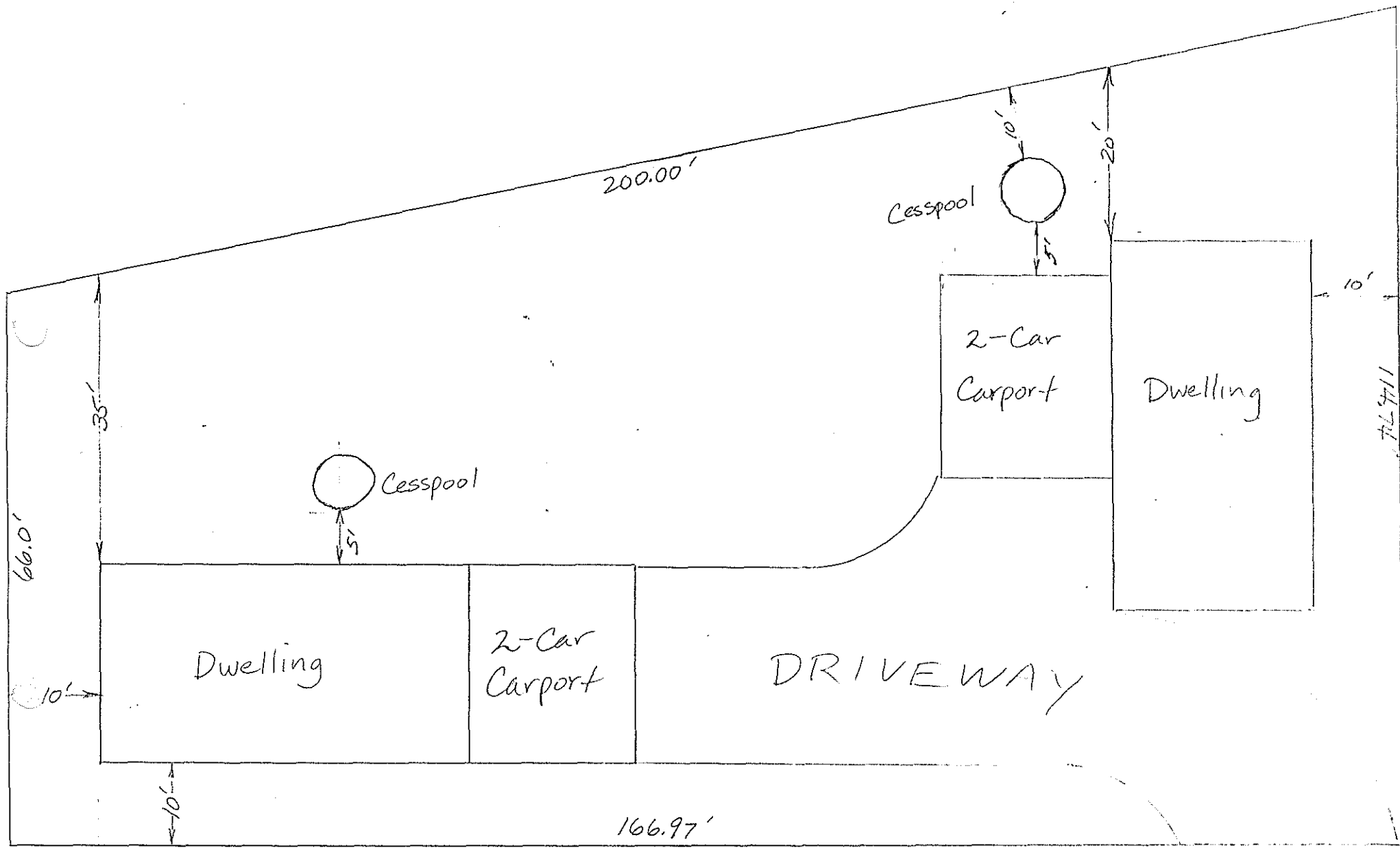

Scale: 1" = 16'

ROAD  
WAY