

November 20, 1991

Mr. Richard Forster
P.O. Box 4163
Kailua-Kona, HI 96745

Dear Mr. Forster:

Ohana Dwelling Permit (OD 91-489) 2495
Tax Map Key: 7-3-28:70, Lot 13

The subject application has been reviewed by the concerned agencies and note:

1. The subject tax map key parcel is served by an acceptable street;
2. The subject application can meet with the State Department of Health wastewater treatment and disposal systems requirements;
3. The copy of document(s) received relating to subject tax map key parcel to establish title and exhibits contained therein do not include any deed restriction or covenant to prohibit construction of requested ohana dwelling; and,
4. The site plan denotes two off-street parking stalls on the property.

In view of the above, by this letter, you are hereby granted permission to construct the Ohana Dwelling, subject to the following condition(s):

- (a) The building permit for the Ohana Dwelling shall be secured on or before November 20, 1992. It should be noted that the permit is effective for only one (1) year and should applicant fail to secure a building permit within this period, a new application must be applied for.

Please bring or attach a copy of this Permit to expedite processing the building plans and building permit application to construct the ohana dwelling.

NOV 21 1991

Mr. Richard Forster
Page 2
November 20, 1991

- (b) Off-street parking space for two vehicles is designated on the submitted site plan to fulfill the off-street parking requirement. The off-street parking spaces may not be employed for storage or other use unless and until approved alternative on-site parking arrangements are established.
- (c) All construction drawings together with approved site plan drawn to scale submitted with the ohana dwelling building permit application shall denote location and identify required two (2) off-street parking spaces.
- (d) The ohana dwelling shall conform to all requirements of codes and statutes pertaining to access and building construction. Please refer to your copy of the Department of Public Works memorandum dated November 4, 1991.
- (e) The applicant shall conform to State Department of Health standards and regulations and following comment(s) dated November 6, 1991:

"The septic tank proposal for the Ohana dwelling will need to be designed by a Professional Registered Engineer in the State of Hawaii."
- (f) This Ohana Dwelling permit is subject to all other applicable rules, regulations and requirements, including but not limited to those of the Planning Department, Department of Public Works, and State Department of Health.

Should you have any questions regarding the above, please feel free to contact either Masa Onuma or William Yamanoha of my staff at 961-8288.

Sincerely,

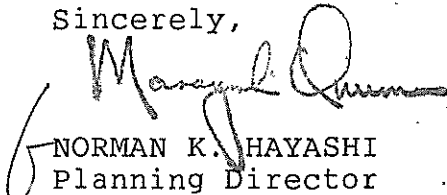
NORMAN K. HAYASHI
Planning Director

WRY:eti
3769D-5
cc: Department of Health,
Chief Sanitarian
Department of Public Works
Real Property Tax Division - Kona
West Hawaii Office

Proposed Ohana

220

26' setback

Septic Tank

Ohana Dwelling

Alternate water source

40' setback

Existing Home

Parking Space

Drive Way

Ahulani Street

Cesspool

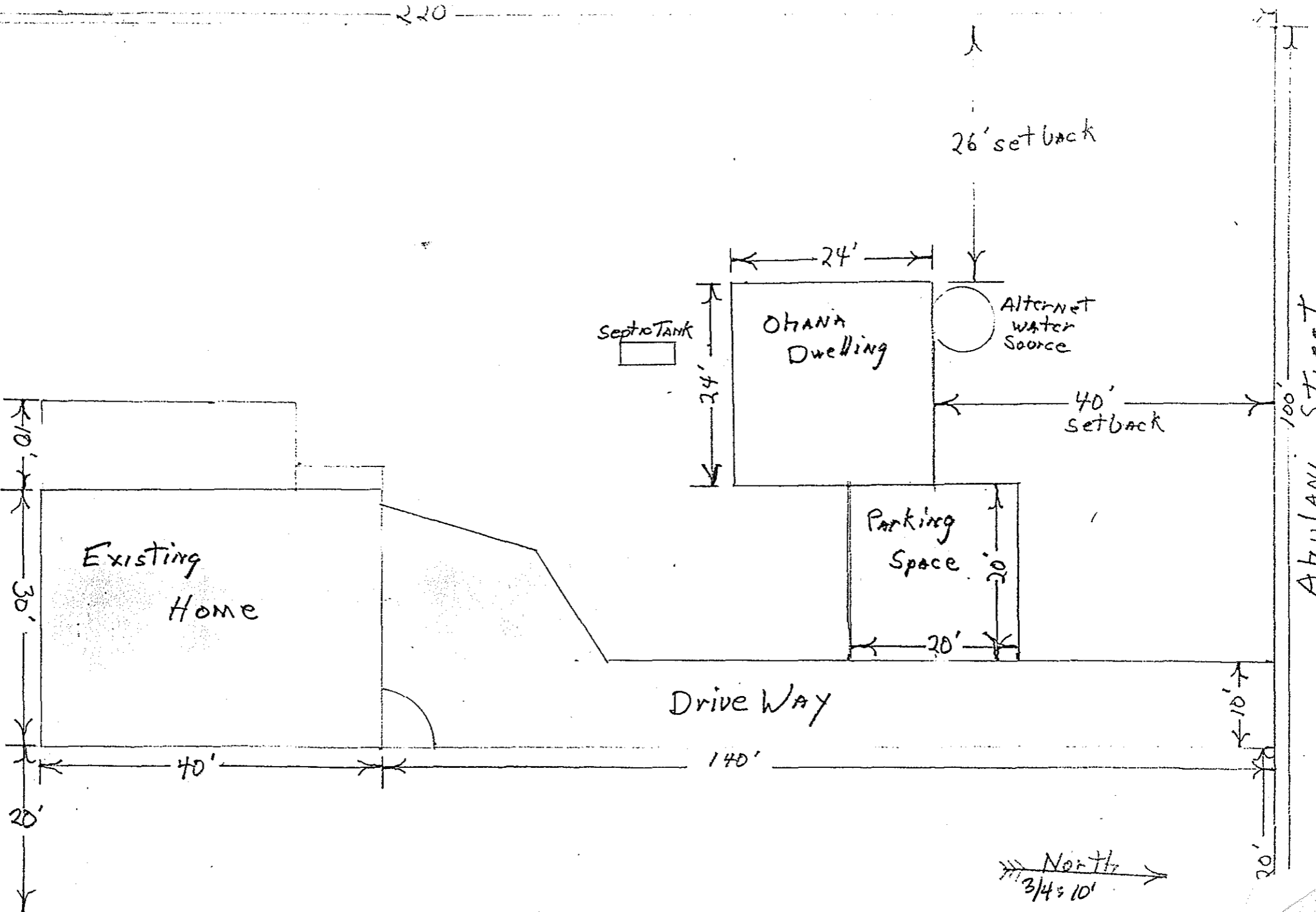

North
3/4" = 10'