

December 16, 1991

Mr. Kalani P. Kinney
P.O. Box 360
Volcano, Hawaii 96785

Dear Mr. Kinney:

Ohana Dwelling Permit (OD 91-525) ²⁵²⁷
Tax Map Key: 1-1-10:59, Lot 935

The subject application has been reviewed by the concerned agencies and note:

1. The subject tax map key parcel is served by an acceptable street;
2. The subject application can meet with the State Department of Health wastewater treatment and disposal systems requirements;
3. The copy of document(s) received relating to subject tax map key parcel to establish title and exhibits contained therein do not include any deed restriction or covenant to prohibit construction of requested ohana dwelling; and,
4. The site plan denotes two off-street parking stalls on the property.

In view of the above, by this letter, you are hereby granted permission to construct the Ohana Dwelling, subject to the following condition(s):

- (a) The building permit for the Ohana Dwelling shall be secured on or before December 16, 1992. It should be noted that the permit is effective for only one (1) year and should applicant fail to secure a building permit within this period, a new application must be applied for.

Please bring or attach a copy of this Permit to expedite processing the building plans and building permit application to construct the ohana dwelling.

- (b) Off-street parking space for two vehicles is designated on the submitted site plan to fulfill the off-street parking

DEC 16 1991

Mr. Kalani P. Kinney
Page 2
December 16, 1991

requirement. The off-street parking spaces may not be employed for storage or other use unless and until approved alternative on-site parking arrangements are established.

- (c) All construction drawings together with approved site plan drawn to scale submitted with the ohana dwelling building permit application shall denote location and identify required two (2) off-street parking spaces.
- (d) The ohana dwelling shall conform to all requirements of codes and statutes pertaining to access and building construction.
- (e) The applicant shall conform to State Department of Health standards and regulations and following comment(s) dated December 10, 1991:

"The subject lot is located in the Critical Wastewater Disposal Area. You are allowed one cesspool on the lot. The cesspool may service two dwelling units with a total of five (5) bedrooms."

The new Ohana Dwelling may be serviced by a treatment individual wastewater system such as a septic tank system. Please call the Chief Sanitarian's Office, Ph. 933-4275 for additional information.

- (f) This Ohana Dwelling permit is subject to all other applicable rules, regulations and requirements, including but not limited to those of the Planning Department, Department of Public Works, and State Department of Health.

Should you have any questions regarding the above, please feel free to contact either Masa Onuma or William Yamanoha of my staff at 961-8288.

Sincerely,

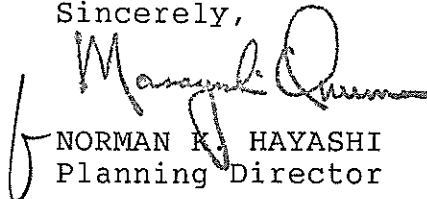
NORMAN K. HAYASHI
Planning Director

WRY:eti
4003D-5
cc: Department of Health,
Chief Sanitarian
Department of Public Works
Real Property Tax Division

SITE PLAN PROPOSED OHANA DWELLINGS
KALANI P. KINNEY
P.O. BOX 360 HOLLAND, HI 96785
967-7193
TMK - 1-1-10-59-935
11TH ST MAUNALOHA ESTATES PUNA

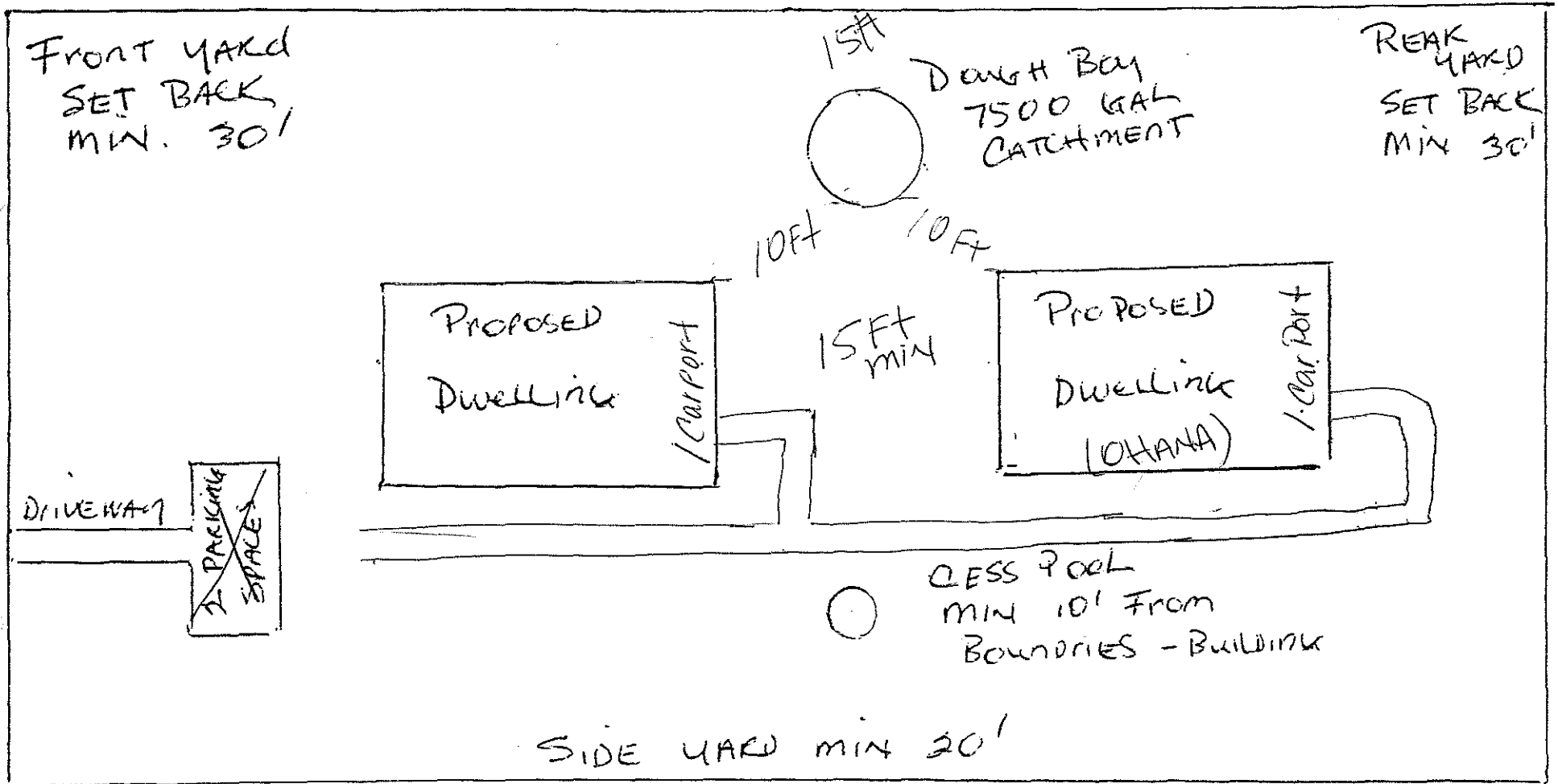

SCALE 1/4" = 5'