

January 15, 1992

Mr. and Mrs. Bryan T. Miller, Sr.  
P.O. Box 491  
Hauula, Hawaii 96717

Dear Mr. and Mrs. Miller:

Ohana Dwelling Permit (OD 91-575) 2578  
Tax Map Key: 1-6-09:304, Lot 42

The subject application has been reviewed by the concerned agencies and note:

1. The subject tax map key parcel is served by an acceptable street;
2. The subject application can meet with the State Department of Health wastewater treatment and disposal systems requirements;
3. The copy of document(s) received relating to subject tax map key parcel to establish title and exhibits contained therein do not include any deed restriction or covenant to prohibit construction of requested ohana dwelling; and,
4. The site plan denotes two off-street parking stalls on the property.

In view of the above, by this letter, you are hereby granted permission to construct the Ohana Dwelling, subject to the following condition(s):

- (a) The building permit for the Ohana Dwelling shall be secured on or before January 15, 1993. It should be noted that the permit is effective for only one (1) year and should applicant fail to secure a building permit within this period, a new application must be applied for.

Please bring or attach a copy of this Permit to expedite processing the building plans and building permit application to construct the ohana dwelling.

JAN 17 1992

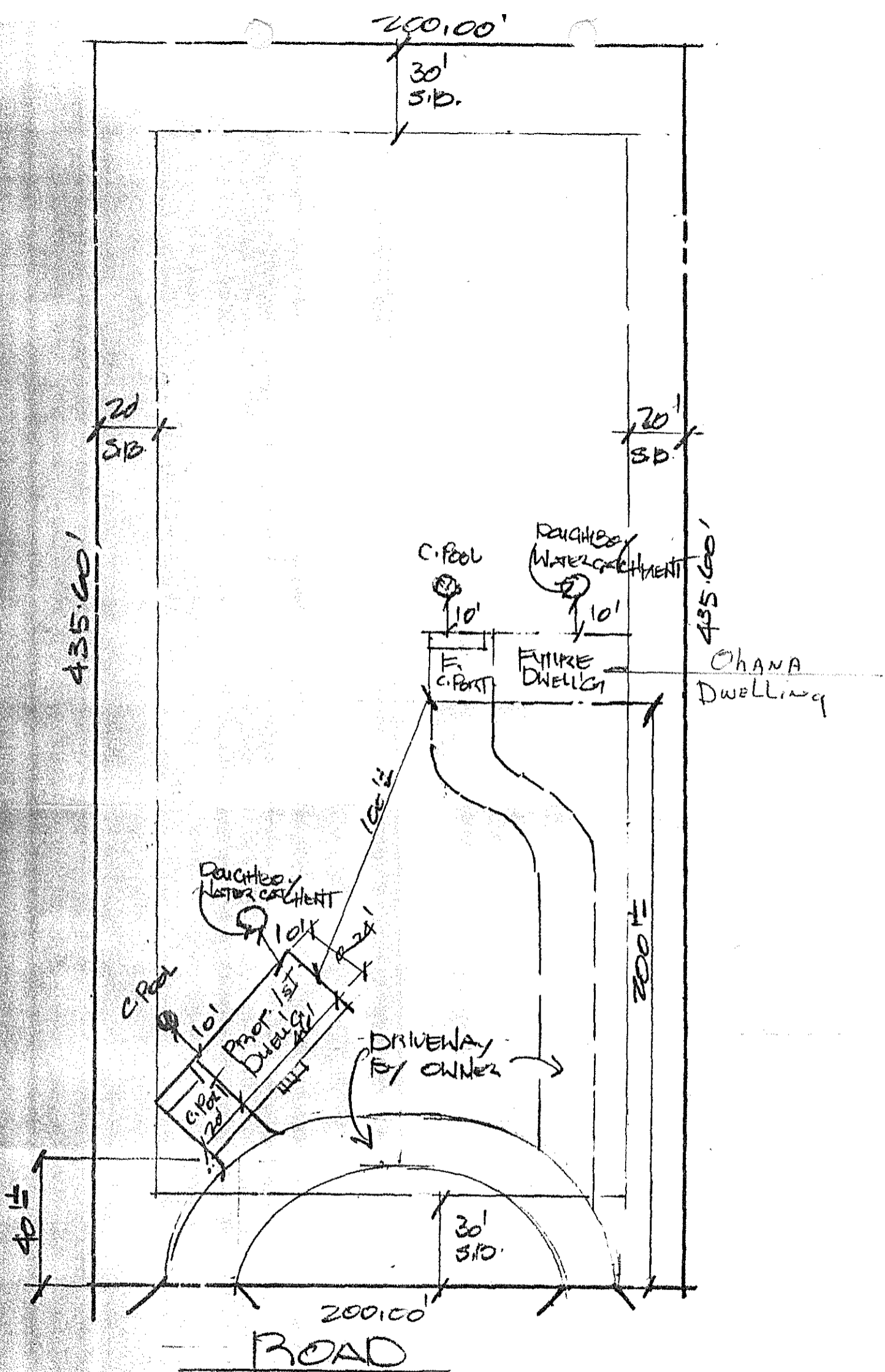

# PLOT PLAN

SCALE: 1" = 40'.0"  
 TRK: 1-6-09'304  
 AREA: 2.00 AC.