

May 21, 1992

Mr. Steven G. Nelson
P.O. Box 2267
Kealahou, HI 96750

Dear Mr. Nelson:

Ohana Dwelling Permit (OD 92-112)
Tax Map Key: 7-3-24:58, Lot 2

2695

The subject application has been reviewed by the concerned agencies and note:

1. The subject tax map key parcel is served by an acceptable street;
2. The subject application can meet with the State Department of Health wastewater treatment and disposal systems requirements;
3. The copy of document(s) received relating to subject tax map key parcel to establish title and exhibits contained therein do not include any deed restriction or covenant to prohibit construction of requested ohana dwelling; and,
4. The site plan denotes two off-street parking stalls on the property.

In view of the above, by this letter, you are hereby granted permission to construct the Ohana Dwelling, subject to the following condition(s):

- (a) The building permit for the Ohana Dwelling shall be secured on or before May 21, 1993. It should be noted that the permit is effective for only one (1) year and should applicant fail to secure a building permit within this period, a new application must be applied for.

Please bring or attach a copy of this Permit to expedite processing the building plans and building permit application to construct the ohana dwelling.

- (b) Off-street parking space for two vehicles is designated on the submitted site plan to fulfill the off-street parking requirement. The off-street parking spaces may not be

MAY 22 1992

Mr. Steven G. Nelson
Page 2
May 21, 1992

employed for storage or other use unless and until approved alternative on-site parking arrangements are established.

- (c) All construction drawings together with approved site plan drawn to scale submitted with the ohana dwelling building permit application shall denote location and identify required two (2) off-street parking spaces.
- (d) The ohana dwelling shall conform to all requirements of codes and statutes pertaining to access and building construction. Please refer to your copy of the Department of Public Works memorandum dated May 13, 1992.
- (e) The applicant shall conform to State Department of Health standards and regulations and following comment(s) dated May 5, 1992:

"The subject lot is located in the Critical Wastewater Disposal Area where cesspools are not allowed because of water pollution concerns. Any development on this lot would require all wastewater be disposed into a Treatment Individual Wastewater System.

This is based on the proposal of two new dwellings as indicated on the application form submitted."

Please contact the Chief Sanitarian's Office, Ph. 933-4275 for additional information.

- (f) This Ohana Dwelling permit is subject to all other applicable rules, regulations and requirements, including but not limited to those of the Planning Department, Department of Public Works, and State Department of Health.

Should you have any questions regarding the above, please feel free to contact either Masa Onuma or William Yamanoha of my staff.

Sincerely,



NORMAN K. HAYASHI
Planning Director

GB:eti
5356D-7
cc: Department of Health,
Chief Sanitarian
Department of Public Works
Real Property Tax Division - Kona
West Hawaii Office

SITE PLAN

1" = 60'-0"

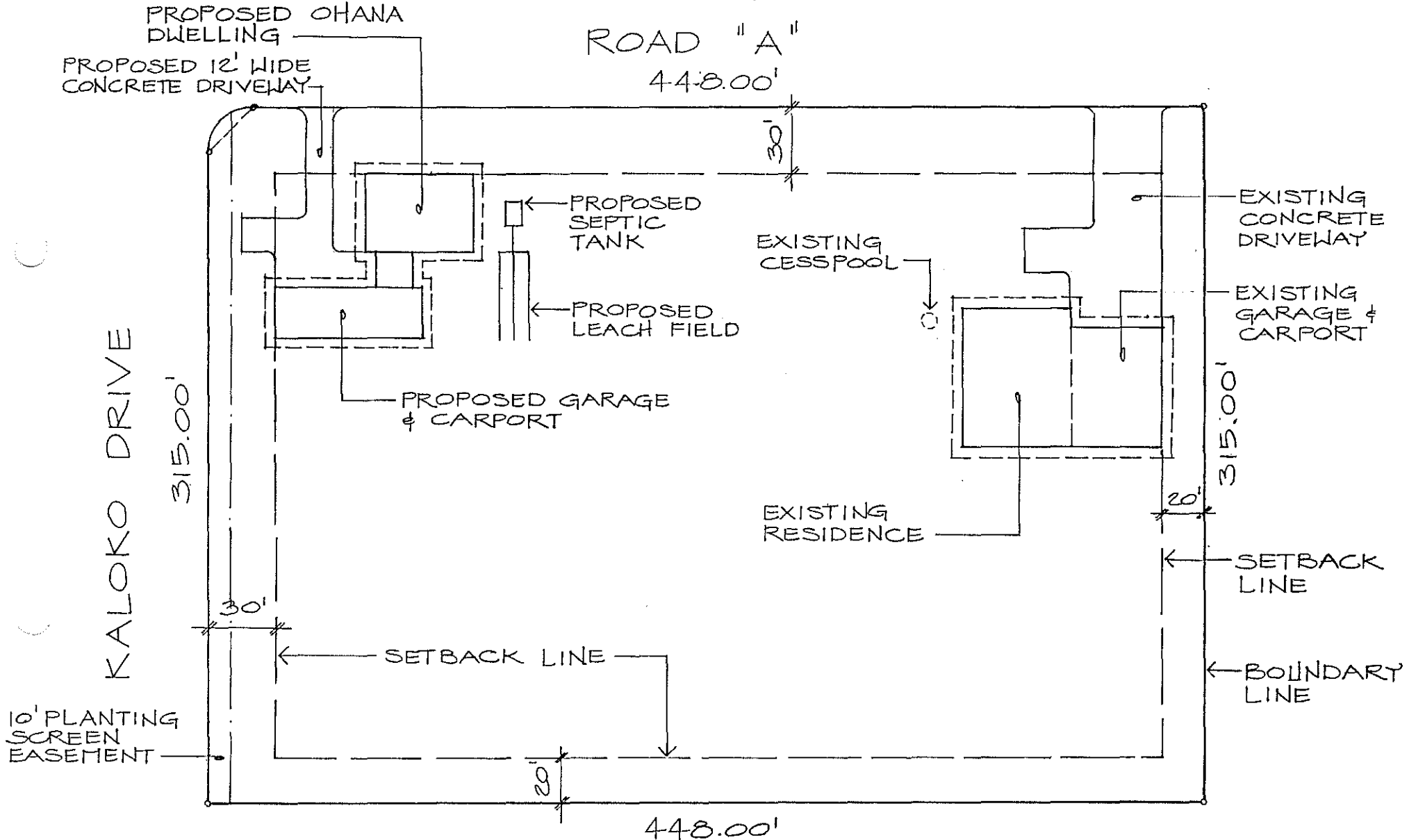
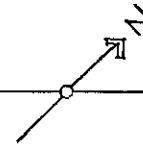
T.M.K.: 1-3-24-58 LOT#: 2



MR. & MRS. THOMAS J. STEELE

T.M.K.: 1-3-24-58
KALOKO

LOT #: 2
NORTH KONA

KALOKO MAUKA SUBDIVISION
ISLE AND COUNTY OF HAWAII