

June 4, 1992

Harry & Marlene Ching  
1142 Zurich Ct.  
San Jose, CA 95132

Dear Mr. and Mrs. Ching:

Ohana Dwelling Permit (OD 92-143) 2719  
Tax Map Key: 5-5-3:32, Lot 40

The subject application has been reviewed by the concerned agencies and note:

1. The subject tax map key parcel is served by an acceptable street;
2. The subject application can meet with the State Department of Health wastewater treatment and disposal systems requirements;
3. The copy of document(s) received relating to subject tax map key parcel to establish title and exhibits contained therein do not include any deed restriction or covenant to prohibit construction of requested ohana dwelling; and,
4. The site plan denotes two off-street parking stalls on the property.

In view of the above, by this letter, you are hereby granted permission to construct the Ohana Dwelling (Two New Single Family Dwellings), subject to the following condition(s):

- (a) The building permit for the Ohana Dwelling shall be secured on or before June 4, 1993. It should be noted that the permit is effective for only one (1) year and should applicant fail to secure a building permit within this period, a new application must be applied for.

Please bring or attach a copy of this Permit to expedite processing the building plans and building permit application to construct the ohana dwelling.

JUN 15 1992

Harry and Marlene Ching  
Page 2  
June 4, 1992

- (b) Off-street parking space for two vehicles is designated on the submitted site plan to fulfill the off-street parking requirement. The off-street parking spaces may not be employed for storage or other use unless and until approved alternative on-site parking arrangements are established.
- (c) All construction drawings together with approved site plan drawn to scale submitted with the ohana dwelling building permit application shall denote location and identify required two (2) off-street parking spaces.
- (d) The ohana dwelling shall conform to all requirements of codes and statutes pertaining to access and building construction. Please refer to your copy of the Department of Public Works memorandum dated June 1, 1992.
- (e) The applicant shall conform to State Department of Health standards and regulations and following comment(s) dated May 19, 1992:  
  
"The subject lot size of 15,022 square feet would support only one cesspool. The cesspool may service two dwelling units with a total of five (5) bedrooms. Please contact our office, Ph. 933-4371 for additional information."
- (f) This Ohana Dwelling permit is subject to all other applicable rules, regulations and requirements, including but not limited to those of the Planning Department, Department of Public Works, and State Department of Health.

Should you have any questions regarding the above, please feel free to contact either Masa Onuma or William Yamanoha of my staff at 961-8288.

Sincerely,

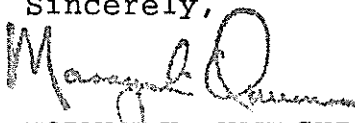

NORMAN K. HAYASHI  
Planning Director

GB:eti  
5482D-5  
cc: Department of Health,  
Chief Sanitarian  
Department of Public Works  
Real Property Tax Division  
West Hawaii Office

OHANA DWELLING APPLICATION  
PETITIONER: Harry & Marlene  
Ching  
TMK: 5-5-03: 32, Lot 40  
Zoning: A-20a  
Land Area: 15,022 s.f.

Site Plan:  
Scale: 1 inch = 20 feet

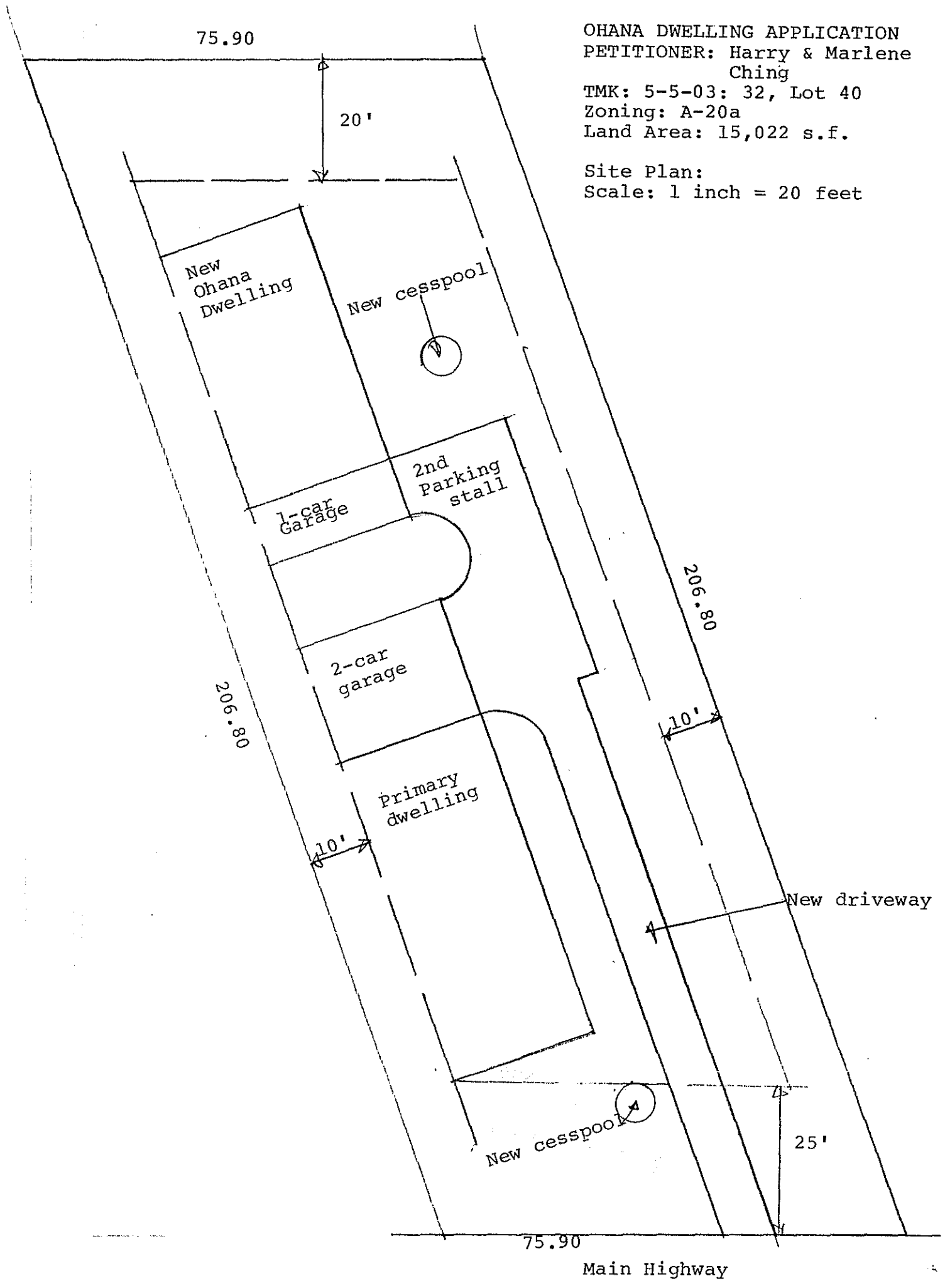

Dell  
0092-142