

July 7, 1992

Ms. Vicky Block  
P.O. Box 1599  
Keaau, Hawaii 96749

Dear Ms. Block:

Ohana Dwelling Permit (OD 92-186) 2768  
Tax Map Key: 1-6-85:62, Lot 1

The subject application has been reviewed by the concerned agencies and note:

1. The subject tax map key parcel is served by an acceptable street;
2. The subject application can meet with the State Department of Health wastewater treatment and disposal systems requirements;
3. The copy of document(s) received May 29 and July 1, 1992, relating to subject tax map key parcel to establish title and exhibits contained therein do not include any deed restriction or covenant to prohibit construction of requested ohana dwelling; and,
4. The site plan denotes two off-street parking stalls on the property.

In view of the above, by this letter, you are hereby granted permission to construct the Ohana Dwelling, subject to the following condition(s):

- (a) The building permit for the Ohana Dwelling shall be secured on or before July 7, 1993. It should be noted that the permit is effective for only one (1) year and should applicant fail to secure a building permit within this period, a new application must be applied for.

Please bring or attach a copy of this Permit to expedite processing the building plans and building permit application to construct the ohana dwelling.

JUL 8 1992

Ms. Vicky Block  
Page 2  
July 7, 1992

- (b) Off-street parking space for two vehicles is designated on the submitted site plan to fulfill the off-street parking requirement. The off-street parking spaces may not be employed for storage or other use unless and until approved alternative on-site parking arrangements are established.
- (c) All construction drawings together with approved site plan drawn to scale submitted with the ohana dwelling building permit application shall denote location and identify required two (2) off-street parking spaces.
- (d) The ohana dwelling shall conform to all requirements of codes and statutes pertaining to access and building construction.
- (e) The applicant shall conform to State Department of Health standards and regulations and following comment(s) dated June 30, 1992:

"The subject lot is located in the Critical Wastewater Area where cesspools are not allowed because of water pollution concerns. Any development on this lot would require all wastewater be disposed into treatment Individual Wastewater Systems."

Please contact the Chief Sanitarian's Office, Ph. 933-4275 for additional information.

- (f) This Ohana Dwelling permit is subject to all other applicable rules, regulations and requirements, including but not limited to those of the Planning Department, Department of Public Works, and State Department of Health.

Should you have any questions regarding the above, please feel free to contact William Yamanoha of my staff at 961-8288.

Sincerely,



NORMAN K. HAYASHI  
Planning Director

WRY:eti  
5787D-7

cc: Department of Health,  
Chief Sanitarian  
Department of Public Works  
Real Property Tax Division

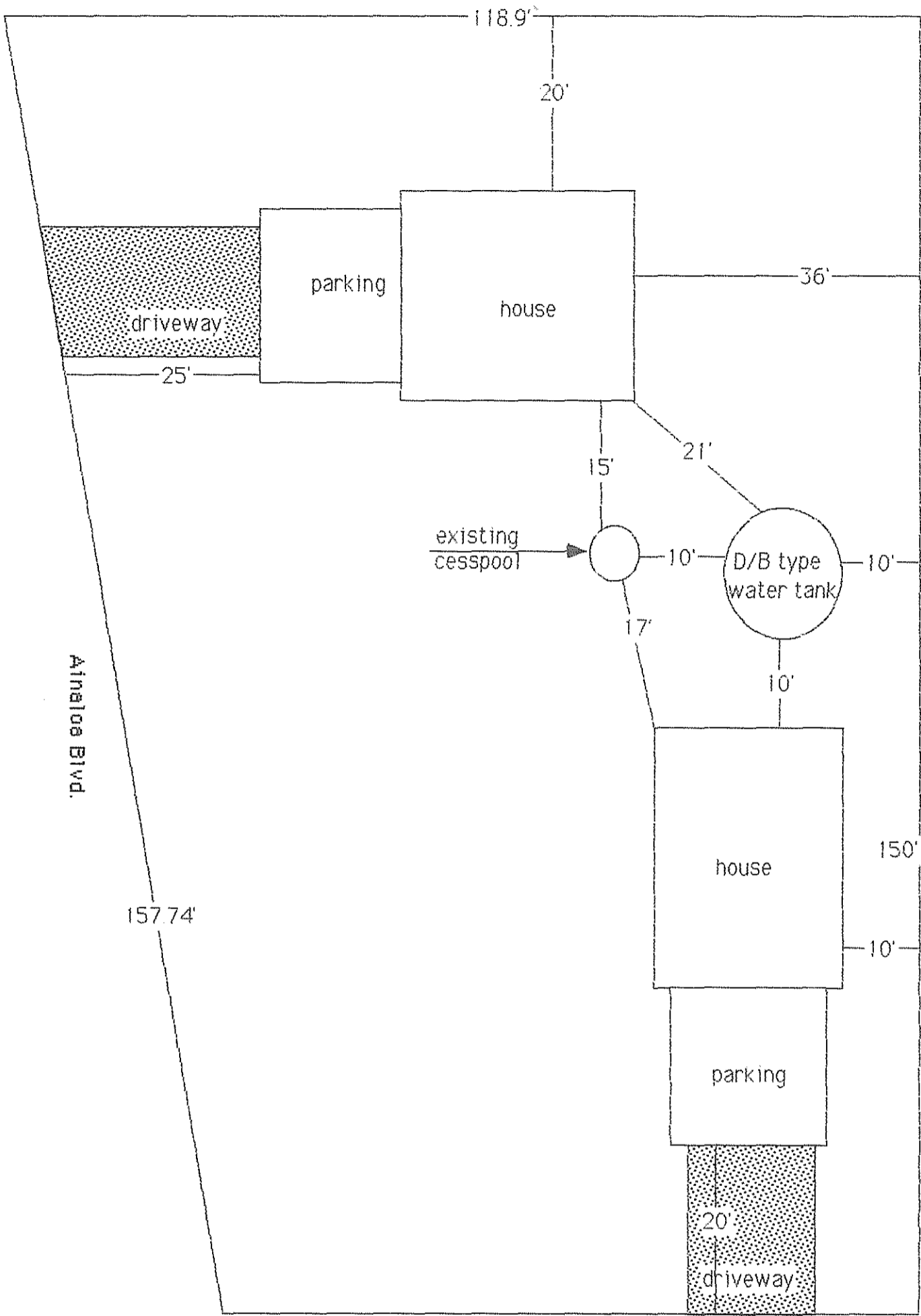

Uilani Drive  
scale 1" = 15'

OWNER	_____
ADDRESS	_____
	_____
TMK	_____
STREET	_____
SUBDIVISION	_____