

September 8, 1992

Mr. Harvey Hakoda
765 Amana St. #510
Honolulu, HI 96814

Dear Mr. Hakoda:

Ohana Dwelling Permit (OD 92-220) 2819
Tax Map Key: 2-1-17:35

The subject application has been reviewed by the concerned agencies and note:

1. The subject tax map key parcel is served by an acceptable street;
2. The subject application can meet with the State Department of Health wastewater treatment and disposal systems requirements;
3. The copy of document(s) received relating to subject tax map key parcel to establish title and exhibits contained therein do not include any deed restriction or covenant to prohibit construction of requested ohana dwelling; and,
4. The site plan denotes two off-street parking stalls on the property.

In view of the above, by this letter, you are hereby granted permission to construct the Ohana Dwelling (Two New Single Family Dwelling), subject to the following condition(s):

- (a) The building permit for the Ohana Dwelling shall be secured on or before September 8, 1993. It should be noted that the permit is effective for only one (1) year and should applicant fail to secure a building permit within this period, a new application must be applied for.

Please bring or attach a copy of this Permit to expedite processing the building plans and building permit application to construct the ohana dwelling.

SEP 9 1992

Mr. Harvey Hakoda
Page 2
September 8, 1992

- (b) Off-street parking space for two vehicles is designated on the submitted site plan to fulfill the off-street parking requirement. The off-street parking spaces may not be employed for storage or other use unless and until approved alternative on-site parking arrangements are established.
- (c) All construction drawings together with approved site plan drawn to scale submitted with the ohana dwelling building permit application shall denote location and identify required two (2) off-street parking spaces.
- (d) The applicant must comply with established flood regulations. Please refer to your copy of the Department of Public Works memorandum dated August 20, 1992.
- (e) The ohana dwelling shall conform to all requirements of codes and statutes pertaining to access and building construction.
- (f) The applicant shall conform to State Department of Health standards and regulations and following comment(s) dated July 31, 1992:

"The subject lot is located in the Critical Wastewater Disposal Area. The Department of Health would support any sewer requirements made by the County of Hawaii. If it is determined that the sewer line is not accessible, any developments on lots would require all wastewater be disposed into Treatment Individual Wastewater System."

- (g) This Ohana Dwelling permit is subject to all other applicable rules, regulations and requirements, including but not limited to those of the Planning Department, Department of Public Works, and State Department of Health.

Should you have any questions regarding the above, please feel free to contact Gilbert Bailado of my staff at 961-8288.

Sincerely,

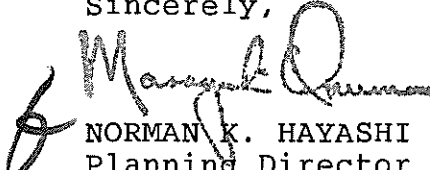
NORMAN K. HAYASHI
Planning Director

GB:eti
6395D-3
cc: Department of Health,
Chief Sanitarian
Department of Public Works
Real Property Tax Division

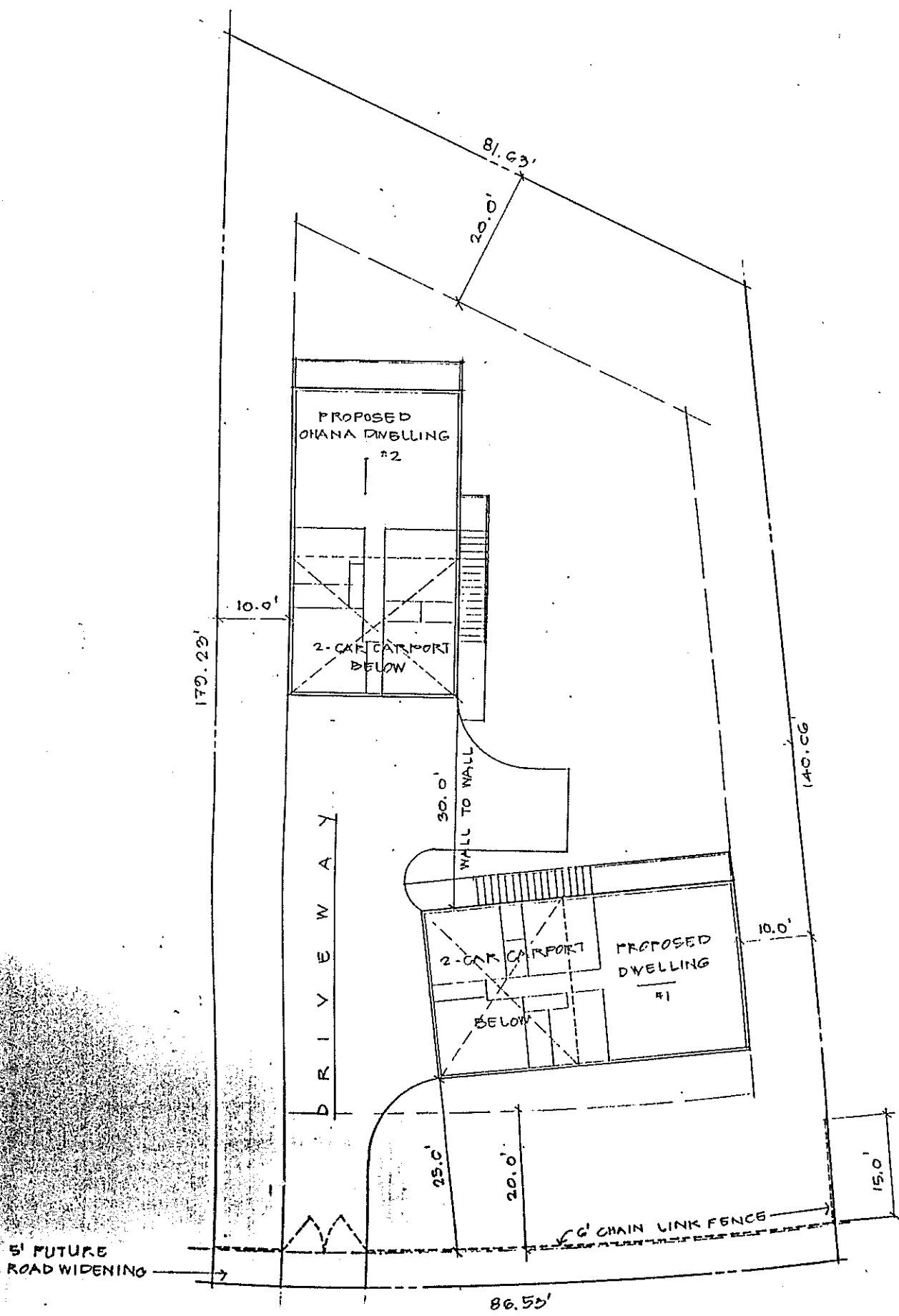

KALANIANA'OLE ST.

MR. HARVEY HAKODA
 WAIKĀEA, KĀUAIKAHA, HILO, HI.
 TMK: 2-1-17:35 LOT: 69

LOT AREA: 12,687 sq

PLOT PLAN
 SO: 1" = 20.00'