

August 24, 1992

Mr. Allyn T. Albrechtson
15-1230 Kaloli Drive
Keaau, Hawaii 96749

Dear Mr. Albrechtson:

Ohana Dwelling Application (OD 92-222) 2800
Tax Map Key: 1-5-52:73, Lot 2051

The subject application has been reviewed by the concerned agencies and note:

1. The subject tax map key parcel is served by an acceptable street;
2. The subject application can meet with the State Department of Health wastewater treatment and disposal systems requirements;
3. The copy of document(s) received relating to subject tax map key parcel to establish title and exhibits contained therein do not include any deed restriction or covenant to prohibit construction of requested ohana dwelling; and,
4. The site plan denotes two off-street parking stalls on the property.

In view of the above, by this letter, you are hereby granted permission to construct the Ohana Dwelling (DUPLEX CONVERSION), subject to the following condition(s):

- (a) 1. Please complete and return Cancellation of Agreement form together with \$20.00 check payable to the Bureau of Conveyances prior to submission of the building permit application for the Duplex Conversion.
- (a) 2. The building permit for the Ohana Dwelling shall be secured on or before August 24, 1993. If the applicant and/or owner fails to secure a building permit within one (1) year of the date of this letter,

AUG 26 1992

Mr. Allyn T. Albrechtson
Page 2
August 24, 1992

permission to construct the subject ohana dwelling shall be deemed void. A time extension may be granted for good cause, provided, the permittee and/or owner applies in writing at least forty-five (45) calendar days before the expiration of the one (1) year period.

Please bring or attach a copy of this Permit to expedite processing the building plans and building permit application to construct the ohana dwelling.

- (b) Off-street parking space for two vehicles is designated on the submitted site plan to fulfill the off-street parking requirement. The off-street parking spaces may not be employed for storage or other use unless and until approved alternative on-site parking arrangements are established.
- (c) All construction drawings together with approved site plan drawn to scale submitted with the ohana dwelling building permit application shall denote location and identify required two (2) off-street parking spaces.
- (d) The ohana dwelling shall conform to all requirements of codes and statutes pertaining to access and building construction.
- (e) The applicant shall conform to State Department of Health standards and regulations.
- (f) This Ohana Dwelling permit is subject to all other applicable rules, regulations and requirements, including but not limited to those of the Planning Department, Department of Public Works, and State Department of Health.

Should you have any questions regarding the above, please feel free to contact William Yamanoha of my staff at 961-8288.

Sincerely,

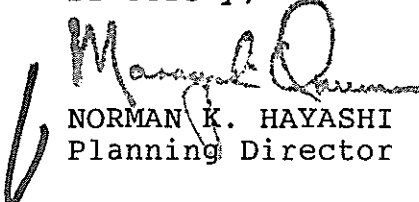
NORMAN K. HAYASHI
Planning Director

WRY:eti
6274D-3
cc: Department of Health,
Chief Sanitarian
Department of Public Works
Real Property Tax Division

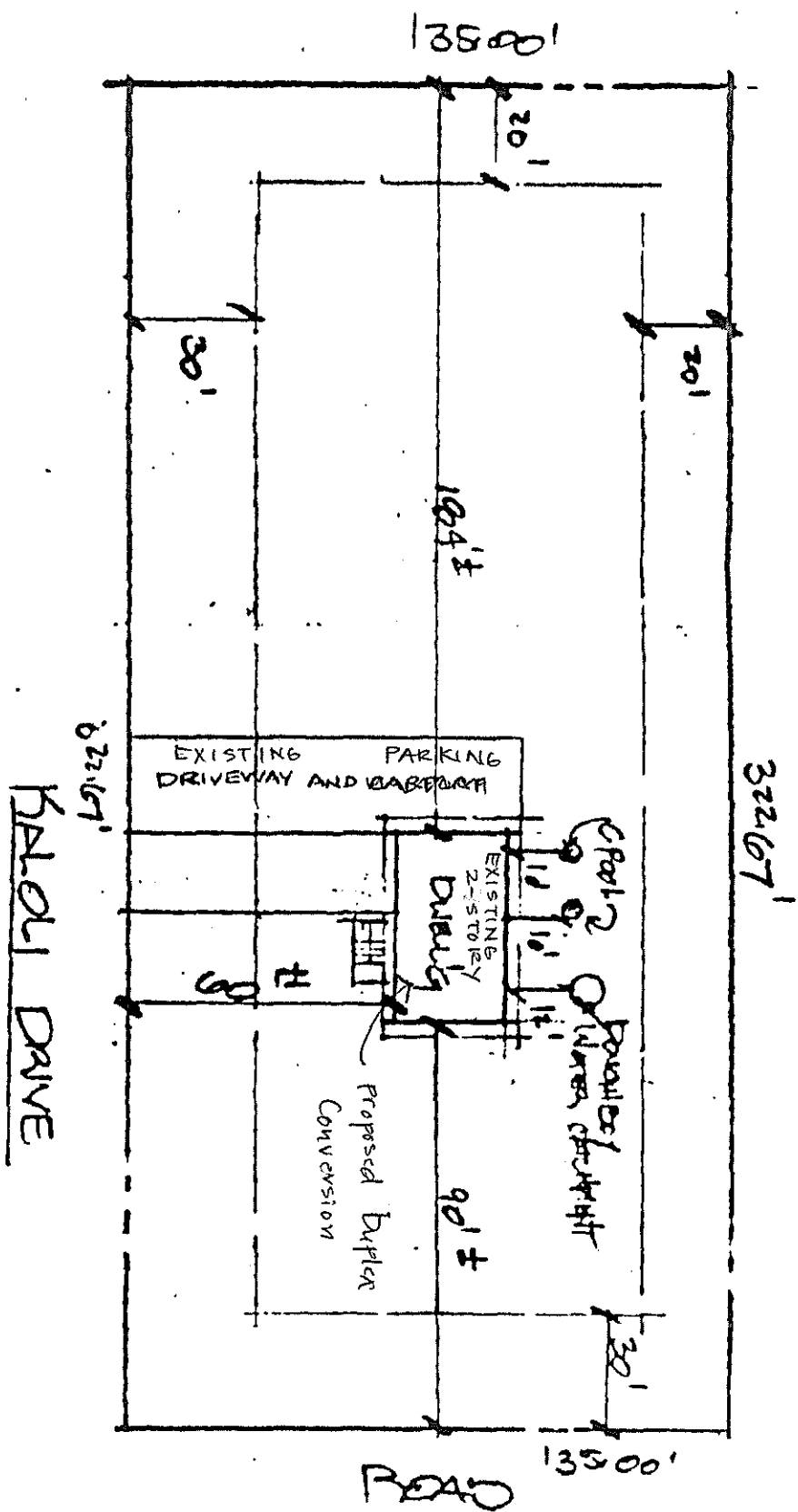
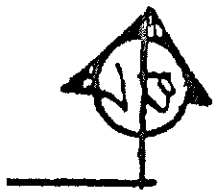

1.1 "

HALOOL C