

December 18, 1992

Mr. Robert E. Oliver, III  
209 Kinoole Street, Suite 8  
Hilo, HI 96720

Dear Mr. Oliver:

Ohana Dwelling Permit (OD 92-347)  
Tax Map Key: 1-7-27:143, Lot 199

2929

The subject application has been reviewed by the concerned agencies and note:

1. The subject tax map key parcel is served by an acceptable street;
2. The subject application can meet with the State Department of Health wastewater treatment and disposal systems requirements;
3. The copy of document(s) received relating to subject tax map key parcel to establish title and exhibits contained therein do not include any deed restriction or covenant to prohibit construction of requested ohana dwelling; and,
4. The site plan denotes two off-street parking stalls on the property.

In view of the above, by this letter, you are hereby granted permission to construct the Ohana Dwelling (additional single family dwelling), subject to the following condition(s):

- (a) The building permit for the Ohana Dwelling shall be secured on or before December 18, 1993. It should be noted that the permit is effective for only one (1) year and should applicant fail to secure a building permit within this period, a new application must be applied for.

Please bring or attach a copy of this Permit to expedite processing the building plans and building permit application to construct the ohana dwelling.

DEC 22 1992

Mr. Robert E. Oliver, III  
Page 2  
December 18, 1992

- (b) Off-street parking space for two vehicles is designated on the submitted site plan to fulfill the off-street parking requirement. The off-street parking spaces may not be employed for storage or other use unless and until approved alternative on-site parking arrangements are established.
- (c) All construction drawings together with approved site plan drawn to scale submitted with the ohana dwelling building permit application shall denote location and identify required two (2) off-street parking spaces.
- (d) The ohana dwelling shall conform to all requirements of codes and statutes pertaining to access and building construction.
- (e) The applicant shall conform to State Department of Health standards and regulations and following comment(s) dated November 12, 1992:

"The land area of one acre would support only one cesspool. This cesspool may service two dwelling units with a total of five (5) bedrooms. If the ohana dwelling cannot be serviced by the existing cesspool a septic tank system is required within this one acre critical wastewater disposal area. If there is need to discuss please call the Chief Sanitarian's office. Ph. 933-4275."

- (f) This Ohana Dwelling permit is subject to all other applicable rules, regulations and requirements, including but not limited to those of the Planning Department, Department of Public Works, and State Department of Health.

Should you have any questions regarding the above, please feel free to contact Gilbert Bailado of my staff at 961-8288.

Sincerely,

  
VIRGINIA H. GOLDSTEIN  
Planning Director

GB:mjh  
7398D(3)  
cc: Department of Health,  
Chief Sanitarian  
Department of Public Works  
Real Property Tax Division

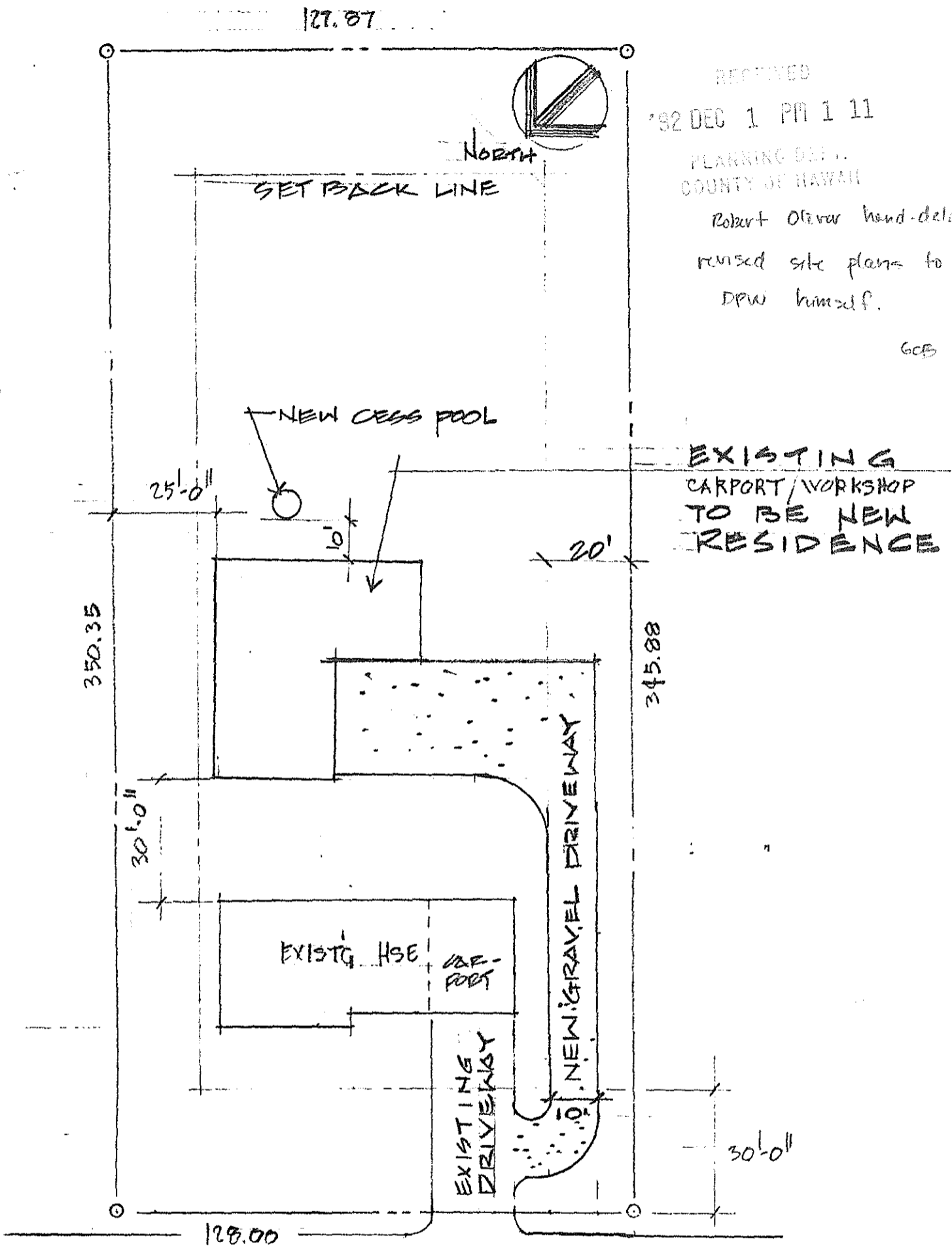

RECEIVED  
 '92 DEC 1 PM 1 11

PLANNING DEPT.  
 COUNTY OF HAWAII

Robert Oliver hand-delivered  
 revised site plans to  
 DPW himself.

GCB

# SITE PLAN

SCALE: 1" = 30'-0"

REVISED 1 DEC 92 REC

92-347