

February 9, 1993

Ms. Sandy Saint John
430 W. Kawili St. 13-D
Hilo, HI 96720

Dear Ms. Saint John:

Ohana Dwelling Permit (OD 92-410)
Tax Map Key: 1-5-44:87, Lot 477

3000

The subject application has been reviewed by the concerned agencies and note:

1. The subject tax map key parcel is served by an acceptable street;
2. The subject application can meet with the State Department of Health wastewater treatment and disposal systems requirements;
3. The copy of document(s) received relating to subject tax map key parcel to establish title and exhibits contained therein do not include any deed restriction or covenant to prohibit construction of requested ohana dwelling; and,
4. The site plan denotes two off-street parking stalls on the property.

In view of the above, by this letter, you are hereby granted permission to construct the Ohana Dwelling (Two New Single Family Dwellings), subject to the following condition(s):

- (a) The building permit for the Ohana Dwelling shall be applied for and secured from the Department of Public Works, Building Division on or before February 9, 1994. It should be noted that the permit is effective for only one (1) year and should applicant fail to secure a building permit within this period, a new application must be applied for.

Please bring or attach a copy of this Permit to expedite processing the building plans and building permit application to construct the ohana dwelling.

FEB 10 1993

Ms. Sandy Saint John
Page 2
February 9, 1993

- (b) Off-street parking space for two vehicles is designated on the submitted site plan to fulfill the off-street parking requirement. The off-street parking spaces may not be employed for storage or other use unless and until approved alternative on-site parking arrangements are established.
- (c) All construction drawings together with approved site plan drawn to scale submitted with the ohana dwelling building permit application shall denote location and identify required two (2) off-street parking spaces.
- (d) The ohana dwelling shall conform to all requirements of codes and statutes pertaining to access and building construction.
- (e) The applicant shall conform to State Department of Health standards and regulations and following comment(s) dated January 13, 1993:

"The subject lot size of 1.36 acres would support only one cesspool. The cesspool may service two dwelling units with a total of five (5) bedrooms. Please contact our office, ph. 933-4371 for additional information."
- (f) This Ohana Dwelling permit is subject to all other applicable rules, regulations and requirements, including but not limited to those of the Planning Department, Department of Public Works, and State Department of Health.

Should you have any questions regarding the above, please feel free to contact Gilbert Bailado of my staff at 961-8288.

Sincerely,

VIRGINIA H. GOLDSTEIN
Planning Director

GB:mjs
7935D (4)

cc: Department of Health,
Chief Sanitarian
Department of Public Works
Real Property Tax Division - Hilo

22811

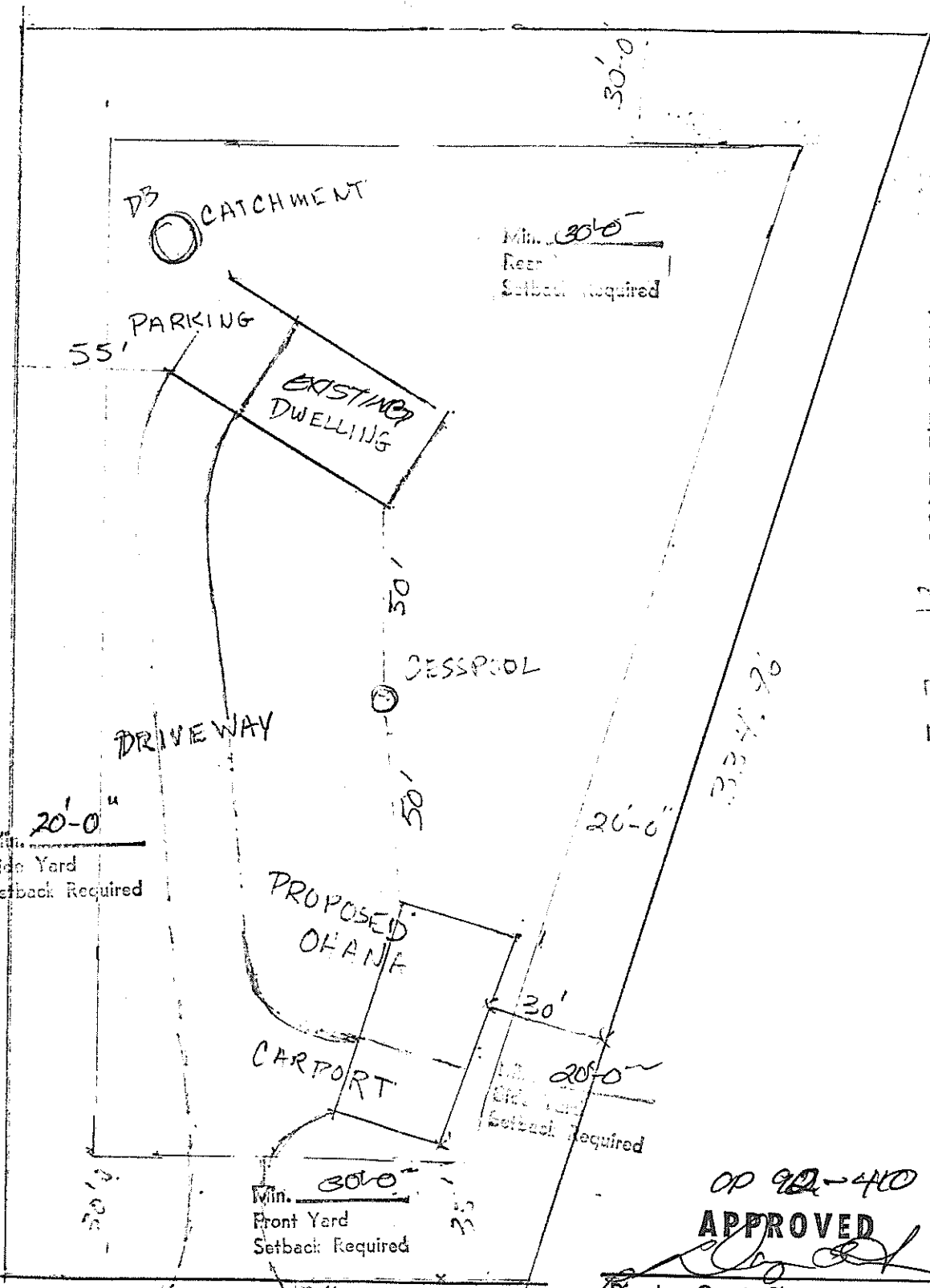

DEPARTMENT OF
ENGINEERING

DRIVEWAY: IN ACCORDANCE WITH CHAPTER 22 OF THE COUNTY CODE, A PERMIT SHALL BE REQUIRED FOR DRIVEWAY CONSTRUCTION WITHIN THE COUNTY.

GRADING: ALL EARTHWORK SHALL CONFORM TO CHANGES TO THE HAWAII COUNTY CODE BE REQUIRED FOR LOCAL GRADING.

DRAINAGE: NO ADDITIONAL RUNOFF GENERATED BY THE PROPOSED DEVELOPMENT SHALL BE DISPOSED IN NEIGHBORING ROADWAYS OR ADJACENT PROPERTIES. ALL DRAINAGE IMPROVEMENTS SHALL CONFORM TO CHAPTER 22 OF THE COUNTY CODE.

ENGINEERING

REVIEWED BY: _____
DATE: 11/5/93

322.67

20'-0"

OP 92-410

APPROVED

[Signature]
Director, County Planning Department

Date: 11/5/93

138.77