

April 30, 1993

John F. and Eiko M. Moore  
HCR 2, Box 9582  
Keaau, HI 96749

Dear Mr. and Mrs. Moore::

Ohana Dwelling Permit (OD 93-116) 3130  
Tax Map Key: 1-5-60:78, Lot 319

The subject application has been reviewed by the concerned agencies and note:

1. The subject tax map key parcel is served by an acceptable street;
2. The subject application can meet with the State Department of Health wastewater treatment and disposal systems requirements;
3. The copy of document(s) received relating to subject tax map key parcel to establish title and exhibits contained therein do not include any deed restriction or covenant to prohibit construction of requested ohana dwelling; and,
4. The site plan denotes two off-street parking stalls on the property.

In view of the above, by this letter, you are hereby granted permission to construct the Ohana Dwelling (Additional Single Family Dwelling), subject to the following condition(s):

- (a) The building permit for the Ohana Dwelling shall be applied for and secured from the Department of Public Works, Building Division on or before April 30, 1994. It should be noted that the permit is effective for only one (1) year and should applicant fail to secure a building permit within this period, a new application must be applied for.

Please bring or attach a copy of this Permit to expedite processing the building plans and building permit application to construct the ohana dwelling.

MAY 04 1993

Mr. and Mrs. John Moore  
Page 2  
April 30, 1993

- (b) Off-street parking space for two vehicles is designated on the submitted site plan to fulfill the off-street parking requirement. The off-street parking spaces may not be employed for storage or other use unless and until approved alternative on-site parking arrangements are established.
- (c) All construction drawings together with approved site plan drawn to scale submitted with the ohana dwelling building permit application shall denote location and identify required two (2) off-street parking spaces.
- (d) The ohana dwelling shall conform to all requirements of codes and statutes pertaining to access and building construction.
- (e) The applicant shall conform to State Department of Health standards and regulations and following comment(s) dated March 31, 1993:

"The subject proposal is located in a Critical Wastewater Disposal Area. The existing cesspool may service a total of 1,000 gallons per day of wastewater. A total of five bedrooms are allowed in the two dwelling units. A second cesspool is not allowed. A septic tanks system designed by a Registered Professional Engineer in the State of Hawaii may be utilized."

- (f) This Ohana Dwelling permit is subject to all other applicable rules, regulations and requirements, including but not limited to those of the Planning Department, Department of Public Works, and State Department of Health.

Should you have any questions regarding the above, please feel free to contact Gilbert Bailado of my staff at 961-8288.

Sincerely,

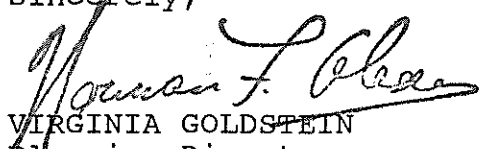
  
VIRGINIA GOLDSTEIN  
Planning Director

GB:mjs  
8914D (1)

xc: Department of Health,  
Chief Sanitarian  
Department of Public Works  
Real Property Tax Division - Hilo

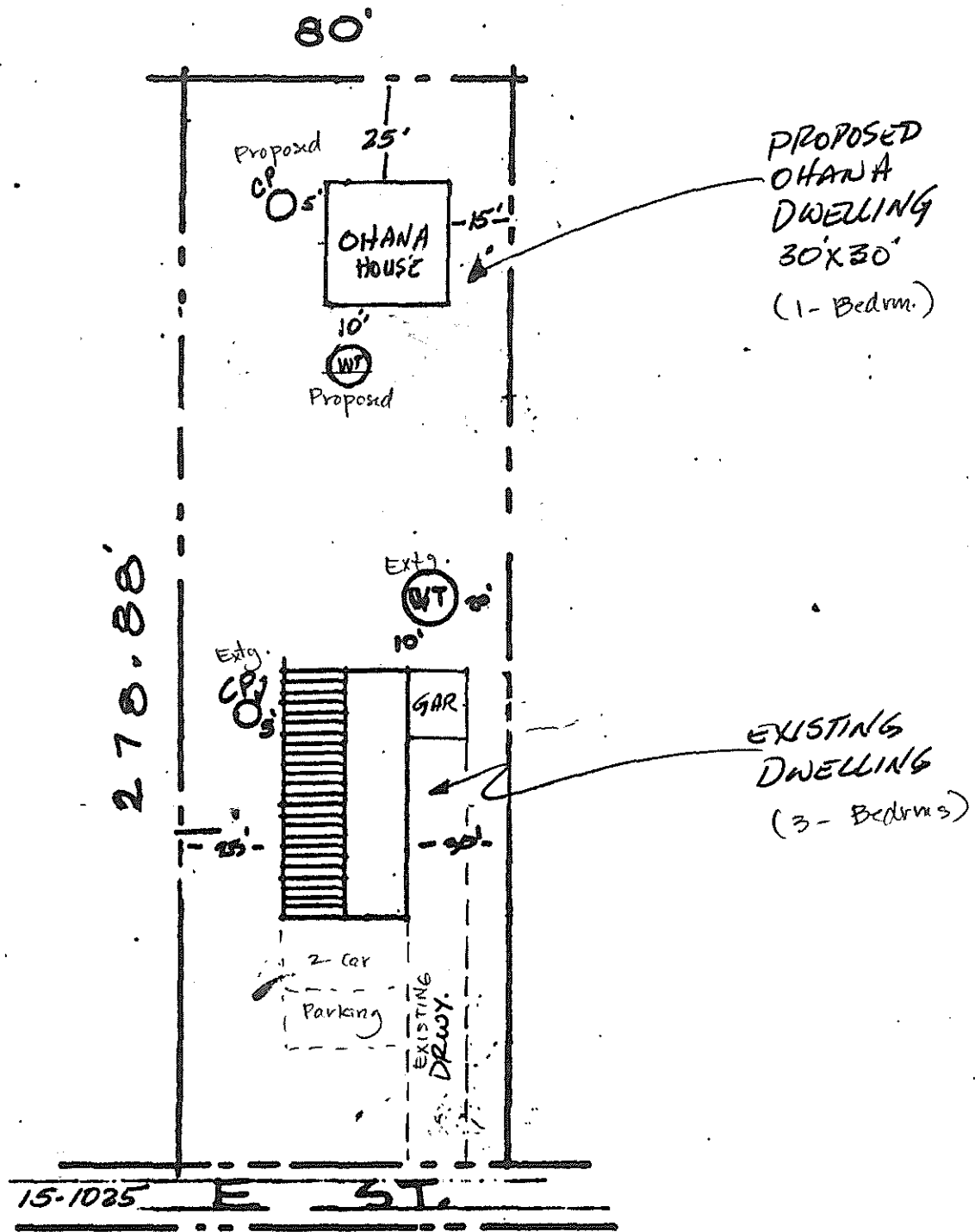

**PLOT PLAN 1"=40'**

PROPOSED OHANA HOUSE  
 JOHN F. MOORE  
 966-4814

15-1025 E ST.  
 KEAAU, PUNA, HI 96749  
 (3) 1-5-60-78