

June 4, 1993

Gerald R. and Almarie N.L. Stothers
47-552 Hua Place
Kaneohe, HI 96744

Dear Mr. and Ms. Stothers:

Ohana Dwelling Permit (OD 93-156) 3162
Tax Map Key: 6-5-9:81, Lot 6 B-7

The subject application has been reviewed by the concerned agencies and note:

1. The subject tax map key parcel is served by an acceptable street;
2. The subject application can meet with the State Department of Health wastewater treatment and disposal systems requirements;
3. The copy of document(s) received relating to subject tax map key parcel to establish title and exhibits contained therein do not include any deed restriction or covenant to prohibit construction of requested ohana dwelling; and,
4. The site plan denotes two off-street parking stalls on the property.

In view of the above, by this letter, you are hereby granted permission to construct the Ohana Dwelling (New Duplex), subject to the following condition(s):

- (a) The building permit for the Ohana Dwelling shall be applied for and secured from the Department of Public Works, Building Division on or before June 4, 1994. It should be noted that the permit is effective for only one (1) year and should applicant fail to secure a building permit within this period, a new application must be applied for.

Please bring or attach a copy of this Permit to expedite processing the building plans and building permit application to construct the ohana dwelling.

G1140
JUN 08 1993

Gerald R. and Almarie N.L. Stothers
Page 2
June 4, 1993

- (b) Off-street parking space for two vehicles is designated on the submitted site plan to fulfill the off-street parking requirement. The off-street parking spaces may not be employed for storage or other use unless and until approved alternative on-site parking arrangements are established.
- (c) All construction drawings together with approved site plan drawn to scale submitted with the ohana dwelling building permit application shall denote location and identify required two (2) off-street parking spaces.
- (d) The ohana dwelling shall conform to all requirements of codes and statutes pertaining to access and building construction.
- (e) The applicant shall conform to State Department of Health standards and regulations and following comment(s) dated May 20, 1993:

"The subject lot size of 13,030 square feet can support only one Treatment Individual Wastewater System. A total of 5 bedrooms for both dwellings is allowed."
- (f) This Ohana Dwelling permit is subject to all other applicable rules, regulations and requirements, including but not limited to those of the Planning Department, Department of Public Works, and State Department of Health.

Should you have any questions regarding the above, please feel free to contact Gilbert Bailado of my staff at 961-8288.

Sincerely,

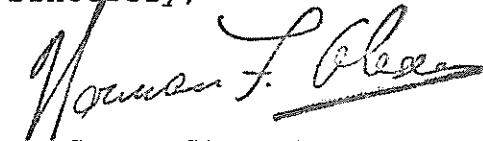

for VIRGINIA GOLDSTEIN
Planning Director

GB:mjs
9325D

xc: Department of Health,
Chief Sanitarian
Department of Public Works
Real Property Tax Division - Kona
West Hawaii Office

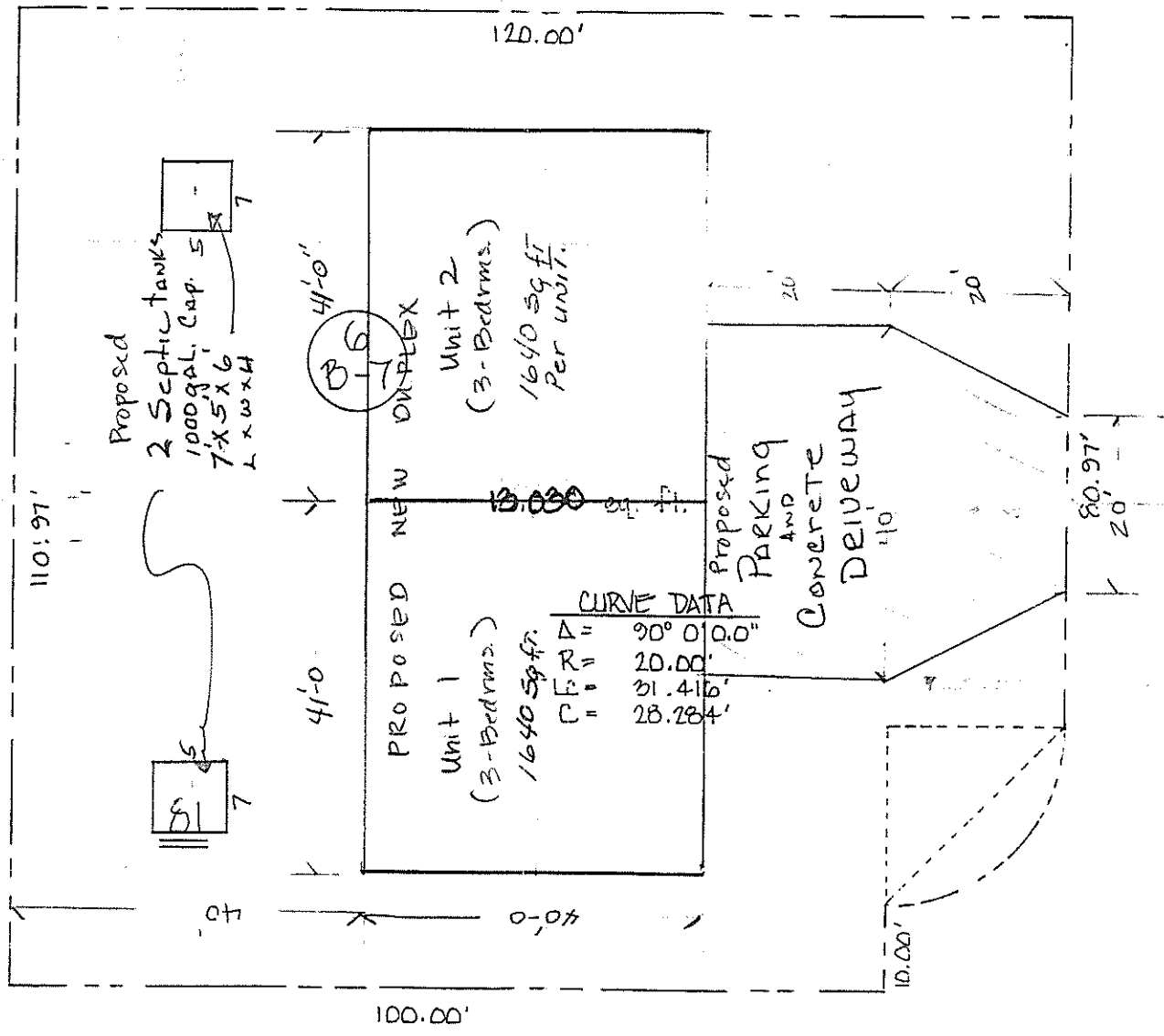

LOT 81
13,030 Sq. Ft.

YLCI PLAN
SCALE 1"=20'

TMK 3-6-5-9-81

Almarie & GERALD STOTHERS
JANUARY 21, 1982