

October 8, 1993

Mr. Cliff Ahrens  
P. O. Box 1231  
Captain Cook, HI 96704

Dear Mr. Ahrens:

Ohana Dwelling Permit (OD 93-278)  
Tax Map Key: 8-1-18:2

3285

The subject application has been reviewed by the concerned agencies and note:

1. The subject tax map key parcel is served by an acceptable street;
2. The subject application can meet with the State Department of Health wastewater treatment and disposal systems requirements;
3. The copy of document(s) received relating to subject tax map key parcel to establish title and exhibits contained therein do not include any deed restriction or covenant to prohibit construction of requested ohana dwelling; and,
4. The site plan denotes two off-street parking stalls on the property.

In view of the above, by this letter, you are hereby granted permission to construct the Ohana Dwelling (Two New Single Family Dwellings), subject to the following condition(s):

- (a) The building permit for the Ohana Dwelling shall be applied for and secured from the Department of Public Works, Building Division on or before October 8, 1994. It should be noted that the permit is effective for only one (1) year and should applicant fail to secure a building permit within this period, a new application must be applied for.

Please bring or attach a copy of this Permit to expedite processing the building plans and building permit application to construct the ohana dwelling.

07532

OCT 12 1993

Mr. Cliff Ahrens  
Page 2  
October 8, 1993

- (b) Off-street parking space for two vehicles is designated on the submitted site plan to fulfill the off-street parking requirement. The off-street parking spaces may not be employed for storage or other use unless and until approved alternative on-site parking arrangements are established.
- (c) All construction drawings together with approved site plan drawn to scale submitted with the ohana dwelling building permit application shall denote location and identify required two (2) off-street parking spaces.
- (d) The applicant must comply with established flood and driveway regulations. Please contact the Department of Public Works, Engineering Division at 961-8327.
- (e) The ohana dwelling shall conform to all requirements of codes and statutes pertaining to access and building construction.
- (f) The applicant shall conform to State Department of Health standards and regulations and following comment(s) dated September 15, 1993:

"The proposed Septic Tank System would need to be designed by a Registered Professional Engineer licensed by the State of Hawaii. Please submit the plans to our office for approval."

- (g) This Ohana Dwelling permit is subject to all other applicable rules, regulations and requirements, including but not limited to those of the Planning Department, Department of Public Works, and State Department of Health.

Should you have any questions regarding the above, please feel free to contact Gilbert Bailado of my staff at 961-8288.

Sincerely,

  
for VIRGINIA GOLDSTEIN  
Planning Director

GB:mjs  
1144D (4)

xc: Department of Health,  
Chief Sanitarian  
Department of Public Works  
Real Property Tax Division - Kona  
West Hawaii Office

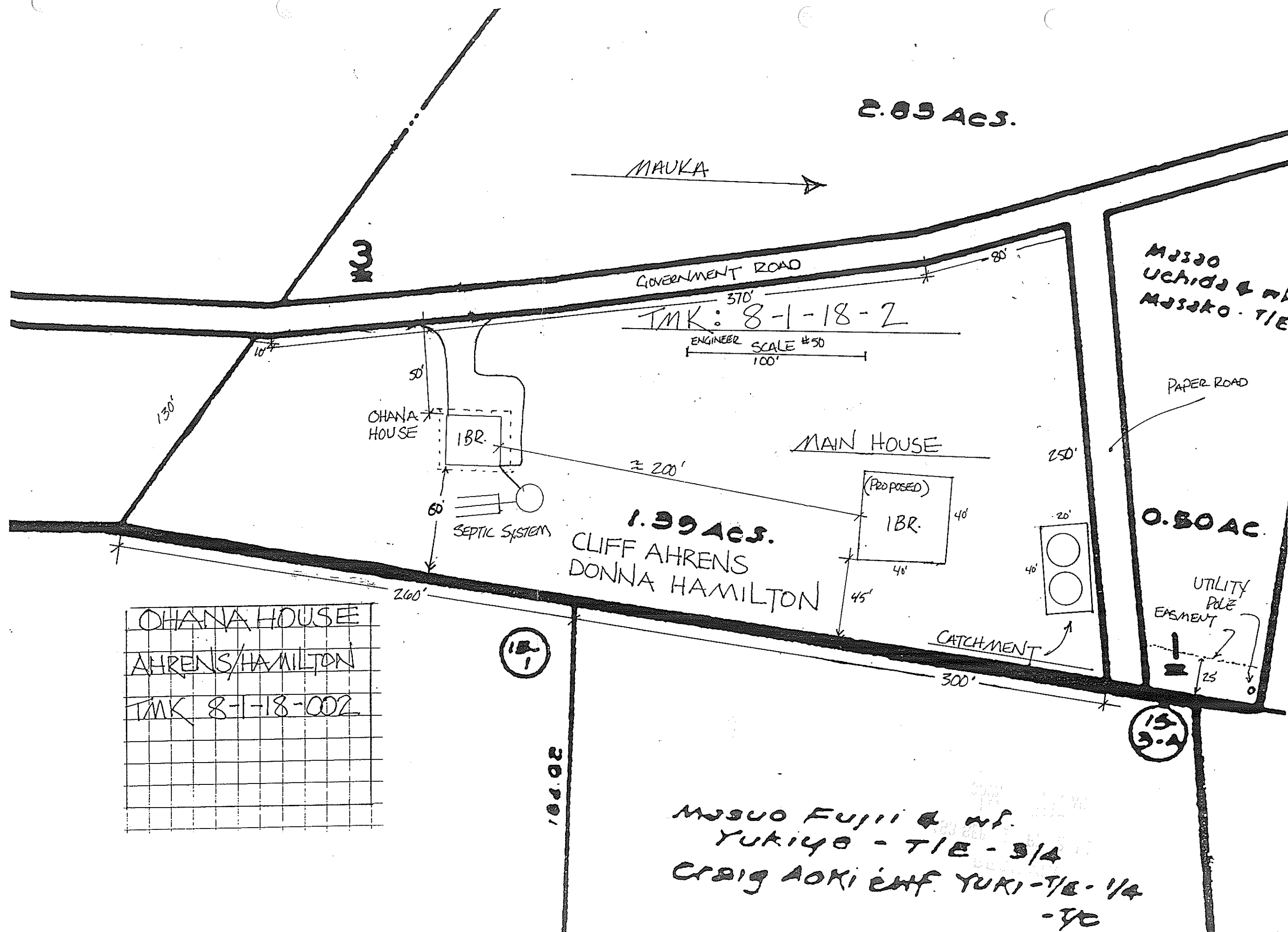

2.83 Ac.

MAUKA →

GOVERNMENT ROAD

TMK: 8-1-18-2

ENGINEER SCALE #50  
100'

123

MUSAO Uchida & Wf  
MUSAKO - TIE

PAPER ROAD

130'

OHANA HOUSE

1BR.

MAIN HOUSE

SEPTIC SYSTEM

1.39 Ac.  
CLIFF AHRENS  
DONNA HAMILTON

(PROPOSED)

1BR.

0.50 AC.

UTILITY POLE EASEMENT

CATCHMENT

OHANA HOUSE
AHRENS/HAMILTON
TMK 8-1-18-002

15/1

2000'

15/3

MUSAO FUJII & Wf.  
YUKIYO - TIE - 3/4  
CRAIG AOKI & Wf. YUKI - TIE - 1/4  
- 3/4