

February 4, 1994

James N. and Nina A. Millar
P. O. Box 1132
Honokaa, HI 96727

Dear Mr. and Mrs. Millar:

Ohana Dwelling Permit (OD 94-10)
Tax Map Key: 4-4-12:7, Lot 44-A 3410

The subject application has been reviewed by the concerned agencies and note:

1. The subject tax map key parcel is served by an acceptable street;
2. The subject application can meet with the State Department of Health wastewater treatment and disposal systems requirements;
3. The copy of document(s) received relating to subject tax map key parcel to establish title and exhibits contained therein do not include any deed restriction or covenant to prohibit construction of requested ohana dwelling; and,
4. The site plan dated January 12, 1994 denotes two off-street parking stalls on the property.

In view of the above, by this letter, you are hereby granted permission to construct the Ohana Dwelling (Additional Single Family Dwelling), subject to the following condition(s):

- (a) The building permit for the Ohana Dwelling shall be applied for and secured from the Department of Public Works, Building Division on or before February 4, 1995. It should be noted that the permit is effective for only one (1) year and should applicant fail to secure a building permit within this period, a new application must be applied for.

Please bring or attach a copy of this Permit to expedite processing the building plans and building permit application to construct the ohana dwelling.

01416

FEB 07 1994

James N. and Nina A. Millar
Page 2
February 4, 1994

- (b) Off-street parking space for two vehicles is designated on the submitted site plan to fulfill the off-street parking requirement. The off-street parking spaces may not be employed for storage or other use unless and until approved alternative on-site parking arrangements are established.
- (c) All construction drawings together with approved site plan drawn to scale submitted with the ohana dwelling building permit application shall denote location and identify required two (2) off-street parking spaces.
- (d) The applicant must comply with driveway regulations. Please contact the Department of Public Works, Engineering Division at 961-8327.
- (e) The ohana dwelling shall conform to all requirements of codes and statutes pertaining to access and building construction.
- (f) The applicant shall conform to State Department of Health standards and regulations and following comment(s) dated January 27, 1994:

"Found no environmental health concerns with regulatory implications in the submittals."
- (g) This Ohana Dwelling permit is subject to all other applicable rules, regulations and requirements, including but not limited to those of the Planning Department, Department of Public Works, and State Department of Health.

Should you have any questions regarding the above, please feel free to contact Gilbert Bailado of my staff at 961-8288.

Sincerely,

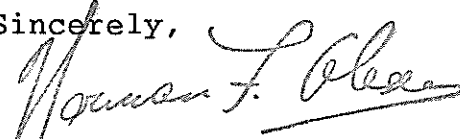
for VIRGINIA GOLDSTEIN
Planning Director

GB:mjs
2509D (2)

xc: Department of Health,
Chief Sanitarian
Department of Public Works
Real Property Tax Division - Hilo

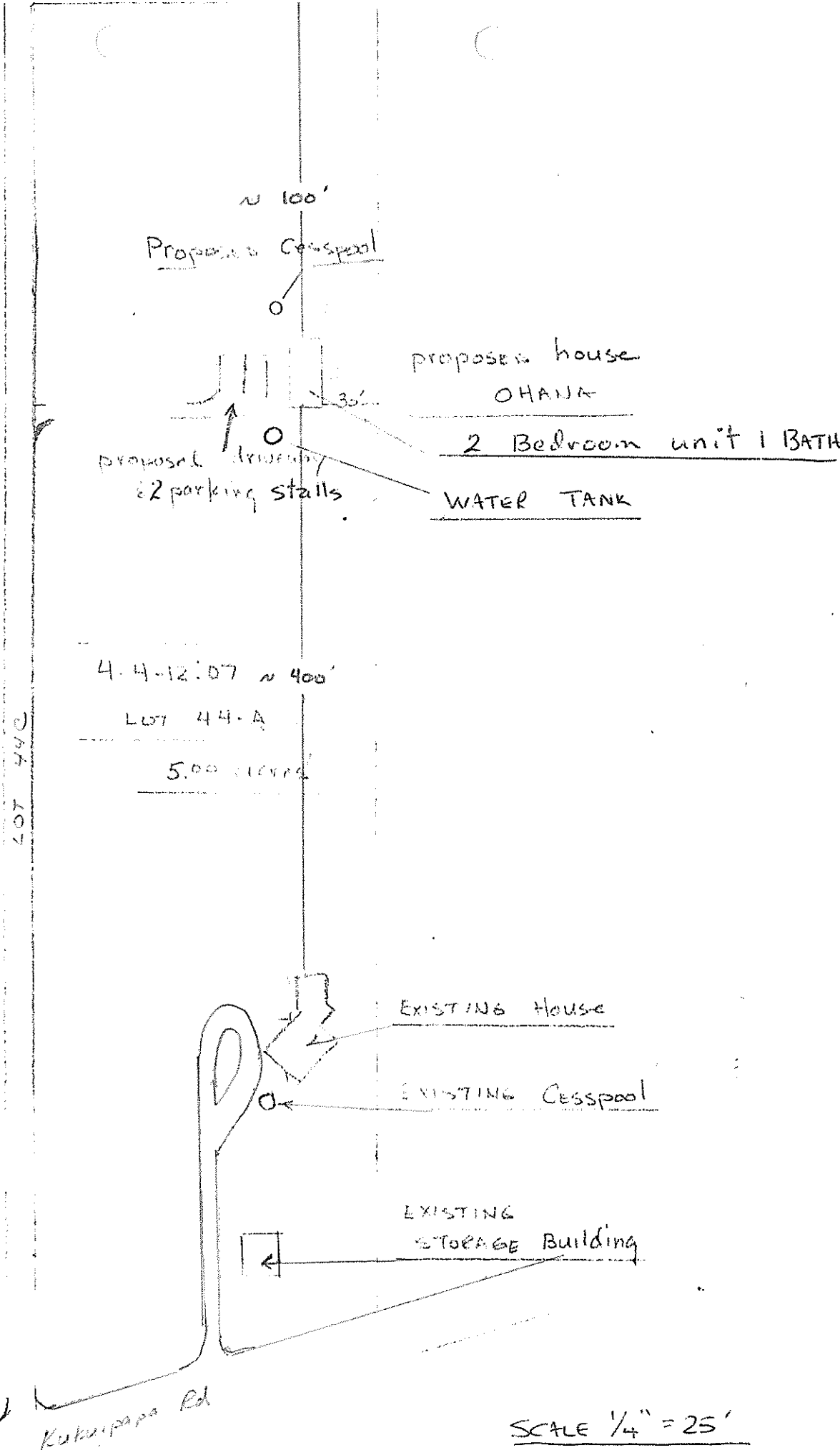

LOT 44B

4.4-12.07 ~ 400'

LOT 44-A

5.00 ACRES

LOT 44-B

Kukuiapapa Rd

SCALE 1/4" = 25'