

May 16, 1994

Peter C. Dodson
13-1284 Kahukai Street
Pahoa, HI 96778

Dear Mr. Dodson:

Ohana Dwelling Permit (OD 94-140)
Tax Map Key: 1-3-42: 52, Lot 24

3533

The subject application has been reviewed by the concerned agencies and note:

1. The subject tax map key parcel is served by an acceptable street;
2. The subject application can meet with the State Department of Health wastewater treatment and disposal systems requirements;
3. The copy of document(s) received relating to subject tax map key parcel to establish title and exhibits contained therein do not include any deed restriction or covenant to prohibit construction of requested ohana dwelling; and,
4. The site plan dated March 21, 1994 denotes two off-street parking stalls on the property.

In view of the above, by this letter, you are hereby granted permission to construct the Ohana Dwelling (Additional Single Family Dwelling), subject to the following condition(s):

- (a) The building permit for the Ohana Dwelling shall be secured on or before May 16, 1995. It should be noted that the permit is effective for only one (1) year and should applicant fail to secure a building permit within this period, a new application must be applied for.

Please bring or attach a copy of this Permit to expedite processing the building plans and building permit application to construct the ohana dwelling.

06397

MAY 18 1994

Peter C. Dodson
Page 2
May 16, 1994

- (b) Off-street parking space for two vehicles is designated on the submitted site plan to fulfill the off-street parking requirement. The off-street parking spaces may not be employed for storage or other use unless and until approved alternative on-site parking arrangements are established.
- (c) All construction drawings together with approved site plan drawn to scale submitted with the ohana dwelling building permit application shall denote location and identify required two (2) off-street parking spaces.
- (d) The ohana dwelling shall conform to all requirements of codes and statutes pertaining to access and building construction.
- (e) The applicant shall conform to State Department of Health standards and regulations and following comment(s) dated April 20, 1994:

"Found no environmental health concerns with regulatory implications in the submittals."
- (f) This Ohana Dwelling permit is subject to all other applicable rules, regulations and requirements, including but not limited to those of the Planning Department, Department of Public Works, and State Department of Health.

Should you have any questions regarding the above, please feel free to contact Gilbert Bailado of my staff at 961-8288.

Sincerely,

VIRGINIA GOLDSTEIN
Planning Director

GB:jc
3727D
xc: Department of Health,
Chief Sanitarian
Department of Public Works
Real Property Tax Division - Hilo

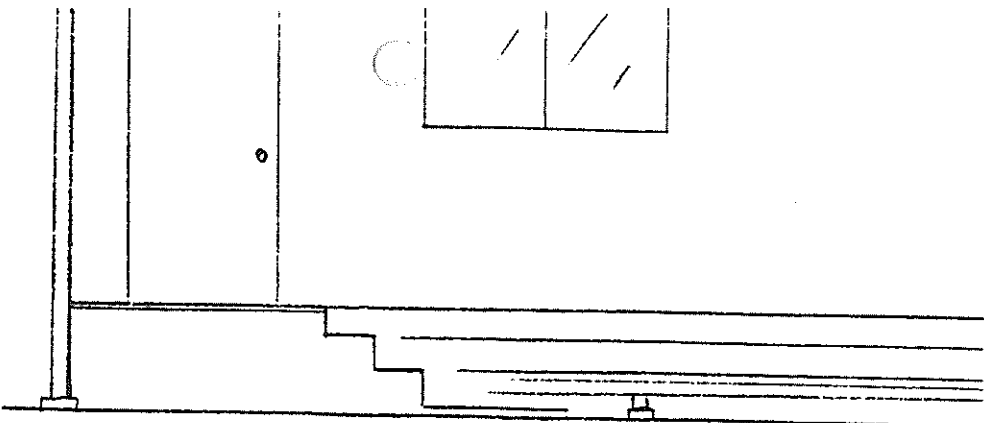

LEFT ELEVATION SC. 1/4" = 1'

PERMITS REQUIRED FROM THE
ENGINEERING DIVISION OF THE
DEPARTMENT OF PUBLIC WORKS:

- 1) GRADING PERMIT IN ACCORDANCE WITH CHAPTER 10, HAWAII COUNTY CODE, AS AMENDED. A PERMIT MAY BE REQUIRED FOR LOT GRADING (EXCAVATION AND OR FILL) WORK BEYOND THE BUILDING LINES.
 - 2) DRIVEWAY PERMIT IN ACCORDANCE WITH CHAPTER 22, HAWAII COUNTY CODE, A PERMIT SHALL BE OBTAINED FOR DRIVEWAY CONSTRUCTION WORK WITHIN THE COUNTY RIGHT-OF-WAY.
- DRAINAGE: NO BUILDING SHALL BE CONSTRUCTED WITHIN OR OVER A NATURAL OR MAN-MADE DRAINAGE COURSE.

ENGINEERING DIVISION

These plans accompanied building permit application on

Date 11/12/91 *JL*

PLOT PLAN

SC. 1/8" = 10'

BUILDER SHALL ASSURE PROPER SETBACKS OF STRUCTURES TO PROPERTY LINES

